

Delrin

Ratio
2:1
3:1
4:1

- Module 0.8 to 2.5
- Machined parts
- Pressure angle 20°
- Teeth Gleason
- Material:
Delrin plastic
- Working temp. -50° Tapped hole ØR to +80°C

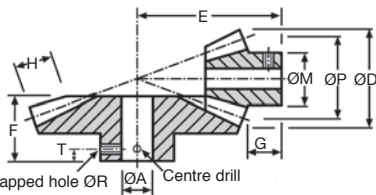

TORQUE AND POWER INDICATION	For 20 teeth at 1000 rpm					
	2.5 MOD	2.0 MOD	1.5 MOD	1.25 MOD	1.0 MOD	0.8 MOD
Torque (Nm)	0.91	0.46	0.20	0.15	0.12	0.03
Power (kW)	0.09	0.05	0.02	0.016	0.013	0.003

DISCOUNTS

Qty	1+	6+	30+
Disc.	List	-22%	On request

Part number	Teeth											Price each	
	Z	Module	ØP	E	ØD	ØA	ØM	F	G	H	ØR	T	1 to 5
ZDB0.8-15	15	0,8	12,00	20,00	13,93	6	10	11,90	7,50	4,02	M3	3,50	16,99 €
ZDB0.8-30	30		24,00	14,00	24,64	8	20	10,08	5,50	4,02	M3	3,50	20,09 €
ZDB1-15	15	1	15,00	24,00	17,42	8	14	13,87	8,76	5,03	M4	4,00	19,28 €
ZDB1-30	30		30,00	18,00	30,58	10	25	13,11	7,00	5,03	M4	4,00	23,70 €
ZDB1.5-15	15	1,5	22,50	35,00	26,12	10	21	19,84	12,13	7,55	M4	5,00	26,74 €
ZDB1.5-30	30		45,00	27,00	45,87	10	30	19,66	11,00	7,55	M4	5,00	26,90 €
ZDB2-15	15	2	30,00	45,00	34,83	12	28	24,76	14,86	10,06	M5	7,50	23,24 €
ZDB2-30	30		60,00	35,00	61,16	12	40	25,21	14,00	10,06	M5	8,00	32,33 €
ZDB2.5-15	15	2,5	37,50	54,00	43,54	15	32	29,51	16,51	13,53	M5	8,00	31,81 €
ZDB2.5-30	30		75,00	41,50	76,45	15	50	29,31	13,31	13,53	M5	7,00	40,22 €
ZTB0.8-15	15	0,8	12,00	28,00	14,14	6	10	15,63	9,67	5,69	M3	5,00	On request
ZTB0.8-45	45		36,00	20,00	36,30	8	28	16,07	8,00	5,69	M3	4,00	
ZTB1-15	15	1	15,00	32,00	17,67	8	13	16,54	9,18	7,12	M4	4,50	
ZTB1-45	45		45,00	24,00	45,37	10	40	19,09	10,00	7,12	M4	5,00	
ZTB1.5-15	15	1,5	22,50	45,00	26,51	10	18	21,80	10,51	10,67	M4	5,00	
ZTB1.5-45	45		67,50	32,00	68,06	15	50	24,63	12,00	10,67	M4	6,00	
ZFB0.8-15	15	0,8	12,00	35,00	14,23	6	10	18,07	10,58	7,10	M3	5,00	
ZFB0.8-60	60		48,00	20,00	48,22	8	30	15,98	8,00	7,10	M3	4,00	
ZFB1-15	15	1	15,00	45,00	17,79	8	13	24,22	14,73	9,28	M4	7,00	
ZFB1-60	60		60,00	30,00	60,27	10	40	25,08	12,00	9,28	M4	6,00	
ZFB1.5-15	15	1,5	22,50	60,00	26,69	10	18	28,82	12,08	13,91	M4	6,00	
ZFB1.5-60	60		60,00	35,00	90,41	15	50	27,61	12,00	13,91	M4	6,00	

Dimensions in mm

Our other products



BLHB30

Right angled gearbox, up to 4.4 Nm



TTQ

Hexagonal locking assembly, Very high torque



D19 D29

Compression spring, by the metre



NAST

Cam follower, With interior ring



ZBconique

Machined plastic bevel gear (delrin), 1:1



METEB

Self-lubricating blanks, Ferrous alloy (FP20)



DB

Bevel gear - Steel 60C40, 2:1



GB-RA-1,0



PSG08DL

Spur gear - precision range, Peek

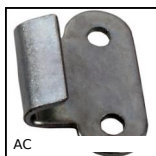

AC

Catch plate for toggle latch, 15mm



INO

Internal gear, Steel 20NCD2



BPHF

Ball transfer unit, High

Complementary products



MDB_MTB

Moulded plastic bevel gear (nylon), 2:1



SSDB

Stainless steel bevel gear, 2:1



DB_ECO

Bevel gear - Steel C43, 2:1