

Delrin

Ratio
2:1
3:1
4:1

- Module 0.8 to 2.5
- Machined parts
- Pressure angle 20°
- Teeth Gleason
- Material:
Delrin plastic
- Working temp. -50° Tapped hole ØR to +80°C

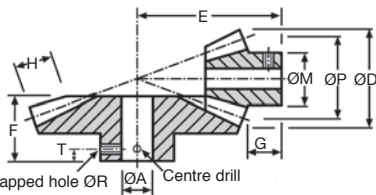

TORQUE AND POWER INDICATION	For 20 teeth at 1000 rpm					
	2.5 MOD	2.0 MOD	1.5 MOD	1.25 MOD	1.0 MOD	0.8 MOD
Torque (Nm)	0.91	0.46	0.20	0.15	0.12	0.03
Power (kW)	0.09	0.05	0.02	0.016	0.013	0.003

DISCOUNTS

Qty	1+	6+	30+
Disc.	List	-22%	On request

Part number	Teeth											Price each	
	Z	Module	ØP	E	ØD	ØA	ØM	F	G	H	ØR	T	1 to 5
ZDB0.8-15	15	0,8	12,00	20,00	13,93	6	10	11,90	7,50	4,02	M3	3,50	16,99 €
ZDB0.8-30	30		24,00	14,00	24,64	8	20	10,08	5,50	4,02	M3	3,50	20,09 €
ZDB1-15	15	1	15,00	24,00	17,42	8	14	13,87	8,76	5,03	M4	4,00	19,28 €
ZDB1-30	30		30,00	18,00	30,58	10	25	13,11	7,00	5,03	M4	4,00	23,70 €
ZDB1.5-15	15	1,5	22,50	35,00	26,12	10	21	19,84	12,13	7,55	M4	5,00	26,74 €
ZDB1.5-30	30		45,00	27,00	45,87	10	30	19,66	11,00	7,55	M4	5,00	26,90 €
ZDB2-15	15	2	30,00	45,00	34,83	12	28	24,76	14,86	10,06	M5	7,50	23,24 €
ZDB2-30	30		60,00	35,00	61,16	12	40	25,21	14,00	10,06	M5	8,00	32,33 €
ZDB2.5-15	15	2,5	37,50	54,00	43,54	15	32	29,51	16,51	13,53	M5	8,00	31,81 €
ZDB2.5-30	30		75,00	41,50	76,45	15	50	29,31	13,31	13,53	M5	7,00	40,22 €
ZTB0.8-15	15	0,8	12,00	28,00	14,14	6	10	15,63	9,67	5,69	M3	5,00	On request
ZTB0.8-45	45		36,00	20,00	36,30	8	28	16,07	8,00	5,69	M3	4,00	
ZTB1-15	15	1	15,00	32,00	17,67	8	13	16,54	9,18	7,12	M4	4,50	
ZTB1-45	45		45,00	24,00	45,37	10	40	19,09	10,00	7,12	M4	5,00	
ZTB1.5-15	15	1,5	22,50	45,00	26,51	10	18	21,80	10,51	10,67	M4	5,00	
ZTB1.5-45	45		67,50	32,00	68,06	15	50	24,63	12,00	10,67	M4	6,00	
ZFB0.8-15	15	0,8	12,00	35,00	14,23	6	10	18,07	10,58	7,10	M3	5,00	
ZFB0.8-60	60		48,00	20,00	48,22	8	30	15,98	8,00	7,10	M3	4,00	
ZFB1-15	15	1	15,00	45,00	17,79	8	13	24,22	14,73	9,28	M4	7,00	
ZFB1-60	60		60,00	30,00	60,27	10	40	25,08	12,00	9,28	M4	6,00	
ZFB1.5-15	15	1,5	22,50	60,00	26,69	10	18	28,82	12,08	13,91	M4	6,00	
ZFB1.5-60	60		60,00	35,00	90,41	15	50	27,61	12,00	13,91	M4	6,00	

Dimensions in mm

Our other products



YG2
HEAVY DUTY spur gear, Steel 35NCD6



PRES5HR
Manual workbench press, Force up to 500kg



VBFP
Small 6 lobe threaded handle - female, Duroplast - Brass



GB-RA
Brass spur gear, Brass CuZn39Pb3



VRM
Female swivelling lifting rings, Female swivelling



ZG0
Plastic spur gear, Machined plastic (delrin)



PSG2
Spur gear - precision range, Pre-hardened Steel 35NCD6



TBD
Manual leadscrew table with opposing threads, 40kg



SLB
Indexing plunger, steel class 5.8



BIM
Indexing plunger mini, miniature

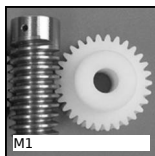

M1
Worm and wheel set, Machined plastic (delrin)



LRR22
Small dimension latch with locking system, Aluminium

Complementary products



SSDB
Stainless steel bevel gear, 2:1



DB
Steel bevel gear, 2:1