

Ratio 1:1

Nylon MC901

- Module 1 to 2.5
- Pressure angle 20°
- Teeth: Gleason
- Material :
Nylon MC901
- Two gears required to make a pair

Info.

- Plastic gears are susceptible to the effects of temperature and moisture. Dimensional changes may occur while performing secondary operations and during post-machining operations.

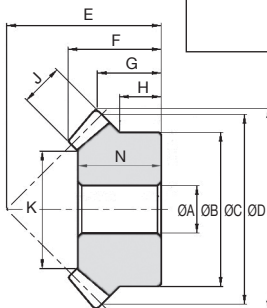

DISCOUNTS

Qty	1+	6+	10+
Disc.	List	-12%	On request

Part number	Module	Teeth											Weight (g)	Price each 1 à 5	
		Z	ØA	ØB	ØC	ØD	E	F	G	H	N	J			K
ZB1-20-RA	1	20	6	16	20	21,41	20	13,95	10,71	8	12	5	9,86	2,77	23,67 €
ZB1-25-RA		25	6	20	25	26,41	23	15,16	11,21	8	14	6	15,03	5,13	27,82 €
ZB1-30-RA		30	8	24	30	31,41	28	17,71	13,71	10	16	6	19,03	8,44	35,72 €
ZB1.25-20-RA	1,25	20	8	22	25	26,77	23	15,27	11,38	9	13	6	13,03	5,31	26,77 €
ZB1.25-25-RA		25	8	25	31,25	33,02	28	17,88	13,26	9,25	16	7	18,70	9,27	31,36 €
ZB1.5-20-RA	1,5	20	8	26	30	32,12	30	21,24	16,06	13	19	8	15,37	11,0	29,90 €
ZB1.5-25-RA		25	8	30	37,5	39,62	34	22,25	16,31	11,5	19	9	19,54	17,0	37,15 €
ZB1.5-30-RA		30	10	36	45	47,12	43	28,24	21,56	16	25	10	25,72	30,9	52,96 €
ZB2-20-RA	2	20	10	34	40	42,83	37	24,89	18,41	14	22	10	21,72	22,5	40,70 €
ZB2-25-RA		25	10	40	50	52,83	40	24,33	16,41	10	20	12	26,06	32,7	51,49 €
ZB2-30-RA		30	12	45	60	62,83	50	29,43	21,41	12,5	25	12	36,06	54,5	68,96 €
ZB2.5-20-RA		20	12	42	50	53,54	48	32,54	24,77	19	29	12	28,06	45,9	54,83 €
ZB2.5-25-RA		25	14	50	62,5	66,04	50	30,41	20,52	12,5	26	15	34,57	63,9	70,39 €
ZB2.5-30-RA	30	16	60	75	78,54	62	36,28	26,27	17	32	15	47,57	113	97,19 €	

Dimensions in mm

Nylon MC901

Ratio

1,5:1 2:1 3:1

- Module 1 to 2.5
- Pressure angle 20°
- Teeth: Gleason
- Material :
Nylon MC901
- Two gears required to make a pair



Info.

- Plastic gears are susceptible to the effects of temperature and moisture. Dimensional changes may occur while performing secondary operations and during post-machining operations.

DISCOUNTS

Qty	1+	6+	10+
Disc.	List	-12%	On request

Part number	Teeth Module	Z	ØA	ØB	ØC	ØD	E	F	G	H	N	J	K	Weight (g)	Price each 1 à 5
Ratio 1,5:1															
ZHB1.5-20-RA	1,5	20	8	25	30	33,13	33	18,63	11,54	8,83	17	9	17,05	0,009	30,51 €
ZHB1.5-30-RA		30	10	30	45	46,24	28	18,53	13,93	8,00	16	9	27,37	0,018	44,44 €
ZHB2-20-RA	2	20	10	35	40	44,18	45	25,06	16,39	13,33	22	11	21,34	0,024	42,36 €
ZHB2-30-RA		30	10	35	60	61,65	40	26,87	21,24	15,00	23	11	37,56	0,039	65,21 €
ZHB2.5-20-RA	2,5	20	12	40	50	55,22	55	31,06	19,24	14,16	28	15	27,42	0,042	57,72 €
ZHB2.5-30-RA		30	15	45	75	77,07	50	34,22	26,55	18,00	30	15	45,61	0,081	89,73 €
Ratio 2:1															
ZDB1-20-RA	1	20	6	16	20	22,41	28	13,78	8,60	7,00	12	6	9,17	0,003	25,75 €
ZDB1-40-RA		40	8	25	40	40,59	22	15,07	12,59	8,00	12	6	26,58	0,010	45,91 €
ZDB1.25-20-RA	1,25	20	8	22	25	28,01	36	18,66	11,75	10,25	17	8	13,22	0,007	29,70 €
ZDB1.25-40-RA		40	10	32	50	50,73	27	18,54	15,23	10,00	16	8	33,61	0,021	55,85 €
ZDB1.5-20-RA	1,5	20	8	25	30	33,61	46	25,54	16,90	14,75	24	10	17,28	0,013	34,26 €
ZDB1.5-40-RA		40	10	38	60	60,88	35	25,01	20,88	15,00	22	10	39,64	0,039	66,68 €
ZDB2-20-RA	2	20	12	32	40	44,81	60	34,16	21,20	18,00	32	15	20,92	0,028	46,31 €
ZDB2-40-RA		40	12	40	80	81,17	45	32,37	26,17	18,00	27	15	48,46	0,076	98,66 €
ZDB2.5-20-RA	2,5	20	12	40	50	56,01	75	43,78	26,50	22,50	41	20	24,56	0,060	65,42 €
ZDB2.5-40-RA		40	15	50	100	101,47	55	39,73	31,47	20,00	35	20	60,28	0,160	152,26 €

Dimensions in mm

Ratio
1,5:1
2:1
3:1

Nylon MC901

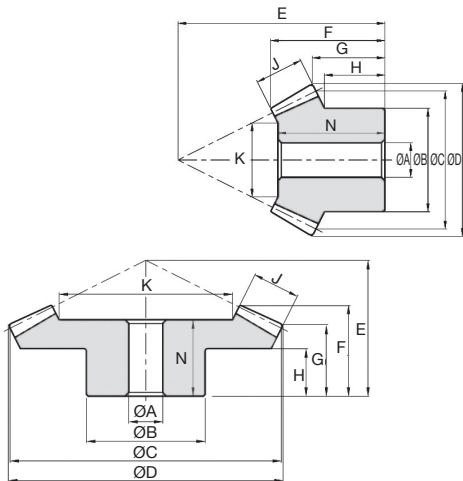

DISCOUNTS

Qty	1+	6+	10+
Disc.	List	-12%	On request

Part number	Teeth											Weight (g)	Price each 1 à 5		
	Module Z	ØA	ØB	ØC	ØD	E	F	G	H	N	J			K	
Ratio 3:1															
ZTB1.5-15-RA	1,5	15	8	18	22,5	26,54	47	23,19	13,92	12,50	22,5	10	14,75	0,006	30,51 €
ZTB1.5-45-RA		45	10	40	67,5	68,06	28	20,44	17,59	11,00	17	10	46,58	0,040	68,31 €
ZTB2-15-RA	2	15	10	24	30	35,35	60	29,80	15,89	14,00	29	15	19,13	0,014	37,80 €
ZTB2-45-RA		45	12	60	90	90,75	40	30,40	26,12	17,00	26	15	59,04	0,120	112,38 €
ZTB2.5-15-RA	2,5	15	12	30	37,5	44,18	75	38,41	19,86	17,50	37	20	20,51	0,028	48,19 €
ZTB2.5-45-RA		45	15	60	112,5	113,43	50	38,35	32,65	22,00	35	20	72,84	0,200	174,05 €

Dimensions in mm

Our other products



INS150

Self tapping insert with collar-coarse thread, With collar-coarse t...



RHTplss

High Temperature Castor, up to 200kg



SSDB

Stainless steel bevel gear, 2:1



CHMR75

Worm and wheel gear reducer, up to 298 Nm



AT10courroie

AT type timing belt, AT10 Steel cored polyurethane



TMR

Rigid manual tensioner, Adjustable



BOXsap

Boxed set of spring pins ISO8752, Boxed set - Split ISO 8752



LRR22

Small dimension latch with locking system, Aluminium



GPBSS

Threaded spherical knob, Stainless steel 304

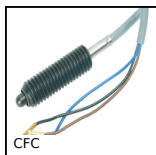

CFC

Spring loaded position switch, Electric contact



SC2

2 part rigid shaft clamp, Clamping jaw



CLSCLP_SS

Clevis components, short version, Stainless steel - short range

Complementary products



SSBRA

Stainless steel bevel gear, 1:1



SSHBRA

Stainless steel bevel gear, 1,5:1 2:1 3:1