

- **Hardened steel shaft for linear guiding**
- Material: Stainless steel X90 CrMoV18 hardened by high frequency (55 ± 3 HRC)
- Hardened depth: 0.8 to 2.6mm, conforms to DIN 6773
- Standard length 1000mm
- External diameter tolerance h6
- Straightness $t_3/1000$ mm
- Surface roughness $R_a = 0,25 \mu\text{m}$
- Ends machined + deburred but not chamfered



Options

- Please contact us for details of machining options

Advantages

- High resistance to corrosion and acids

For lengths greater than 1000mm please contact us

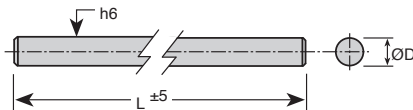

DISCOUNTS

Qty	1+	2+	4+
Disc.	List	-20%	On request

Part number	Nominal ØD (h6)	Treating depth (mm)	Circularity t1 (µm)	Cylindricity t2 (µm)	Straightness t3 (mm/m)	Standard length L (mm)	Max. length L (mm)	Weight (kg/m)	Price each (for 1m)	
									Stock*	
Z-6-1000B	6	0,5-0,8	4	6	0,16	1000	3000	0,22	✓	58,21 €
Z-8-1000B	8	0,6-0,9	4	6	0,16	1000	3000	0,39	✓	46,54 €
Z-10-1000B	10	0,7-1,0	4	6	0,16	1000	4500	0,61	✓	54,33 €
Z-12-1000B	12	0,8-1,2	5	8	0,12	1000	6000	0,89	✓	54,33 €
Z-16-1000B	16	1,1-1,5	5	8	0,12	1000	6000	1,57	✓	82,81 €
Z-20-1000B	20	1,2-1,6	6	9	0,10	1000	6000	2,45	✓	122,96 €
Z-25-1000B	25	1,5-1,7	6	9	0,10	1000	6000	3,83	✓	194,14 €
Z-30-1000B	30	1,5-1,9	6	9	0,10	1000	6000	5,51	✓	284,75 €
Z-40-1000B	40	2,5-3,0	7	11	0,10	1000	3000	9,80	✓	440,12 €
Z-50-1000B	50	2,7-3,2	7	11	0,10	1000	3000	15,30	-	647,28 €

*Depending on availability - Dimensions in mm

Our other products



NAST
Cam follower without axial guide, With interior ring



CHAC4040NP
Square hinge with riveted pin, not drilled, Square with riveted pin,...

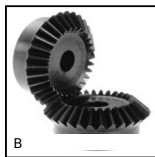

B
Steel bevel gear, 1:1

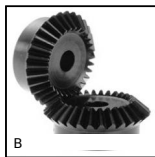

B
Steel bevel gear, 1:1



TS01_TW01
Drylin® T linear slide, up to 7000 N



PCH
Knob for gripping, Mushroom



PSG125
Spur gear - precision range, Pre-hardened Steel 35NCD6



BPPL
Assembly tool for carrier ball, Mounting tool



DB_ECO
Eco. range steel bevel gear, 2:1



RT25
Self-centering flanged locking assembly, Medium/high torque



H2
Crossed helical gear crossed axis at 90°, Steel 20NCD2



ACLEPP
Right angled bracket for aluminium profile, 2 holes

Complementary products



UGCG
Actuator guide kit, Long housing



ZAmM
Shaft for linear guides, Hardened ground steel



FGWA
End support, With base



KKB-AR
Linear bearing with inclined ball tracks, Standard loads / -20° +20...