

- **Hardened steel shaft for linear guiding**
- Material: Stainless steel X90 CrMoV18 hardened by high frequency ( $55 \pm 3$  HRC)
- Hardened depth: 0.8 to 2.6mm, conforms to DIN 6773
- Standard length 1000mm
- External diameter tolerance h6
- Straightness  $t_3/1000$ mm
- Surface roughness  $R_a = 0,25 \mu\text{m}$
- Ends machined + deburred but not chamfered



### Options

- Please contact us for details of machining options

### Advantages

- High resistance to corrosion and acids

For lengths greater than 1000mm please contact us

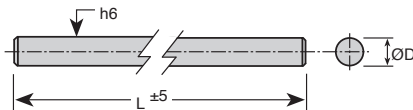

### DISCOUNTS

Qty	1+	2+	4+
Disc.	List	-20%	On request

Part number	Nominal ØD (h6)	Treating depth (mm)	Circularity t1 (µm)	Cylindricity t2 (µm)	Straightness t3 (mm/m)	Standard length L (mm)	Max. length L (mm)	Weight (kg/m)	Price each (for 1m)	
									Stock*	
Z-6-1000B	6	0,5-0,8	4	6	0,16	1000	3000	0,22	✓	58,21 €
Z-8-1000B	8	0,6-0,9	4	6	0,16	1000	3000	0,39	✓	46,54 €
Z-10-1000B	10	0,7-1,0	4	6	0,16	1000	4500	0,61	✓	54,33 €
Z-12-1000B	12	0,8-1,2	5	8	0,12	1000	6000	0,89	✓	54,33 €
Z-16-1000B	16	1,1-1,5	5	8	0,12	1000	6000	1,57	✓	82,81 €
Z-20-1000B	20	1,2,-1,6	6	9	0,10	1000	6000	2,45	✓	122,96 €
Z-25-1000B	25	1,5-1,7	6	9	0,10	1000	6000	3,83	✓	194,14 €
Z-30-1000B	30	1,5-1,9	6	9	0,10	1000	6000	5,51	✓	284,75 €
Z-40-1000B	40	2,5-3,0	7	11	0,10	1000	3000	9,80	✓	440,12 €
Z-50-1000B	50	2,7-3,2	7	11	0,10	1000	3000	15,30	-	647,28 €

\*Depending on availability - Dimensions in mm

## Our other products



ZDB  
Machined plastic  
bevel gear , 2:1

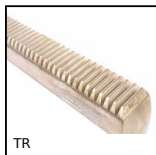

TR  
Spur round rack,  
Stainless steel -  
module 0,25-1,5

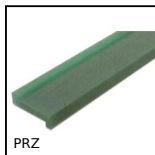

PRZ  
Wear strip for slat top  
chain, Z profile to be  
clipped



HLC24  
Right angle spiro  
bevel gearbox, Up to  
78Nm



ZHG5  
Plastic spur gear,  
Machined plastic  
(delrin)



BSM\_LOK  
Long-Lok spring  
plunger with internal  
hexagonal socket,  
LONG-LOK - s...



JCDss  
Double universal joint  
- Stainless steel, Low  
duty



TBL  
Mini leadscrew table  
with metric thread,  
1kg



BCM\_T  
Driving collar, Driving  
collar



T10courroie  
T type timing belt,  
T10 Steel cored



RJA10\_03  
Sealing strip, Clipping



DOMI50  
Accessories, Turntable

## Complementary products



UGCG  
Actuator guide kit,  
Long housing



ZAmm  
Shaft for linear  
guides, Hardened  
ground steel



FGWA  
End support, With  
base



KKB-AR  
Linear bearing with  
inclined ball tracks,  
Standard loads / -20°  
+20...