

- Hardened and ground shaft for linear guidance with threaded holes

- Material:

Hardened ground steel Ck55

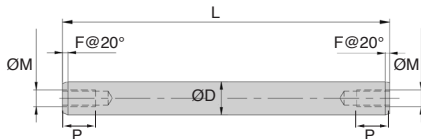

Tapped holes

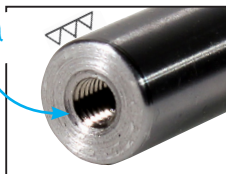

DISCOUNTS

Qty	1+	2+	4+	8+
Disc.	List	-15%	-20%	On request

Part number	ØD (h6)	Length L (mm)	F	ØM	P	Weight (kg)	Stock*	Price each
Z12-100A-M5/M5	12	100	1,8	M5	10	0,089	-	33,09 €
Z12-200A-M5/M5	12	200	1,8	M5	10	0,178	-	38,28 €
Z12-300A-M5/M5	12	300	1,8	M5	10	0,267	-	43,47 €
Z12-400A-M5/M5	12	400	1,8	M5	10	0,356	-	48,63 €
Z12-500A-M5/M5	12	500	1,8	M5	10	0,445	-	53,82 €
Z12-600A-M5/M5	12	600	1,8	M5	10	0,534	-	58,98 €
Z16-100A-M6/M6	16	100	2,0	M6	12	0,157	-	39,48 €
Z16-200A-M6/M6	16	200	2,0	M6	12	0,314	-	45,96 €
Z16-300A-M6/M6	16	300	2,0	M6	12	0,471	-	52,44 €
Z16-400A-M6/M6	16	400	2,0	M6	12	0,628	-	58,92 €
Z16-500A-M6/M6	16	500	2,0	M6	12	0,785	-	65,43 €
Z16-600A-M6/M6	16	600	2,0	M6	12	0,942	-	71,91 €
Z16-700A-M6/M6	16	700	2,0	M6	12	1,099	-	78,39 €
Z16-800A-M6/M6	16	800	2,0	M6	12	1,256	-	84,87 €
Z20-100A-M8/M8	20	100	2,2	M8	16	0,245	-	41,64 €
Z20-200A-M8/M8	20	200	2,2	M8	16	0,490	-	49,08 €
Z20-300A-M8/M8	20	300	2,2	M8	16	0,735	-	56,49 €
Z20-400A-M8/M8	20	400	2,2	M8	16	0,980	-	63,93 €
Z20-500A-M8/M8	20	500	2,2	M8	16	1,225	-	71,34 €
Z20-600A-M8/M8	20	600	2,2	M8	16	1,470	-	78,75 €
Z20-700A-M8/M8	20	700	2,2	M8	16	1,715	-	86,19 €
Z20-800A-M8/M8	20	800	2,2	M8	16	1,960	-	93,60 €
Z20-900A-M8/M8	20	900	2,2	M8	16	2,205	-	101,04 €
Z20-1000A-M8/M8	20	1000	2,2	M8	16	2,450	-	108,48 €
Z25-100A-M10/M10	25	100	2,5	M10	20	0,383	-	51,42 €
Z25-200A-M10/M10	25	200	2,5	M10	20	0,766	-	60,27 €
Z25-300A-M10/M10	25	300	2,5	M10	20	1,149	-	69,15 €
Z25-400A-M10/M10	25	400	2,5	M10	20	1,532	-	78,03 €
Z25-500A-M10/M10	25	500	2,5	M10	20	1,915	-	86,91 €
Z25-600A-M10/M10	25	600	2,5	M10	20	2,298	-	95,76 €
Z25-700A-M10/M10	25	700	2,5	M10	20	2,681	-	104,64 €
Z25-800A-M10/M10	25	800	2,5	M10	20	3,064	-	113,49 €
Z25-900A-M10/M10	25	900	2,5	M10	20	3,447	-	122,37 €
Z25-1000A-M10/M10	25	1000	2,5	M10	20	3,830	-	131,25 €

*Dans la limite du disponible - Dimensions en mm

Our other products



T5P_T10P

Connecting plate for T type timing belts, T5



PRF19_E

Bracket for aluminium profile, PRF19 to PRF45



BLHB60

Right angled gearbox, bored shafts, up to 70 Nm



BLHM70

Right angled gearbox, up to 128 Nm



BCTH

Mushroom headed button Hygienic Usit®, With female thread and high ...



PSPD18

Flexible tube handle, Black PVC



PSG155

Spur gear - precision range, Stainless steel 303



WS20

Drynin® W rail, Rail



CHB

Worm and wheel gear reducer, up to 73 Nm



HG8-ECO

Eco range Spur gear, Steel C45



MSP19

Masterplate® glueable insert Ø19, Cylindrical with



PTA80

Articulated levelling foot, pressed base Ø80, Ø 80

Complementary products



ZA

Shaft for linear guides, Hardened ground steel



BPQ

Quadro linear ball bearing unit, Included 4 linear ball bearings



ZB

Shaft for linear guides, Hardened ground stainless steel



FTSN

Supported shaft for linear guide, Steel shaft / Aluminium support