

## ZA Hardened ground steel

### - Hardened steel shaft for linear guiding

#### - Material:

CK55 hardened by high frequency  
( $60 \pm 3$  HRC)

- Hardened depth: 0.8 to 2.6mm, conforms to DIN 6773

- Standard length 1000mm

- External diameter tolerance. h6

- Straightness  $t_3/1000$ mm

- Surface roughness  $R_a = 0.25\mu\text{m}$

- Ends machined + deburred but not chamfered

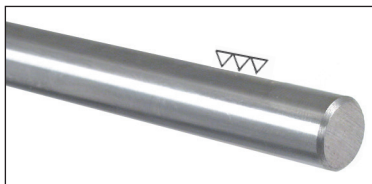

### Options

- Available in 3mm and 4mm diameters, please contact us for details.

Please see following pages for details of machining options

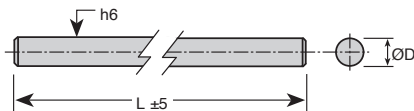

For lengths greater than 1000mm, please contact us

### DISCOUNTS

Qty	1+	2+	4+	8+
Disc.	List	-15%	-20%	On request

Part number	Nominal ØD (h6)	Hardened depth (mm)	Circularity t1 (µm)	Cylindricity t2 (µm)	Straightness t3 (mm/m)	Standard length L (mm)	Max. length L (mm)	Weight (kg/m)	Stock*	Price each (for 1m)
Z5-1000A	5	0,5-0,8	4	6	0,16	1000	3200	0,15	✓	36,85 €
Z6-1000A	6	0,5-0,8	4	6	0,16	1000	3000	0,22	✓	31,01 €
Z8-1000A	8	0,6-0,9	4	6	0,16	1000	3000	0,39	✓	13,91 €
Z10-1000A	10	0,7-1,0	4	6	0,12	1000	4500	0,61	✓	18,56 €
Z12-1000A	12	0,8-1,2	5	8	0,12	1000	6000	0,89	✓	21,67 €
Z14-1000A	14	0,9-1,3	5	8	0,12	1000	6000	1,21	✓	31,01 €
Z15-1000A	15	1,0-1,4	5	8	0,12	1000	6000	1,37	✓	31,01 €
Z16-1000A	16	1,1-1,5	5	8	0,10	1000	6000	1,57	✓	26,66 €
Z18-1000A	18	1,1-1,5	5	8	0,10	1000	6000	1,98	✓	40,34 €
Z20-1000A	20	1,2-1,5	6	9	0,10	1000	6000	2,45	-	54,70 €
Z25-1000A	25	1,5-1,7	6	9	0,10	1000	6000	3,83	✓	50,65 €
Z30-1000A	30	1,5-1,9	6	9	0,10	1000	6000	5,51	✓	72,54 €
Z40-1000A	40	1,6-2,0	7	11	0,10	1000	6000	9,80	✓	160,51 €
Z50-1000A	50	2,2-2,6	7	11	0,10	1000	6000	15,30	-	202,12 €
Z60-1000A	60	2,2-2,6	8	13	0,10	1000	6000	22,10	-	248,51 €
Z80-1000A	80	2,2-2,6	8	13	0,10	1000	6000	39,20	-	472,24 €

\*Depending on availability - Dimensions in mm

## Our other products



UCFL\_PBT  
Stainless steel/Polymer flanged bearing, Polymer and stainless steel



MPE  
Hexagonal spacer, Steel



MEB  
Moulded plastic bevel gear (nylon), 1:1



UCFL  
Cast iron flanged bearing, Cast iron



PCS75K  
Chain sprocket with hardened teeth, 19.05mm (DIN12B-1)



PTR  
Idler chain sprocket, For standard applications



DIV\_SS  
Stainless steel locking bolt, With grip - Stainless steel



PCATherm  
Pull handle, Thermoplastic



BPQ  
Quadro linear ball bearing unit, Included 4 linear ball bearings



VTLM  
3 lobed handle, Polyamide - Steel



TS01\_TW01  
Drylin® T linear slide, up to 7000 N



VTAP  
Magnetic head screw, With rubber coating  
With rubber coating

## Complementary products



UGCG  
Actuator guide kit, Long housing



ZAmM  
Shaft for linear guides, Hardened ground steel



BPQ  
Quadro linear ball bearing unit, Included 4 linear ball bearings



FGWA  
End support, With base