

Tightening washer

WTM

Hardened steel

- **Heavy duty clamping washer**
- Conforms to DIN 6340
- Materials :
Steel AlZnMgCu0.5F47
resistance hardened 1200-1400/mm²

Info.

- **Not sold individually, please contact us for details**



Tight
locking

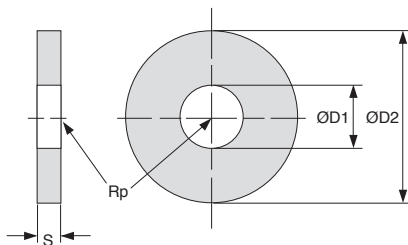
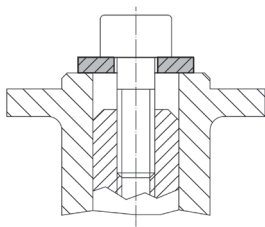

DISCOUNTS

Qty	1+	20+	50+
Disc.	List	-10%	On request

Part number	ØD1	ØD2	S	For screw	Weight (g)	Stock*	Price each 1 to 19
WTM-6	6,4	17	3	M6	3,8	✓	0,79 €
WTM-8	8,4	23	4	M8	9,8	✓	0,79 €
WTM-10	10,5	28	4	M10	14	✓	0,98 €
WTM-12	13,0	35	5	M12	28	✓	1,29 €
WTM-16	17,0	45	6	M16	55	✓	1,84 €
WTM-20	21,0	50	6	M20	71	✓	2,91 €
WTM-24	25,0	60	6	M24	122	-	4,55 €

*Subject to availability - Dimensions in mm

HPC

WEB
04/2020

www.hpceurope.com

Tél: 0 825 88 5000 Service 0,15 €/min + prix appel

Our other products



MDPOT

Potentiometer,



LVT

Miniature motorised
actuator 2A, 2 amperers



MEB

Moulded plastic bevel
gear (nylon), 1:1



T5M T10M

T type timing belt per
metre, T10 Steel
cored polyurethane



NT63

Spur gear coaxial
gearbox, from 8 to 20
Nm - In-line



ACL-PLAngle

Joining plate for
aluminium profile,
Angle connection



MHWC

Double-disc flexible
coupling, Double disk

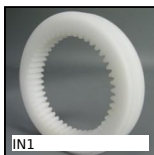

IN1

Internal gear,
Machined plastic
(delrin)



INS_BR

Self tapping brass
insert, Brass



ERC

Quick fitting cable
terminal, Eye version



FR

Steel thread inserts,
Steel



T39_T49

Extension spring in
metre length steel, by
the metre

Complementary products



RCC_RCX

Spherical tilt washer -
DIN6319, convex



RCC_RCX

Spherical tilt washer -
DIN6319, concave