

Torque up to 1.32Nm

VTA2
VTA6

- Adjustable clutch coupling
- Max. backlash 2°
- Max. sliding velocity: 1000 rpm
- The housing t° should be maintained below 80°C
- Equipped with an Oldham coupling
- Materials:
 - Hub: Aluminium 6082
 - Disc: Black acetal

Equipped with coupling



Uses

- 2 waved washers are fitted to these clutches
- These clutches are fitted with two washers. In some applications better torque control can be achieved by removing one of them.

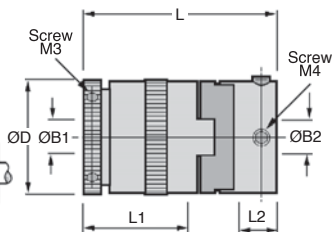
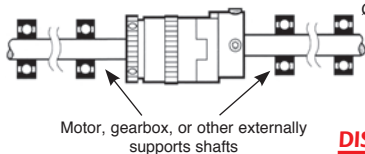

DISCOUNTS

Qty	1+	5+	10+	15+	20+	25+
Disc.	List	-15%	-20%	-25%	-30%	On request

Part number	$\begin{matrix} +0.03 \\ -0.00 \end{matrix}$ ØB1	$\begin{matrix} +0.03 \\ -0.00 \end{matrix}$ ØB2	L	ØD	Max. shaft length L1	Max. shaft length L2	Heat dissipation at 20°C (Watts)	Max. frictional torque (Nm)	Stock*	Price each 1 to 4
2 discs										
VTA2-0606	6	6	46,50	25,8	25	8,60	7,0	0,53	✓	98,92 €
VTA2-0608	6	8	46,50	25,8	25	8,60	7,0	0,53	✓	98,92 €
VTA2-0610	6	10	46,50	25,8	25	8,60	7,0	0,53	-	98,92 €
VTA2-0806	8	6	46,50	25,8	25	8,60	7,0	0,53	-	98,92 €
VTA2-0808	8	8	46,50	25,8	25	8,60	7,0	0,53	✓	98,92 €
VTA2-0810	8	10	46,50	25,8	25	8,60	7,0	0,53	✓	98,92 €
6 discs										
VTA6-0606	6	6	53,40	25,8	31	8,60	8,6	1,32	-	112,09 €
VTA6-0608	6	8	53,40	25,8	31	8,60	8,6	1,32	-	112,09 €
VTA6-0610	6	10	53,40	25,8	31	8,60	8,6	1,32	-	112,09 €
VTA6-0806	8	6	53,40	25,8	31	8,60	8,6	1,32	-	112,09 €
VTA6-0808	8	8	53,40	25,8	31	8,60	8,6	1,32	✓	112,09 €
VTA6-0810	8	10	53,40	25,8	31	8,60	8,6	1,32	✓	112,09 €

*Depending on availability - Dimensions in mm

Our other products



CHML50

Worm and wheel gear reducer, up to 107 Nm - Integrated torque limiter



PTA40

Articulated foot with solid base foot \varnothing 40, 30000N



CHAR7530

Spring hinge, welded



DB

Steel bevel gear, 2:1



ZG1

Plastic spur gear, Machined plastic (delrin)



UFX

Spare tyre UNEFLEX® coupling, range



ACM_TRI

Manual bonnet fastener, Black rubber fastener



SDG

Adjustable guide support bracket, Plastic



SCE_SS

Stainless steel U-shaped clamp,



YG1

HEAVY DUTY spur gear, Steel 35NCD6



RJA00_28

Sealing strip, Clipping



PW_PWG05

Wheel - precision range, Bronze

Complementary products



VT

Vari-Tork® slip friction clutch, 0.53 to 1.32 Nm



DSF

Slip friction clutch, 4 to 2600 Nm



LC

Friction clutch, 30 to 240 Nm



LC

Friction clutch, 190 to 1800 Nm