

Small 6 lobe threaded handle



VP

Black Duroplast, steel thread

- **Operating element**

- **Materials:**

Black phenolic Duraplast

Threaded stud: chromed steel

Good resistance



Advantages

- Easy grip
- Temperature resistant
- Good chemical resistance
- Easier to clean that technopolymer
- In machining applications, less likely to retain swarf

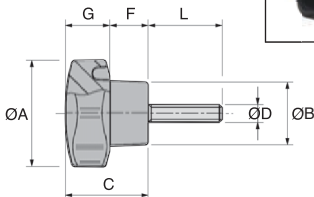

DISCOUNTS

Qty	1+	10+	20+	50+	100+	200+
Disc. List	-5%	-10%	-15%	-20%	On request	

Part number	ØA	ØB	C	ØD	F	G	L	Weight (g)	Price each 1 to 9
VP20-M4-15	20	13	15	M4	7	8	15	5	2,73 €
VP20-M4-25	20	13	15	M4	7	8	25	6	2,73 €
VP20-M5-15	20	13	15	M5	7	8	15	7	2,95 €
VP20-M5-25	20	13	15	M5	7	8	25	8	3,02 €
VP20-M6-15	20	13	15	M6	7	8	15	8	2,95 €
VP20-M6-25	20	13	15	M6	7	8	25	11	3,02 €
VP30-M6-15	30	17	24	M6	11	13	15	18	3,46 €
VP30-M6-25	30	17	24	M6	11	13	25	21	3,54 €
VP30-M6-35	30	17	24	M6	11	13	35	23	3,61 €
VP30-M8-20	30	17	24	M8	11	13	20	25	3,73 €
VP30-M8-30	30	17	24	M8	11	13	30	27	3,73 €
VP40-M8-20	40	21	28	M8	13	15	20	38	4,61 €
VP40-M8-30	40	21	28	M8	13	15	30	40	4,68 €
VP40-M8-40	40	21	28	M8	13	15	40	44	4,75 €
VP50-M8-20	50	25	33	M8	15	18	20	52	5,37 €
VP50-M8-30	50	25	33	M8	15	18	30	56	5,41 €
VP50-M8-40	50	25	33	M8	15	18	40	60	5,41 €
VP50-M10-20	50	25	33	M10	15	18	20	61	5,48 €
VP50-M10-30	50	25	33	M10	15	18	30	65	5,63 €
VP50-M10-40	50	25	33	M10	15	18	40	70	6,00 €
VP60-M12-20	60	28	35	M12	15	20	20	101	7,56 €
VP60-M12-30	60	28	35	M12	15	20	30	107	7,71 €
VP60-M12-40	60	28	35	M12	15	20	40	115	7,75 €
VP70-M12-30	70	32	42	M12	21	21	30	133	9,29 €
VP70-M12-40	70	32	42	M12	21	21	40	138	9,44 €
VP70-M12-50	70	32	42	M12	21	21	50	145	9,58 €
VP70-M14-50	70	32	42	M14	21	21	50	181	13,20 €

Dimensions in mm

Our other products



NPCR

Adjustable cell support, Adjustable



MSP3815

Masterplate® glueable insert rectangular, rectangular with



GAL 42

Guide roller for plate chain return, Without ball bearing

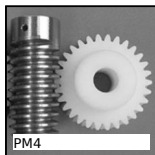

PM4

Worm and wheel set, Machined plastic (delrin)



LVT

Miniature motorised actuator 2A, 2 ampers



G1

Steel spur gear, Steel 20NCD2

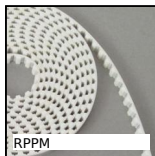

RPPM

RPP type belt per metre, RPP8 Steel cored polyurethane



BSM

Spring plunger with internal hexagonal socket, steel body, plastic pin



PSG3

Spur gear - precision range, Case hardened



PSG15

Spur gear - precision range, Stainless steel



CFE

Female rod ends DIN ISO12240-4, Steel /



SH1

Parallel axis helical gear, Steel 20NCD2

Complementary products



GLP

Small 6 lobe threaded handle - male, Technopolymer - Steel



VPSS

Small 6 lobe threaded handle - male, Duroplast - Stainless steel