

Rotating lifting ring

VLBG  **RUD**

Base rotates through 360°

- Bolt on arched lifting ring, wider opening
- Rotates through 360° for easy alignment to lifting direction
- Clamping spring holds the suspension ring in the requested position and reduces noise
- Surface finish: Pink thermochromic coating offers high wear/corrosion resistance
- Operating instructions: see next page



Standard

With longer thread and nut



Pivots through 180°

Full 360° rotation

Option

- Can be supplied with a longer thread and a mounting screw for use with a through hole or for mounting on lighter metals such as aluminium

Info.

- Conforms to machine Directive 2006/42/CE

4 Suitable for lifting in any direction
Factor of safety = 4

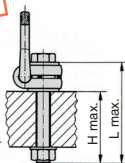
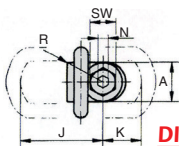
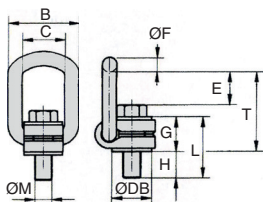

BG certified



EMI OFB
005151



DISCOUNTS

Qty	1+	5+	10+	15+
Disc.	List	-3%	-6%	On request

Part number	SWL (t)	A	B max.	C	E	ØF	G	H stand.	H max.	J
VLBG-M8	0,63	30	54	34	40	10	29	11	76	75
VLBG-M10	0,90	30	54	34	39	10	29	15	96	75
VLBG-M12	1,35	32	54	34	38	10	29	18	116	75
VLBG-M16	2,00	33	56	36	39	13,5	36	22	149	86
VLBG-M20	3,50	50	82	54	55	16,5	43	32	187	113
VLBG-M24	4,50	50	82	54	67	18	43	37	222	130
VLBG-M30	6,70	60	103	65	67	22,5	61	49	279	151

Part number	L stand.	L max.	ØM	N	SW	R	T	ØDB	Max torque (Nm)	Weight (kg)	Stock*	Price each 1 to 4	
VLBG-M8	45	40	105	M8	5	13	32	75	24	30	0,3	✓	100,50 €
VLBG-M10	45	44	125	M10	6	17	32	75	24	60	0,32	✓	98,71 €
VLBG-M12	45	47	145	M12	8	19	32	75	26	150	0,33	✓	100,50 €
VLBG-M16	47	58	185	M16	10	24	38	85	30	150	0,55	✓	107,43 €
VLBG-M20	64	75	230	M20	12	30	48	110	45	400	1,3	✓	122,92 €
VLBG-M24	78	80	265	M24	14	36	48	125	45	760	1,5	-	132,03 €
VLBG-M30	80	110	340	M30	17	46	67	147	60	1000	3,3	-	239,91 €

*Depending on availability - Dimensions in mm

Rotating lifting ring

Base rotates through 360°

 RUD® VLBG

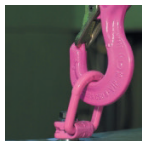

- The ring, thread and nut are all certified and are 100% tested for cracks
- Metric versions have a **universal hexagonal** (external and internal) head that allows use of common tools.
- **Multiple surface coatings for increased protection:** the special CORRU-DT (RUD patent) pre-coat guarantees **anti corrosion protection 20 times higher** than galvanising.
*except for the cut surface of any shortened threads
- Screwed part "H" is threaded along entire length
- Ensure that the mating surface (R) is truly flat. When fully tightened, the ring must be able to rotate through 360°.
- The lifting ring should be aligned in the direction of lift and be able to move freely. It should not be any edge as a support.
Do not rotate the ring whilst under load.
- Only for use by trained personnel and strictly in accordance with local lifting safety regulations.

Not allowed!



Not allowed!

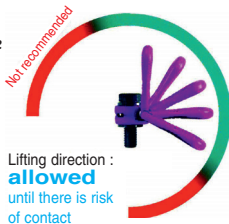

Why are RUD lifting rings "pink"?

Some RUD lifting rings have a patented pink finish. This vibrant fluorescent coating is heat sensitive and will change colour as the temperature rises.

Initially pink, as the temperature increases the colour will change to beige, then brown and finally black.

If the ring is black and there are blisters, a temperature of 400°C has been exceeded. This implies a reduction in the carrying capacity and maximum working temperature.

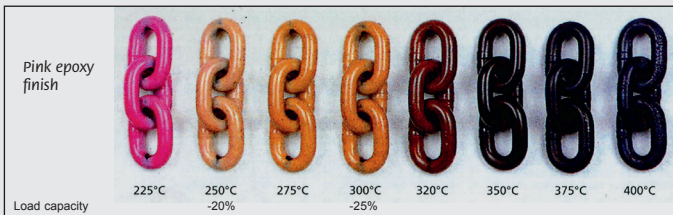

Our other products



VQT

Quarter-turn clamp lock, Plastic or stainless steel button



ASH

Hoist ring for welding, for straight lifts - for welding



CAMTH

Thermal camera for use with smartphone, iOS and Android



CLSLCP_SS

Clevis components, short version, Stainless steel - short range



TBD

Manual leadscrew table with opposing threads, 20kg



UCF_PBT

Stainless steel/Polymer flanged bearing, Polymer and stainless steel



FF15

Offset spur gear reducer, from 2.20 to 10 Nm



GGP

Male wing knob, Technopolymer with brass spindle



PR40

Articulated foot Ø40, Ø 40



PTCR

Adjustable furniture foot, square tube



AC

Strike for toggle latch, 15mm



HTD5M_25

HTD Heavy duty timing pulley, HTD5 Aluminium

Complementary products



VRSF

Male swivelling lifting ring, Male swivelling



WBGV

Lifting ring, Threaded