

Cast iron pillow block bearing



UCP

2 mounting points

- Self-aligning bearing
- Spherical external ring
- Working temperature range: -30 to +100°C
- Material:
 - Bearing: steel
 - Housing: cast iron
- Maximum speed depends on the shaft tolerance

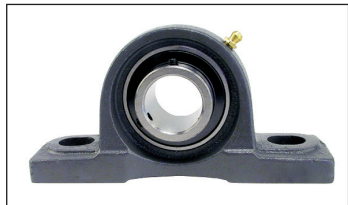

Use

- Mounting a single bearing

Option

- Version suitable for the food industry

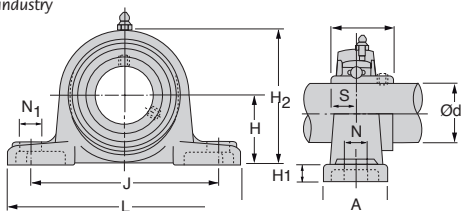

Part number	Load (kN)		Speed/tolerance (rpm)			
	dynamic	static	j7	h7	h8	h9
UCP204	12,2	6,35	6700	4900	3500	1250
UCP205	13,3	7,50	5600	4100	2900	1050
UCP206	18,6	10,80	4700	3400	2400	880
UCP207	24,5	14,60	4000	3000	2100	760
UCP208	27,7	17,00	3600	2600	1900	660
UCP209	31,0	19,50	3300	2400	1700	620
UCP210	33,5	22,50	3000	2200	1600	570
UCP211	41,5	28,00	2700	2000	1400	510
UCP212	50,0	34,50	2400	1600	1250	460

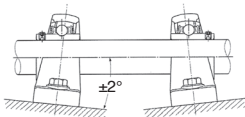

DISCOUNTS

Qty	1+	6+	10+	20+
Disc.	List	-20%	-40%	On request

Part number	Bore											Bolt size	Stock*	Price each 1 to 5
	Ød	H	L	J	A	N	N1	H1	H2	S	B			
UCP204	20	33,3	127	95	38	13	19	14	65,0	12,7	31,0	M10	✓	13,24 €
UCP205	25	36,5	140	105	38	13	19	15	71,0	14,3	34,1	M10	✓	14,30 €
UCP206	30	42,9	165	121	48	17	20	17	84,0	15,9	38,1	M14	✓	17,94 €
UCP207	35	47,6	167	127	48	17	20	18	93,0	17,5	42,9	M14	✓	22,78 €
UCP208	40	49,2	184	137	54	17	20	18	100,0	19,0	49,2	M14	✓	26,85 €
UCP209	45	54,0	190	146	54	17	20	20	106,0	19,0	49,2	M14	✓	31,19 €
UCP210	50	57,2	206	159	60	20	23	21	113,0	19,0	51,6	M16	✓	40,37 €
UCP211	55	63,5	219	171	60	20	23	23	125,0	22,2	55,6	M16	-	49,08 €
UCP212	60	69,8	241	184	70	20	23	25	138,0	25,4	65,1	M16	✓	60,55 €

*Depending on availability - Dimensions in mm

HPC

WEB
04/2020

www.hpceurope.com

Tél: 0 825 88 5000 Service 0,15 €/min + prix appel

Our other products



CHAGC-AL
Screw-in garnet
hinge, Screw-on



NCT
Square tube
connector, Fixed
angle



YG4
HEAVY DUTY spur
gear, Steel 35NCD6



CNA-CNG
Right angled
mounting plate, Right
angled mounting
plate for clevis



WJUM10
Drylin® W bearing
block, Slide



BPM-Z
Plastic slotted spring
plunger with ball tip,
Plastic body +
plastic...



BAGtr
Lead screw clamping
collar, Aluminium



PW_PWG15
Worm - precision
range, Steel

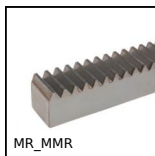

MR_MMR
Metric section rack,
Steel

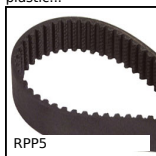

RPP5
RPP heavy duty
timing belt, RPP5



NPTR_M
Adjustable cross
clamp, Adjustable



COA-COG
Surface mounting
plate, Surface
mounting plate for
ball joint

Complementary products



UCF
Cast iron flange
bearing unit, Cast iron



UCFL
Cast iron flanged
bearing, Cast iron



SNG
Stainless/Polymer
pillow block bearing,
Cast iron - Split pillow