

Cast iron pillow block bearing



UCP

2 mounting points

- Self-aligning bearing
- Spherical external ring
- Working temperature range: -30 to +100°C
- Material:
 - Bearing: steel
 - Housing: cast iron
- Maximum speed depends on the shaft tolerance

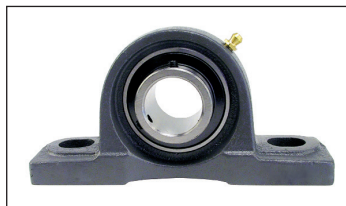

Use

- Mounting a single bearing

Option

- Version suitable for the food industry

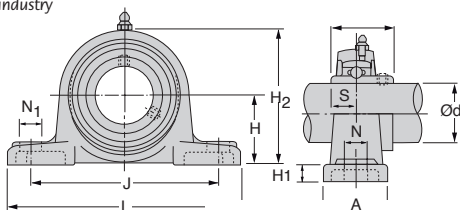

Part number	Load (kN)		Speed/tolerance (rpm)			
	dynamic	static	j7	h7	h8	h9
UCP204	12,2	6,35	6700	4900	3500	1250
UCP205	13,3	7,50	5600	4100	2900	1050
UCP206	18,6	10,80	4700	3400	2400	880
UCP207	24,5	14,60	4000	3000	2100	760
UCP208	27,7	17,00	3600	2600	1900	660
UCP209	31,0	19,50	3300	2400	1700	620
UCP210	33,5	22,50	3000	2200	1600	570
UCP211	41,5	28,00	2700	2000	1400	510
UCP212	50,0	34,50	2400	1600	1250	460

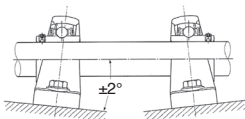

DISCOUNTS

Qty	1+	6+	10+	20+
Disc.	List	-20%	-40%	On request

Part number	Bore											Bolt size	Stock*	Price each 1 to 5
	Ød	H	L	J	A	N	N1	H1	H2	S	B			
UCP204	20	33,3	127	95	38	13	19	14	65,0	12,7	31,0	M10	✓	13,24 €
UCP205	25	36,5	140	105	38	13	19	15	71,0	14,3	34,1	M10	✓	14,30 €
UCP206	30	42,9	165	121	48	17	20	17	84,0	15,9	38,1	M14	✓	17,94 €
UCP207	35	47,6	167	127	48	17	20	18	93,0	17,5	42,9	M14	✓	22,78 €
UCP208	40	49,2	184	137	54	17	20	18	100,0	19,0	49,2	M14	✓	26,85 €
UCP209	45	54,0	190	146	54	17	20	20	106,0	19,0	49,2	M14	✓	31,19 €
UCP210	50	57,2	206	159	60	20	23	21	113,0	19,0	51,6	M16	✓	40,37 €
UCP211	55	63,5	219	171	60	20	23	23	125,0	22,2	55,6	M16	-	49,08 €
UCP212	60	69,8	241	184	70	20	23	25	138,0	25,4	65,1	M16	✓	60,55 €

*Depending on availability - Dimensions in mm

Our other products



MSP38

Masterplate® glueable insert Ø38, Cylindrical Ø38 with tapped ins...



PITAss

Locking bolt, with T handle



BAP25

Plastic clamping collar, Ø25 - Ø40



PML

Solid foot mount for heavy loads, Ø 100, 120 or 150

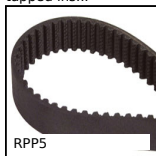

RPP5

RPP heavy duty timing belt, RPP5



TBEBASE

Base plate for economic mini-table, Allows X-Y cross tables

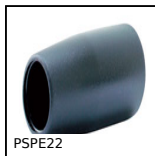

PSPE22

Conical flexible shaft handle Ø22, Black PVC



WJUM20

Drylin® W bearing block, Slide



BAC105

Storage bin, 8mm



BG

Oldham coupling, With set screw

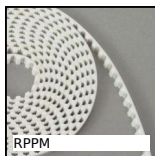

RPPM

RPP type belt per metre, RPP8 Steel cored polyurethane



PTA150

Articulated levelling foot, pressed base Ø150, Ø 150

Complementary products



UCF

Cast iron flange bearing unit, Cast iron



UCFL

Cast iron flanged bearing, Cast iron



SNG

Stainless/Polymer pillow block bearing, Cast iron - Split pillow