



Cast iron flange bearing unit

4 mounting points

UCF

- Self-aligning bearing
- Spherical external ring
- Working temperature range: -30 to +100°C
- Material:
 - Bearing: steel
 - Housing: cast iron
- Maximum speed depends on the shaft tolerance

Use

- Mounting a single bearing

Option

- Version suitable for the food industry

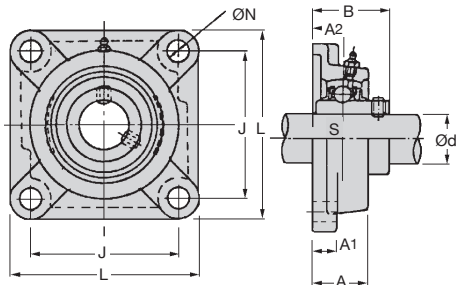

Part number	Load (kN)		Speed/tolerance (rpm)			
	dynamic	static	j7	h7	h8	h9
UCF204	12,2	6,35	6700	4900	3500	1250
UCF205	13,3	7,50	5600	4100	2900	1050
UCF206	18,6	10,80	4700	3400	2400	880
UCF207	24,5	14,60	4000	3000	2100	760
UCF208	27,7	17,00	3600	2600	1900	660
UCF209	31,0	19,50	3300	2400	1700	620
UCF210	33,5	22,50	3000	2200	1600	570
UCF211	41,5	28,00	2700	2000	1400	510
UCF212	50,0	34,50	2400	1600	1250	460

DISCOUNTS

Qty	1+	6+	10+	20+
Disc.	List	-20%	-40%	On request

Part number	Bore								Bolt size	Stock*	Price each 1 to 5	
	Ød	L	J	A2	A1	A	B	ØN				
UCF204	20	86	64	15	12	25,5	33,3	12	12,7	M10	✓	13,24 €
UCF205	25	95	70	16	14	27,0	35,8	12	14,3	M10	✓	14,30 €
UCF206	30	108	83	18	14	31,0	40,2	12	15,9	M10	✓	17,94 €
UCF207	35	117	92	19	16	34,0	44,4	14	17,5	M12	✓	22,78 €
UCF208	40	130	102	21	16	36,0	51,2	16	19,0	M14	✓	26,85 €
UCF209	45	137	105	22	18	38,0	52,2	16	19,0	M14	-	31,19 €
UCF210	50	143	111	22	18	40,0	54,6	16	19,0	M14	✓	40,37 €
UCF211	55	162	130	25	20	43,0	58,4	19	22,2	M16	-	49,08 €
UCF212	60	175	143	29	20	48,0	68,7	19	25,4	M16	✓	60,55 €

*Depending on availability - Dimensions in mm

Our other products



SBS_L
Chain link, Stainless steel



J51
Spur gear coaxial gearbox, from 0.13 to 0.49 Nm - In-line



CHAE4080PA
Symmetrical decorative screwed hinge, Polyamide



MEF
Cylindrical sintered ferrous bush, Self-lubricating FP20 ferrous all...



VTA
Vari-Tork® slip friction clutch, 0.53 to 1.32 Nm



SBF
Sealed flange bearing unit for Food Industry, cover



CHM50
Worm and wheel gear reducer, up to 107 Nm



OP3
Mechanical digital position indicator, 4 numbers



SCA_SS
Stainless steel flat cable clamp, Stainless steel



RFVbr
Stainless steel reaction arm, Reaction arm



HTD8M_20
HTD Heavy duty timing pulley, HTD8 Steel



SEV
Vertical stirrup toggle clamp, Vertical Latch Clamp - steel

Complementary products



UCP
Cast iron pillow block bearing, Cast iron



UCFL
Cast iron flanged bearing, Cast iron

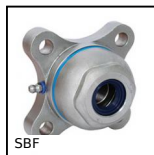

SBF
Open flange bearing unit for food industry, cover



SBF
Sealed flange bearing unit for Food Industry, cover