

- Pressure angle 20°
- Diameter tolerance h11
- Material:
drawn stainless steel 304

In stock
up to module 2

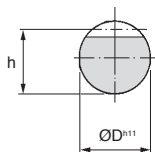
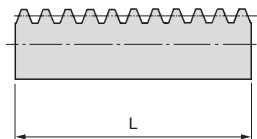

DISCOUNTS

Qty	1+	3+	6+
Disc.	List	-10%	On request

Part number	Module	h (mm)	ØD (mm)	L (mm)	Stock*	Price each 1 to 2
TRM1-1000/SS	1	9,00	10	999	✓	121,99 €
TRM1.5-1000/SS	1,5	13,50	15	999	✓	176,24 €
TRM2-1000/SS	2	18,00	20	999	✓	171,48 €
TRM2.5-1000/SS	2,5	22,50	25	997	-	On request
TRM3-1000/SS	3	27,00	30	999	-	On request
TRM4-1000/SS	4	36,00	40	1005	-	On request
TRM5-1000/SS	5	45,00	50	1005	-	On request

*Depending on availability - Dimensions in mm

Our other products



BOX-TOR-C

Box set of Nitrile O-rings in nitrile, 3.00 x 1.50mm to 30.20 x 3.00



RCC_RCX

Spherical tilt washer - DIN6319, convex



INS_BR

Self tapping brass insert, Brass



M1

Worm and wheel set, Bronze



CABtool

Fitting cable tools, Crimping tools



PPJ

Indexing plunger with flange, With horizontal mounting flange and pu...



GE14

Toggle latches, With padlock-holder



GTC

Belt tensioner, For standard applications



GE

Toggle latches, Miniature



DER90

Stainless steel AC asynchronous motor 1.1 - 1.5kW, 1.1 to



SEV

Vertical stirrup toggle clamp, Vertical Latch Clamp - steel



GBMf

Flanged leadscrew nut, Flanged nut - Multiple starts

Complementary products

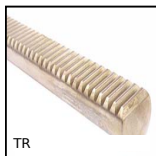

TR

Spur round rack, Stainless steel - module 0,25-1,5



TRM

Spur round rack, Steel - module 1-6



SSG1

Stainless steel spur gear, Stainless steel 304L



SSG1_304L

Stainless steel spur gear, Stainless steel 304L