

Short swivel head



TOC

Brass or stainless steel

- For guiding profile

- Materials:

Body: nickel brass or stainless steel

Nut/washer: stainless steel



stainless
steel
version

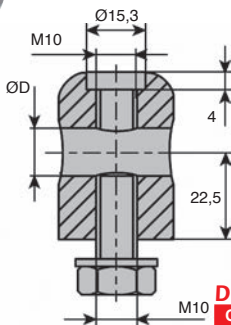
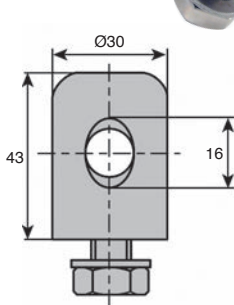

DISCOUNTS

Qty	1+	10+	20+
Disc.	List	-5%	On request

Part number	ØD	For Axis	Weight (kg)	Stock*	Price each 1 to 9
Nickel brass version					
TOC-12	12,5	APB12	0,18	✓	9,79 €
TOC-14	14,5	APB14	0,18	-	9,79 €
TOC-16	16,5	APB16	0,18	-	9,79 €
Stainless steel version					
TOC-12/SS	12,5	APB12	0,18	✓	16,06 €
TOC-14/SS	14,5	APB14	0,17	✓	15,79 €
TOC-16/SS	16,5	APB16	0,17	✓	15,79 €

*Depending on availability - Dimensions in mm

Our other products



GGB

Female wing knob,
With blind thread



GEC

Rubber latch clamp
with strike plate,
Lockable



BLHB30

Right angled gearbox,
bored shafts, up to
4.47 Nm



SBF

Open flange bearing
unit for food industry,
cover



PTCR

Adjustable furniture
foot, square tube



PGNT

Thermoplastic T
handle, With threaded
insert



PR125rehausse

Extension for
articulated foot Ø123,
articulated foot PR125

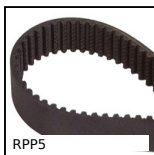

RPP5

RPP heavy duty
timing belt, RPP5

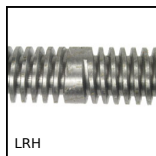

LRH

Bi-directional
leadscrew, Bi-
directional - 1 thread



CSSSS

Stainless steel
spherical bearing,
Stainless steel / PTFE



NRR

Adjustable support
clamp, Adjustable
support clamp



BDM

Pin for magnetic bush,
Fast and light
magnetic locking

Complementary products



RAG-12-M8

Roller guide
accessory, Anchoring
system



RAG

Roller guide,