

Short swivel head



TOC

Brass or stainless steel

- For guiding profile

- Materials:

Body: nickel brass or stainless steel

Nut/washer: stainless steel



stainless
steel
version

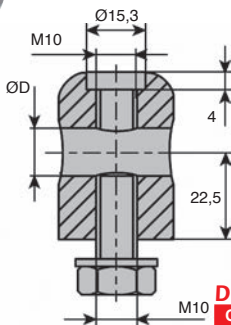
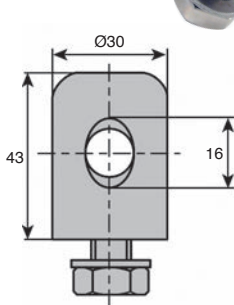

DISCOUNTS

Qty	1+	10+	20+
Disc.	List	-5%	On request

Part number	ØD	For Axis	Weight (kg)	Stock*	Price each 1 to 9
Nickel brass version					
TOC-12	12,5	APB12	0,18	✓	9,79 €
TOC-14	14,5	APB14	0,18	-	9,79 €
TOC-16	16,5	APB16	0,18	-	9,79 €
Stainless steel version					
TOC-12/SS	12,5	APB12	0,18	✓	16,06 €
TOC-14/SS	14,5	APB14	0,17	✓	15,79 €
TOC-16/SS	16,5	APB16	0,17	✓	15,79 €

*Depending on availability - Dimensions in mm

Our other products



SLHVlok

Horizontal toggle clamp, Horizontal toggle clamp / vertical foot



DB

Steel bevel gear, 2:1



ZDB

Machined plastic bevel gear , 2:1



SDB

Locking bolt support bracket, Mounting holes at 90° to locating bolt



T39_T49

Extension spring in metre length steel, by the metre



SC2

2 part rigid shaft clamp, Clamping jaw



P70

Worm and wheel gear reducer, up to 164 Nm



PSG05S

Spur gear - precision range, Stainless steel 316



PM3

Worm and wheel set, Bronze



PPRss

Pad eye on mounting plate round, Stainless steel



AT5P_AT10P

Connecting plate for AT type timing belts, AT10



PPF

Indexing plunger with flange, with drilled flange

Complementary products



RAG-12-M8

Roller guide accessory, Anchoring system



RAG

Roller guide,