

Stainless steel rigging screw with hook/eye

Turnbuckle

TACss

- Rigging screw with eye and hook
- Fitting component
- Material: stainless steel 316

Info.

- SWL: safe working load.
- The Safe Working Load is calculated by dividing the breaking load by a factor of safety of 3

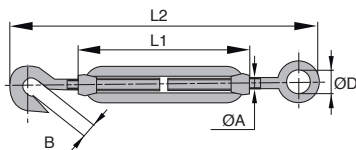
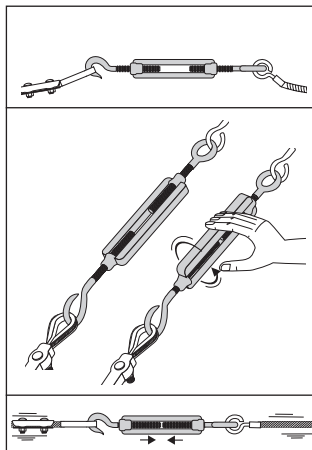

DISCOUNTS

Qty	1+	5+	10+	20+	30+
Disc. List	-5%	-10%	-15%	On request	

Part number	ØA	B	ØD	L1	L2	SWL (kg)	Weight (kg)	Stock*	Price each 1 to 4
TAC1-05/SS	M5	9	8,3	71	122-179	180	0,046	✓	9,38 €
TAC1-06/SS	M6	9,5	10,0	90	160-228	360	0,076	✓	11,24 €
TAC1-08/SS	M8	11	12,0	120	210-303	650	0,165	✓	19,44 €
TAC1-10/SS	M10	13	15,8	150	255-376	1000	0,285	✓	24,81 €
TAC1-12/SS	M12	16,8	20,0	200	305-473	1400	0,515	-	38,04 €
TAC1-16/SS	M16	16,3	26,0	245	400-593	2300	1,110	-	77,15 €

*Depending on availability - Dimensions in mm

Our other products



SSHBRA
Stainless steel bevel gear, 1,5:1 2:1 3:1



NT92
Spur gear coaxial gearbox, from 15 to 40 Nm - Inline



WJUM16
Drylin® W bearing block, Slide



PRF_GAL
Roller for aluminium profile, Fixing kit for roller concentric



ACLAPA
Magnetic stop for aluminium profile, Magnetic stop



HTD14M_85
HTD Heavy duty timing pulley, HTD14 Steel

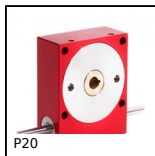

P20
Worm and wheel gear reducer, up to 5 Nm

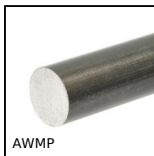

AWMP
Aluminium shaft for linear guide, Aluminium



T5-16ECO
T type timing pulley, Economy range - T5 aluminium



HK
Manual locking clamp, Manual locking clamp LWL



DOMI80
Domino 80 adjustable slide, Slide DOMILINE 80 with counter and handw...



ACL-FPA
Panel mounting block for aluminium structures, Angular connector

Complementary products



TAC
Rigging screw (hook/eye), Steel



TCC_SS
Stainless steel rigging screw (hook/hook), Stainless steel



MDR_SS
Stainless steel Dee shackle with eye bolt, Stainless steel



MLY_SS
Stainless steel bow shackle with eye bolt, Stainless steel