

# Stainless steel rigging screw with hook/eye

Turnbuckle

TACss

- Rigging screw with eye and hook
- Fitting component
- Material: stainless steel 316

## Info.

- SWL: safe working load.
- The Safe Working Load is calculated by dividing the breaking load by a factor of safety of 3

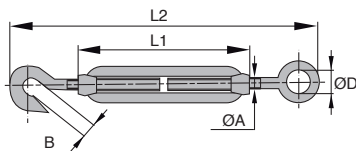
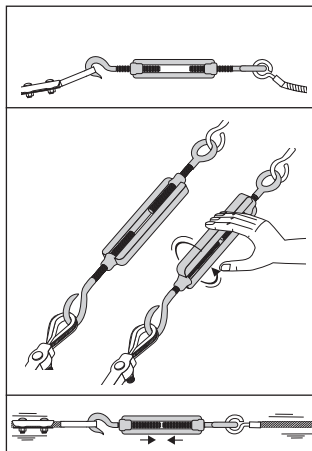

## DISCOUNTS

Qty	1+	5+	10+	20+	30+
Disc. List	-5%	-10%	-15%	On request	

Part number	ØA	B	ØD	L1	L2	SWL (kg)	Weight (kg)	Stock*	Price each 1 to 4
TAC1-05/SS	M5	9	8,3	71	122-179	180	0,046	✓	9,38 €
TAC1-06/SS	M6	9,5	10,0	90	160-228	360	0,076	✓	11,24 €
TAC1-08/SS	M8	11	12,0	120	210-303	650	0,165	✓	19,44 €
TAC1-10/SS	M10	13	15,8	150	255-376	1000	0,285	✓	24,81 €
TAC1-12/SS	M12	16,8	20,0	200	305-473	1400	0,515	-	38,04 €
TAC1-16/SS	M16	16,3	26,0	245	400-593	2300	1,110	-	77,15 €

\*Depending on availability - Dimensions in mm

## Our other products



BPHRF

Ball transfer unit  
housed spring loaded,  
High



SBF

Sealed flange bearing  
unit for Food Industry,  
cover



G01

Single universal joint,  
Normal duty



PCS62

Chain sprocket - steel,  
15.875 (DIN 10B-1)



BPL

Ball transfer unit light  
duty, Light



CHAR7520

Spring hinge, screwed



YG1

HEAVY DUTY spur  
gear, Steel 35NCD6



TUBE25\_25

Square Tube,  
Aluminium or  
Stainless steel



PRF-SCREEN-1

Screen support, Basic  
support



AT10courroie

AT type timing belt,  
AT10 Steel cored  
polyurethane



PTA50ssEB

Articulated foot with  
sheet metal base  
Ø50, Articulated foot



P60

Worm and wheel gear  
reducer, up to 118  
Nm

## Complementary products



TAC

Rigging screw  
(hook/eye), Steel



TCC\_SS

Stainless steel rigging  
screw (hook/hook),  
Stainless steel



MDR\_SS

Stainless steel Dee  
shackle with eye bolt,  
Stainless steel



MLY\_SS

Stainless steel bow  
shackle with eye bolt,  
Stainless steel