

# Rigging screw with hook/eye

Stock Ste

## TAC

## Turnbuckle

- Stamped Rigging screw with eye and hook
- Fitting component
- Material: zinc plated steel Fe430B



### Info.

- SWL: safe working load.  
The Safe Working Load is calculated by dividing the breaking load by a factor of safety of 3
- Not sold individually, please contact us for details

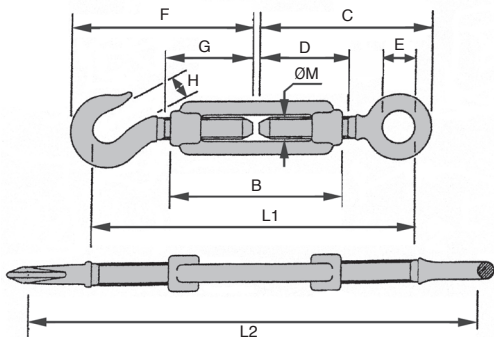

### DISCOUNTS

Qty	1+	5+	10+	20+	30+	50+
Disc.	List	-5%	-10%	-15%	-20%	On request

Part number	ØM	B	C	D	E	F	G	H	L1	L2	SLW (kg)	Weight (kg)	Price each
TAC1-05	M5	80	60	40	8	62	40	6	114	176	50	0,055	2,71 €
TAC1-06	M6	80	74	47	10	76	50	8	141	200	75	0,064	3,03 €
TAC1-08	M8	105	79	52	11	88	52	10	156	236	165	0,126	3,89 €
TAC1-10	M10	125	95	61	14	114	60	11	187	276	235	0,214	5,59 €
TAC1-12	M12	140	105	65	17	122	66	16	226	311	320	0,398	8,36 €
TAC1-14	M14	170	128	85	18	147	82	15	254	378	430	0,608	11,59 €
TAC1-16	M16	190	160	97	23	172	105	20	296	466	530	0,845	16,11 €

\*Depending on availability - Dimensions in mm

HPC

WEB  
04/2020

www.hpceurope.com

Tél: 0 825 88 5000 Service 0,15 €/min + prix appel

## Our other products



RUR  
Wheel, Polyurethane -  
Aluminium rim (Free  
running)



BLHB50  
Right angled gearbox,  
bored shafts, up to 30  
Nm



GE1006  
Elastic ringed latch,  
Hooks into a slot



NAST  
Cam follower without  
axial guide, With  
interior ring

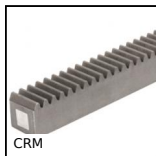

CRM  
Moulded nylon rack,  
Nylon



PCS62SS  
Chain sprocket -  
Stainless steel,  
15.875mm (DIN  
08B-1)



RTE  
Rotex®, jaw coupling,  
steel



INO  
Internal gear,  
Machined plastic  
(delrin)



WS16  
Drylin® W rail, Rail



RFK58C  
Hypoid gearbox -  
Stainless steel, up to  
500 Nm



P20  
Worm and wheel gear  
reducer, up to 5 Nm



T5M T10M  
T type timing belt per  
metre, T10 Steel  
cored polyurethane

## Complementary products



TAC\_SS  
Stainless steel rigging  
screw (hook/eye),  
Stainless steel



TCC  
Rigging screw  
(hook/hook), Steel



MDR  
Dee shackle with eye  
bolt, Steel

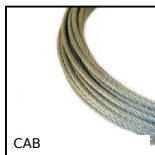

CAB  
Galvanised steel  
cable, Galvanised  
steel