

# T type toothed timing pulley bar stock

## T2.5-BAR

Aluminium



- **Toolthed bar stock to be cut to length by the customer**
- The overall length is the same as the maximum length
- Material : Aluminium suitable for hard anodic oxidation
- Finish : Supplied not-treated

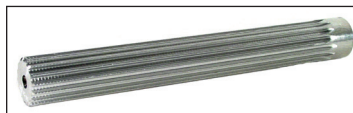

### Info.

- We are unable to modify this product

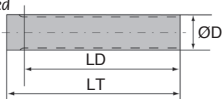

### DISCOUNTS

Qty	1+	2+	4+
Disc.	List	-20%	On request

Part number	Z Teeth	ØD External	Length of teeth L <sub>D</sub>	Total length L <sub>T</sub>	Price each
10T2.5-BAR	10	7,45	50	75	2,71 €
12T2.5-BAR	12	9,00	50	75	2,78 €
13T2.5-BAR	13	9,80	50	75	2,90 €
14T2.5-BAR	14	10,60	50	75	3,09 €
15T2.5-BAR	15	11,40	50	75	3,29 €
16T2.5-BAR	16	12,20	50	75	3,38 €
17T2.5-BAR	17	13,00	50	75	3,45 €
18T2.5-BAR	18	13,80	50	75	3,59 €
19T2.5-BAR	19	14,60	90	120	6,54 €
20T2.5-BAR	20	15,40	90	120	6,84 €
21T2.5-BAR	21	16,20	90	120	7,45 €
22T2.5-BAR	22	17,00	125	140	9,72 €
24T2.5-BAR	24	18,55	125	140	10,54 €
26T2.5-BAR	26	20,15	125	140	11,54 €
27T2.5-BAR	27	20,95	125	140	11,65 €
28T2.5-BAR	28	21,75	125	140	11,97 €
29T2.5-BAR	29	22,55	125	140	12,66 €
30T2.5-BAR	30	23,35	125	140	12,73 €
32T2.5-BAR	32	24,95	125	140	13,80 €
34T2.5-BAR	34	26,55	125	140	14,50 €
35T2.5-BAR	35	27,35	132	140	15,42 €
36T2.5-BAR	36	28,10	132	140	16,54 €
38T2.5-BAR	38	29,70	140	140	16,84 €
40T2.5-BAR	40	31,30	140	140	18,16 €
42T2.5-BAR	42	32,90	140	140	20,22 €
44T2.5-BAR	44	34,50	140	140	22,46 €
45T2.5-BAR	45	35,30	140	140	22,92 €
48T2.5-BAR	48	37,70	140	140	24,26 €
50T2.5-BAR	50	39,29	160	160	29,48 €
60T2.5-BAR	60	47,25	160	160	38,23 €
65T2.5-BAR	65	51,20	160	160	44,19 €
70T2.5-BAR	70	55,20	160	160	48,36 €
72T2.5-BAR	72	56,80	160	160	51,03 €
90T2.5-BAR	90	71,12	160	160	74,03 €
100T2.5-BAR	100	79,08	160	160	99,01 €

Dimensions in mm

## Our other products



EZY  
Cylindrical stop, Steel



DGSi  
Female rod ends,  
Steel / steel -  
Economy range



PTAF100-PAMF100  
Articulated fixable  
foot with pressed  
base Ø100, Ø 100



INStool  
Insertion tool for self  
tapping inserts,  
Insertion tool



SCA\_SS  
Stainless steel flat  
cable clamp, Stainless  
steel



PRF-GPB  
Guide for aluminium  
profile, Rail for 8mm  
wide slots



PR40  
Articulated foot Ø40,  
Ø 40



PNA  
PERIFLEX® elastic  
coupling, Complete  
coupling



AFM  
Flanged polymer  
bush, Food grade



SHN  
Hexagonal nut  
DIN934, A2 Stainless

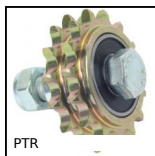

PTR  
Idler chain sprocket,  
For standard



GE  
Toggle latches,  
Miniature

## Complementary products



T5-BAR  
T type tooth bar  
stock, T5



T25-6ECO  
T type timing pulley,  
Economy range - T2.5  
aluminium

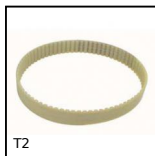

T2  
T type timing belt,  
T2.5 Steel cored  
polyurethane



T2  
T type timing belt,  
T2.5 Steel cored  
polyurethane