

Aluminium

Pitch  
**T10**

Belt width 25mm



- Pitch 10mm
- Materials:  
Pulley: aluminium  
Flanges: steel

## Info.

- \*\*Pilot bore given as a guide only
- We are unable to modify these parts

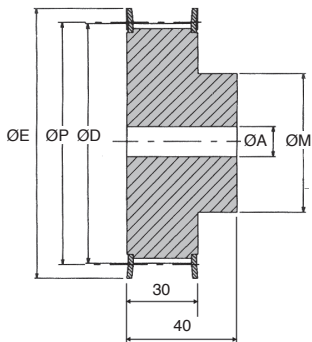

**Economy range**

## DISCOUNTS

Qty	1+	6+	10+	20+
Disc.	List	-12%	-20%	On request

Part number	Z teeth	PCD (mm)	ØD (mm)	ØE (mm)	ØM (mm)	Pilot bore not guaranteed ØA**	Stock*	Price each 1 to 5
12T10-30-AL	12	38,35	36,35	42	28	6	✓	9,89 €
14T10-30-AL	14	44,70	42,70	48	32	8	✓	12,22 €
15T10-30-AL	15	47,90	45,90	51	32	8	✓	13,45 €
16T10-30-AL	16	51,10	49,10	54	35	8	✓	15,02 €
18T10-30-AL	18	57,45	55,45	60	40	8	✓	17,95 €
19T10-30-AL	19	60,65	58,65	66	44	8	✓	20,11 €
20T10-30-AL	20	63,80	61,80	66	46	8	✓	21,52 €
22T10-30-AL	22	70,20	68,20	75	52	8	✓	26,93 €
24T10-30-AL	24	76,55	74,55	83	58	8	✓	30,26 €
25T10-30-AL	25	79,75	77,75	83	60	8	-	30,62 €
26T10-30-AL	26	82,90	80,90	87	60	8	-	33,94 €
27T10-30-AL	27	86,10	84,10	91	60	8	✓	37,40 €
28T10-30-AL	28	89,25	87,25	93	60	8	✓	37,46 €
30T10-30-AL	30	95,65	93,65	102	60	8	✓	44,86 €
32T10-30-AL	32	102,00	100,00	106	65	10	✓	48,78 €
36T10-30-AL	36	114,75	112,75	119	70	10	✓	57,66 €
40T10-30-AL	40	127,45	125,45	131	80	10	✓	71,72 €

\*Depending on availability - Dimensions in mm

## Our other products



ZHG5  
Plastic spur gear,  
Machined plastic  
(delrin)

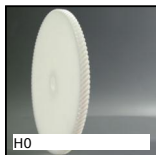

H0  
Crossed helical gear  
crossed axis at 90°,  
Machined plastic  
(delrin)



BLH70  
Right angled gearbox,  
from 26 to 128 Nm



CFF  
Female rod ends DIN  
ISO12240-4, Steel /  
bronze



VDSCB  
Sliding lock  
adjustment system,  
Blocking wedge for  
sliding lock for ...



GPB  
Threaded spherical  
knob, With brass  
insert



DOMI50  
Domino 50 adjustable  
slide, Slide DOMILINE  
50 with counter and  
handw...



AT5P\_AT10P  
Connecting plate for  
AT type timing belts,  
AT5



SCH  
Horizontal hook  
toggle clamp,  
Horizontal Hook



CHAEpac  
Square decorative  
screwed hinges,  
carbon fibre



ATZY  
Diabolo shaped elasto  
mount, Steel



EKGS  
Backlash free  
coupling Gerwah®,  
from 0.5 to 35Nm

## Complementary products



T10courroie  
T type timing belt,  
T10 Steel cored  
polyurethane



T10-BAR  
T type tooth bar  
stock, T10



GTC  
Belt tensioner, For  
standard applications

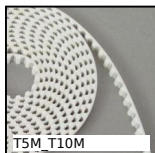

T5M\_T10M  
T type timing belt per  
metre, T10 Steel  
cored polyurethane