

Single chain supplied by the metre **Ste** **DIN** **Stock**

Pitch

4.0 to

19.05 mm

Steel

- DIN 8187 (European Standard)
- ISO 606
- Compatible with standard HPC sprockets
- Supplied in multiples of either 1, 5 metre (in box) or 50 metre (in chain reel) lengths depending on model

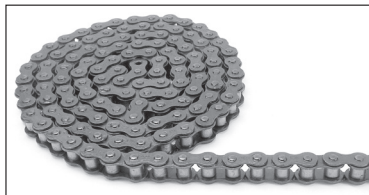

Option

- American pitch (ASA) available on request

Accessories

- TRE arm and PTR sprocket idlers
- Roll-Ring® RLR idler (tome 4 p.128 to p.141)



New in chain reel

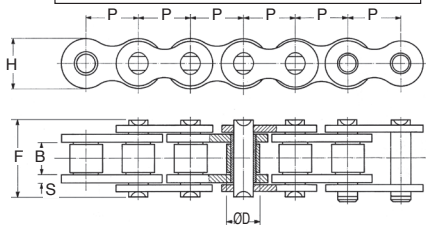

DISCOUNTS A

No. metres	1+	10+	25+	55+
Discount	List	-5%	-10%	On request

DISCOUNTS B

No. metres	1+	100+
Discount	List	On request

Part number	DIN	Pitch		Roller			Breaking strength (kN)	Sold in multiples of	Stock	Price per metre
		P (mm)	B (mm)	ØD (mm)	F (mm)	H (mm)				
In box										
SUA-4	-	4,00	2,70	2,50	6,8	4,1	-	1,8	1 metre	✓ A185,10 €
SUA-6/M	04-1	6,00	2,80	4,00	7,8	5,0	0,60	3	5 metres	✓ A12,64 €
SUA-250/M	-	6,35	3,30	3,30	8,0	6,0	-	4	5 metres	✓ A15,49 €
SBR-8/M	05B-1	8,00	3,00	5,00	8,9	7,1	0,80	5	5 metres	✓ A10,49 €
SBR-375/M	06B-1	9,52	5,72	6,35	14,1	8,2	1,30	9	5 metres	✓ A8,08 €
SBR-500/M	08B-1	12,70	7,75	8,51	18,2	11,8	1,60	18	5 metres	✓ A7,81 €
SBR-625/M	10B-1	15,88	9,65	10,16	20,9	14,7	1,70	22,4	5 metres	✓ A9,74 €
SBR-750/M	12B-1	19,05	11,68	12,07	24,2	16,0	1,85	29	5 metres	✓ A12,53 €

In chain reel

SUA-6/M/T	04-1	6,00	2,80	4,00	7,8	5,0	0,60	3	50 metres	
SBR-8/M/T	05B-1	8,00	3,00	5,00	8,9	7,1	0,80	5	50 metres	
SBR-375/M/T	06B-1	9,52	5,72	6,35	14,1	8,2	1,30	9	50 metres	
SBR-500/M/T	08B-1	12,70	7,75	8,51	18,2	11,8	1,60	18	50 metres	
SBR-625/M/T	10B-1	15,88	9,65	10,16	20,9	14,7	1,70	22,4	50 metres	
SBR-750/M/T	12B-1	19,05	11,68	12,07	24,2	16,0	1,85	29	50 metres	

*Depending on availability - Dimensions in mm

Our other products



SSB

Stainless steel bevel gear, 1:1



CMM

Male rod ends DIN ISO12240-4, Steel / bronze



AC156-157

Strike for toggle latch, 25.5mm

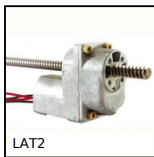

LAT2

2A motorised linear actuator, 2 amperes



PARF110

Pressed steel base rigid foot, Swivelling Ø110



HSE-HSB

Hexagonal spacer, Brass



PCLA_M

Technopolymer clamping lever - female, Plastic



BVR

Adjustable screw stop, Steel



EHD06

Internal epicyclic servo reducers, from



CLSCLP

Clevis components, short version, Steel -



BOX-TOR-H

Box set of Nitrile O-rings in nitrile, 3.00 x



CTZY

Diabolo shaped elastomount, Steel

Complementary products



SUA4_L

Chain link, Steel



SUA4_L

Chain link, Steel



PCS37K

Chain sprocket with hardened teeth, 9.525mm (DIN06B-1)



PCS50K

Chain sprocket with hardened teeth, 12.7mm (DIN08B-1)