

Shock absorber - stop collar



STC

Mounting accessory

- **Stop collar for shock absorber**
- Please note: for certain shock absorbers, the use of this stop collar is essential

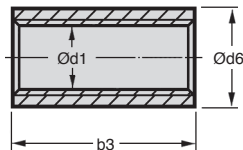

STC10 to 12

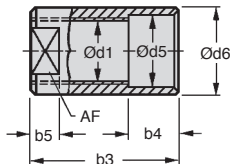

STC14 to 25



Typical application

DISCOUNTS

Qty	1+	4+	6+
Disc.	List	-10%	On request

Part number	Ød1	Ød5	Ød6	b3	b4	b5	AF	For shock-absorber	Stock*	Price each
										1 to 3
STC10	M10x1	-	14,3	20	-	-	-	MC25	✓	13,42 €
STC12	M12x1	-	16,0	20	-	-	-	MC75	✓	13,42 €
STC14	M14x1,5	14,5	18,0	19	12	6	13	MC150	-	14,57 €
STC20	M20x1,5	20,5	25,0	25	12	8	22	RMSA500	-	21,71 €
STC25	M25x1,5	25,5	32,0	45	16	10	27	RMSA600-900	✓	30,86 €

*Depending on availability - Dimensions in mm

Our other products



Driving collar, Driving collar



Angle plate for aluminium profile, Adjustable plate



Ball transfer unit push fit, Heavy



Optional shaft for E-type gear reducers, E Gearboxes double sided ou...



Lifting ring, Universal threaded



Drive sprocket for slat top chain, Range 880



Crossed helical gear crossed axis at 90°, Steel 20NCD2



Spur gear - precision range, Case hardened steel 20NCD2



Shoulder screw stainless steel 303,



Ball pin socket, Mounting collar with a



Worm and wheel set, Bronze



Actuator guide kit, Long housing

Complementary products



Adjustable shock-absorber, Adjustable



Self-compensating shock-absorber, Self-compensating - without adjust...