

- Compensates for alignment and parallelism between shaft and housing
- Allows oscillating movements at slow speeds
- Material: Self-lubricating stainless steel Uniflon®E
- Requires a P7 toleranced housing

### Advantages

- No lubrication or other maintenance required

### Uses

- Occasional heavy loads
- Areas where maintenance would be difficult



**Swiss precision**

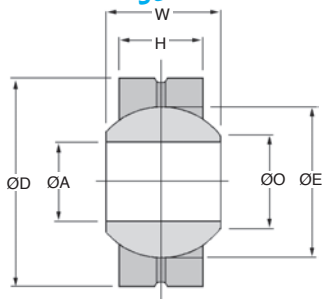

### DISCOUNTS

Qty	1+	10+	24+
Disc.	List	-20%	On request

Part number	Static radial load (daN)	Static axial load (daN)	ØA (H6)	ØD (h6)	H	ØØ	W	Sphere ØE	Weight (g)	Price each 1 to 9
SSE3.45	790	250	3	12	4,50	5,18	6	7,93	4	104,27 €
SSE5.45	1500	440	5	16	6,00	7,71	8	11,11	9	96,07 €
SSE6.45	1960	500	6	18	6,75	8,96	9	12,70	12	103,58 €
SSE8.45	3170	620	8	22	9,00	10,40	12	15,88	24	107,35 €
SSE10.45	4530	750	10	26	10,50	12,92	14	19,05	38	137,84 €
SSE12.45	6040	880	12	30	12,00	15,43	16	22,23	57	115,16 €
SSE14.45	7550	1000	14	34	13,50	16,86	19	25,40	83	195,85 €
SSE16.45	9440	1130	16	38	15,00	19,39	21	28,58	110	272,29 €
SSE18.45	11780	1250	18	42	16,50	21,89	23	31,75	150	383,99 €

Dimensions in mm

## Our other products



GCT

Pipe linch pin, Tube linch pin



BPLF

Ball transfer unit light duty, Light



NIN

Self-locking nut, Steel



BPTR\_M

End cap with threaded insert for round tube, With threaded insert



VLBG

Lifting ring, Rotating



PCLA\_T

Technopolymer clamping lever - male, Plastic

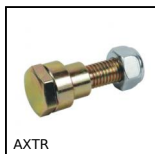

AXTR

Axle for tensioner pulley, Shaft



UCP

Cast iron pillow block bearing, Cast iron



CHM75

Worm and wheel gear reducer, up to 298



VB

Small 6 lobe threaded handle - female,

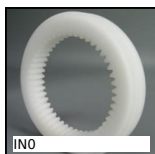

INO

Internal gear, Machined plastic



MEB

Moulded plastic bevel gear (nylon), 1:1

## Complementary products



CSSSS

Stainless steel spherical bearing, Stainless steel / PTFE