

Stainless steel 304L

Ratio
2:1
3:1
4:1

- Module 0.8 to 2.5
- Teeth Gleason
- Material:
stainless steel 304L
- Pressure angle 20°

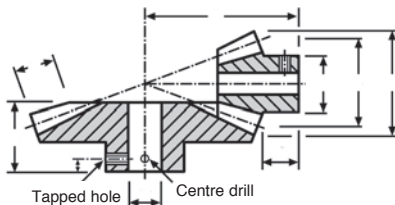

stainless steel

TORQUE AND POWER INDICATION	For 20 teeth at 1000 rpm					
	2.5 MOD	2.0 MOD	1.5 MOD	1.25 MOD	1.0 MOD	0.8 MOD
Torque (Nm)	4.30	2.20	0.94	0.71	0.57	0.14
Power (kW)	0.455	0.231	0.097	0.08	0.03	0.015

DISCOUNTS

Qty	1+	6+	20+
Disc.	List	-12%	On request

Part number	Teeth		Z	Module	ØP	E	ØD	ØA	ØM	F	G	H	Screw		Price each 1 to 5
	R	T													
SSDB0.8-15	15	0,8	12,00	20,00	13,93	6	10	11,90	7,50	4,02	M3	3,50	46,73	€	
SSDB0.8-30	30		24,00	14,00	24,64	8	20	10,08	5,50	4,02	M3	3,50	55,09	€	
SSDB1-15	15	2:1	15,00	24,00	17,42	8	14	13,87	8,76	5,03	M4	4,00	52,99	€	
SSDB1-30	30		30,00	18,00	30,58	10	25	13,11	7,00	5,03	M4	4,00	65,15	€	
SSDB1.5-15	15	1,5	22,50	35,00	26,12	10	21	19,84	12,13	7,55	M4	5,00	57,68	€	
SSDB1.5-30	30		45,00	27,00	45,87	10	30	19,66	11,00	7,55	M4	5,00	74,05	€	
SSDB2-15	15	2	30,00	45,00	34,83	12	28	24,76	14,86	10,06	M5	7,50	63,95	€	
SSDB2-30	30		60,00	35,00	61,16	12	40	25,21	14,00	10,06	M5	8,00	88,65	€	
SSDB2.5-15	15	2,5	37,50	54,00	43,54	15	32	29,51	16,51	13,53	M5	8,00	87,37	€	
SSDB2.5-30	30		75,00	41,50	76,45	15	30	29,31	13,31	13,53	M5	7,00	121,37	€	
SSTB0.8-15	15	0,8	12,00	28,00	14,14	6	10	15,63	9,67	5,69	M3	5,00			
SSTB0.8-45	45		36,00	20,00	36,30	8	28	16,07	8,00	5,69	M3	4,00			
SSTB1-15	15	3:1	15,00	32,00	17,67	8	13	16,54	9,18	7,12	M4	4,50			
SSTB1-45	45		45,00	24,00	45,37	10	40	19,09	10,00	7,12	M4	5,00			
SSTB1.5-15	15	1,5	22,50	45,00	26,51	10	18	21,80	10,51	10,67	M4	5,00			
SSTB1.5-45	45		67,50	32,00	68,06	15	50	24,63	12,00	10,67	M4	6,00			
SSFB0.8-15	15	0,8	12,00	35,00	14,23	6	10	18,07	10,58	7,10	M3	5,00			
SSFB0.8-60	60		48,00	20,00	48,22	8	30	15,98	8,00	7,10	M3	4,00			
SSFB1-15	15	4:1	15,00	45,00	17,79	8	13	24,22	14,73	9,28	M4	7,00			
SSFB1-60	60		60,00	30,00	60,27	10	40	25,08	12,00	9,28	M4	6,00			
SSFB1.5-15	15	1,5	22,50	60,00	26,69	10	18	28,82	12,08	13,91	M4	6,00			
SSFB1.5-60	60		60,00	35,00	90,41	15	50	27,61	12,00	13,91	M4	6,00			

Dimensions in mm

On request

Our other products



SSG1_304L
Stainless steel spur gear, Stainless steel 304L



V3RA_PTR
3-spoked handwheel with foldable handle, Polyamide



F7-P-AM
Multifunction display, Magnetic band



ACM_AZ
Mounting bracket for bonnet fastener, Hook



RTTss
Locking assembly, Medium/high torque



PAMF80EB
Articulated foot with sheet metal base Ø80, Articulated foot



H4
Crossed helical gear crossed axis at 90°, Steel 20NCD2



INS150
Self tapping insert with collar-coarse thread, With collar-coarse t...



HCSS
Set screw with hexagonal socket, Cup point



BZY
Cylindrical elasto mount, Steel



G-ECO
Eco range Spur gear, Steel C45



INO
Internal gear, Machined plastic (delrin)

Complementary products



DB
Steel bevel gear, 2:1



MDB_MTB
Moulded plastic bevel gear (nylon), 2:1