

Ratio 1:1

Stainless steel 303

- Module 1 to 2.5
- Pressure angle 20°
- Teeth: Gleason
- Precision JIS B 1704 : 1978 grade 3
- Material :
Stainless steel 303
- Gear hardness < 187HB
- Two gears required
to make a pair

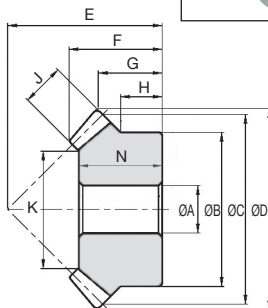

DISCOUNTS

Qty	1+	6+	10+
Disc.	List	-12%	On request

Part number	Module	Teeth		ØA	ØB	ØC	ØD	E	F	G	H	N	J	K	Weight (g)	Price each	
		Z	ØA _{H7}													1 à 5	6 à 10
SSB1-20-RA	1	20	6	16	20	21,41	20	13,95	10,71	8	12	5	9,86	0,019	42,57	€	
SSB1-25-RA		25	6	20	25	26,41	23	15,16	11,21	8	14	6	15,03	0,035	46,92	€	
SSB1-30-RA		30	8	24	30	31,41	28	17,71	13,71	10	16	6	19,03	0,057	57,50	€	
SSB1.5-20-RA	1,5	20	8	26	30	32,12	30	21,24	16,06	13	19	8	15,37	0,074	54,13	€	
SSB1.5-25-RA		25	10	30	37,5	39,62	34	22,25	16,31	11,5	19	9	19,54	0,11	67,68	€	
SSB1.5-30-RA		30	10	36	45	47,12	43	28,24	21,56	16	25	10	25,72	0,21	99,05	€	
SSB2-20-RA	2	20	12	34	40	42,83	37	24,89	18,41	14	22	10	21,72	0,15	76,49	€	
SSB2-25-RA		25	12	45	50	52,83	40	24,33	16,41	12,5	20	12	26,06	0,24	95,26	€	
SSB2-30-RA		30	12	45	60	62,83	50	29,43	21,41	12,5	25	12	36,06	0,37	138,61	€	
SSB2.5-20-RA	2,5	20	14	42	50	53,54	48	32,54	24,77	19	29	12	28,06	0,30	108,65	€	
SSB2.5-25-RA		25	16	55	62,5	66,04	50	30,41	20,52	15	26	15	34,57	0,46	145,19	€	
SSB2.5-30-RA		30	16	60	75	78,54	62	36,28	26,27	17	32	15	47,57	0,76	212,52	€	

Dimensions in mm

Stainless steel 303

Ratio

1,5:1 2:1 3:1

- Module 1 to 2.5
- Pressure angle 20°
- Teeth: Gleason
- Precision JIS B 1704 : 1978 grade 3
- Material :
- Stainless steel 303
- Gear hardness < 187HB
- Two gears required to make a pair



stainless
steel

DISCOUNTS

Qty	1+	6+	10+
Disc.	List	-12%	On request

Part number	Module	Teeth		ØA	ØB	ØC	ØD	E	F	G	H	N	J	K	Weight (g)	Price each 1 à 5
		Z	H7													
Ratio 1,5:1																
SSHB1.5-20-RA	1,5	20	8	25	30	33,13	33	18,63	11,54	8,83	17	9	17,05	0,063	55,11	€
SSHB1.5-30-RA		30	10	30	45	46,24	28	18,53	13,93	8	16	9	27,37	0,120	84,88	€
SSHB2-20-RA	2	20	10	35	40	44,18	45	25,06	16,39	13,33	22	11	21,34	0,160	82,29	€
SSHB2-30-RA		30	10	35	60	61,65	40	26,87	21,24	15	23	11	37,56	0,260	129,60	€
SSHB2.5-20-RA	2,5	20	12	40	50	55,22	55	31,06	19,24	14,16	28	15	27,42	0,280	118,05	€
SSHB2.5-30-RA		30	15	45	75	77,07	50	34,22	26,55	18	30	15	45,61	0,540	194,93	€
Ratio 2:1																
SSDB1.5-20-RA	1,5	20	8	25	30	33,61	46	25,54	16,9	14,75	24	10	17,28	0,088	62,51	€
SSDB1.5-40-RA		40	10	38	60	60,88	35	25,01	20,88	15	22	10	39,64	0,270	132,03	€
SSDB2-20-RA	2	20	12	32	40	44,81	60	34,16	21,2	18	32	15	20,92	0,190	92,67	€
SSDB2-40-RA		40	12	50	80	81,17	45	32,37	26,17	18	27	15	48,46	0,610	214,91	€
SSDB2.5-20-RA	2,5	20	12	40	50	56,01	75	43,78	26,5	22,5	41	20	24,56	0,400	144,01	€
SSDB2.5-40-RA		40	15	60	100	101,46	55	39,73	31,46	20	35	20	60,28	1,210	352,53	€

Dimensions in mm

Ratio
1,5:1
2:1
3:1

Stainless steel 303

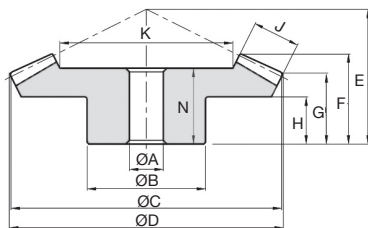
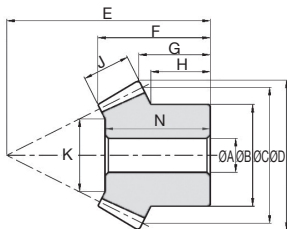

DISCOUNTS

Qty	1+	6+	10+
Disc.	List	-12%	On request

Part number	Module	Teeth		ØA	ØB	ØC	ØD	E	F	G	H	N	J	K	Weight (g)	Price each 1 à 5
		Z	H7													
Ratio 3:1																
SSTB1.5-15-RA	1.5	15	8	18	22,5	26,54	47	23,19	13,92	12,5	22,5	10	14,75	0,041	43,94 €	
SSTB1.5-45-RA		45	10	36	67,5	68,06	28	20,44	17,59	11	17	10	46,58	0,250	143,59 €	
SSTB2-15-RA	2	15	10	24	30	35,35	60	29,8	15,89	14	29	15	19,13	0,095	63,69 €	
SSTB2-45-RA		45	12	60	90	90,75	40	30,4	26,12	17	26	15	59,04	0,800	243,88 €	
SSTB2.5-15-RA	2.5	15	12	30	37,5	44,18	75	38,41	19,86	17,5	37	20	20,51	0,190	90,28 €	
SSTB2.5-45-RA		45	15	60	112,5	113,43	50	38,35	32,65	22	35	20	72,84	1,360	406,27 €	

Dimensions in mm

Our other products



EKN

Bellows coupling Gerwah®, from 0.5 to 12Nm



BTESS

Universal stainless steel arm for tensioner, For use in hostile envi...



GAL22

Conveyor wheel, Zinc plated steel



E60

Right angle helical reducers, from 4.50 to 62 Nm

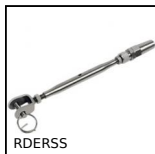

RDERSS

Stainless steel manual rigging screw, Stainless steel - manual



PITAss

Locking bolt, with T handle



AT5courroie

AT type timing belt, AT5 Steel cored polyurethane



PTA100ssEB

Articulated foot with sheet metal base Ø100, Articulated foot

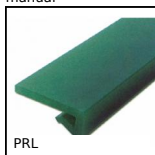

PRL

Wear strip for slat top chain, L profile to be



EHD06

Internal epicyclic servo reducers, from



PTRSS

Idle chain sprocket, For hostile



SH1

Parallel axis helical gear, Steel 20NCD2

Complementary products



ZBRA

Machined plastic bevel gear, 1:1



ZHBRA

Plastic bevel gear, 1,25:1 2:1 3:1