

Adjustable latch clamp with catch plate **SteSta**

SRG20 Span adjustable from 77.3 to 83mm

- Adjustable latch clamp with cath-plate

- Materials:

- Chromed steel
- Non treated 304 stainless steel

Application

- Clamping system for industrial applications
- Fold down the handle after attaching the hook
- Span is adjusted by turning the hook

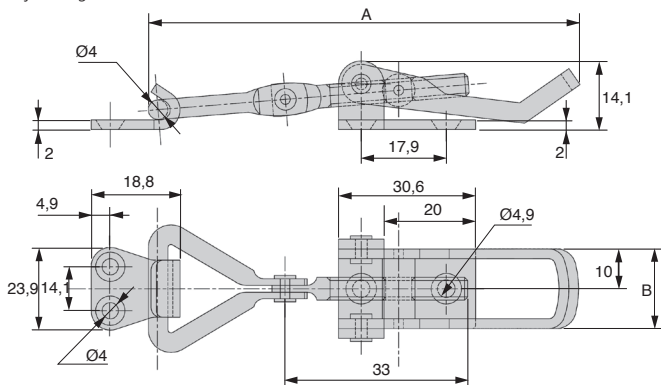

DISCOUNTS

Qty	1+	10+	20+	50+
Disc.	List	-3%	-5%	On request

Part number	A	B	Material	Finish	Weight(g)	Stock*	Price each 1 to 9
SRG40-117-128	117,4 to 128	40,6	Steel	Galvanised	130	✓	8,03 €
SRG40-117-128/SS	117,4 to 128	40,6	S-Steel 304	Natural	130	✓	26,32 €

*Subject to availability - Dimensions in mm

SteSta Adjustable latch clamp with catch plate

Span adjustable from 96 to 121.7mm SRG25

- Adjustable latch clamp with catch-plate

- Materials:
Chromed steel
Non treated 304
stainless steel

Application

- Clamping system for industrial applications
- Fold down the handle after attaching the hook
- Span is adjusted by turning the hook

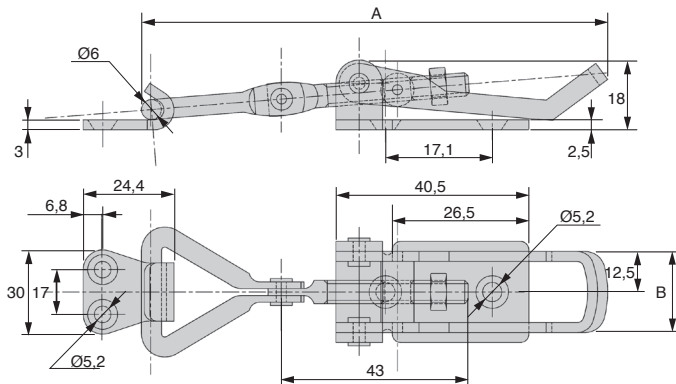

DISCOUNTS

Qty	1+	10+	20+	50+
Disc. List	-3%	-5%	On request	

Part number	X	A	B	Material	Finish	Weight(g)	Stock*	Price each 1 to 9
SRG52-78-90	78 to 90	67	52	Steel	Galvanised	100	✓	15,11 €
SRG52-78-90/SS	78 to 90	67	52	S-Steel 304	Natural	100	✓	29,53 €

*Subject to availability - Dimensions in mm

Adjustable latch clamp with catch plate **Ste|Sta**

SRG40 Span adjustable from 117.4 to 128mm

- Adjustable latch clamp with catch-plate

- Materials:

- Chromed steel
- Non treated 304 stainless steel

Application

- Clamping system for industrial applications
- Fold down the handle after attaching the hook
- Span is adjusted by turning the hook

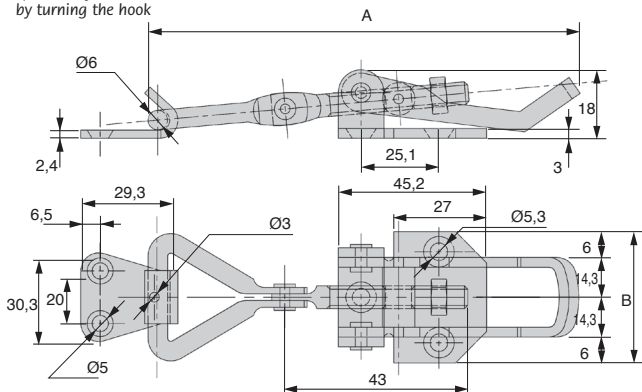

DISCOUNTS

Qty	1+	10+	20+	50+
Disc.	List	-3%	-5%	On request

Part number	A	B	Material	Finish	Weight(g)	Stock*	Price each 1 to 9
SRG40-117-128	117,4 to 128	40,6	Steel	Galvanised	130	✓	8,03 €
SRG40-117-128/SS	117,4 to 128	40,6	S-Steel 304	Natural	130	✓	26,32 €

*Subject to availability - Dimensions in mm

SteSta Adjustable latch clamp with catch plate

Span adjustable from 78 to 90mm **SRG52**

- Adjustable latch clamp with catch-plate

- Materials:
 - Chromed steel
 - Non treated 304 stainless steel

Application

- Clamping system for industrial applications
- Fold down the handle after attaching the hook
- Span is adjusted by turning the hook

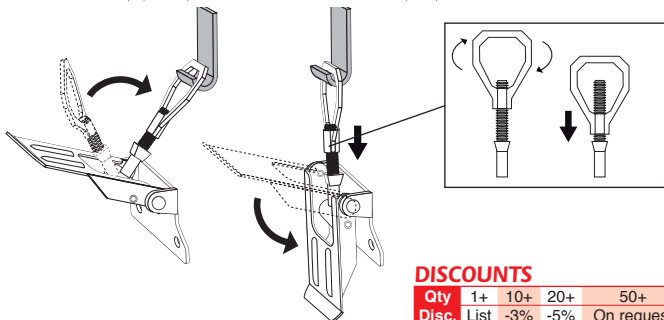
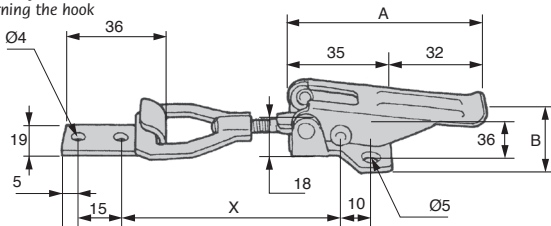

DISCOUNTS

Qty	1+	10+	20+	50+
Disc. List	-3%	-5%	On request	On request

Part number	X	A	B	Material	Finish	Weight(g)	Stock*	Price each 1 to 9
SRG52-78-90	78 to 90	67	52	Steel	Galvanised	100	✓	15,11 €
SRG52-78-90/SS	78 to 90	67	52	S-Steel 304	Natural	100	✓	29,53 €

*Subject to availability - Dimensions in mm

Our other products



HRV

V-rail guidance
Simple Select®
system, Rail with
carriage



RFK48B

Hypoid gearbox -
Stainless steel, up to
350 Nm



PTAF80-PAMF80

Articulated fixable
foot with pressed
base Ø80, Ø 80



BPM-Z

Plastic slotted spring
plunger with ball tip,
Plastic body +
plastic...



ACL-PLAngle

Joining plate for
aluminium profile,
Angle connection



UGH50

H Type Guide units,
For Ø50 actuators



CNA-CNG

Right angled
mounting plate, Right
angled mounting
plate for ball jo...



SDC

Positioning sleeve for
indexing pin, For pin
Ø4 to Ø12



FBL6000_K13

Brush strip per meter
PP fibres Ø0.2, Black
striated polypropylene
...



GBMz

Cylindrical ballscrew
nut, Cylindrical nut -
Multiple starts



HTD8M_30

HTD Heavy duty
timing pulley, HTD8
Cast



DOMI80

Domino 80 adjustable
slide, Slide DOMILINE
80 with counter and
handw...

Complementary products



SRG

Adjustable latch
clamp with strike
plate, Stroke from
96mm to 121,7mm



SRG

Adjustable latch
clamp with strike
plate, Stroke from
117,4mm to 128mm



GEC

Rubber latch clamp
with strike plate,
Lockable



GAC

Latch clamp with lock,
Lockable