

# Drylin® bearing block for leadscrew Stock

## SLS

## Easy to install

- Bearing block to support LFM102, LFM184 and LFM245 leadscrews
- No lubrication or maintenance required
- Low friction
- Precise, no backlash
- Materials :
  - Anodised aluminium
  - Drylin® coating
  - Steel locking collar (on fixed bearing)

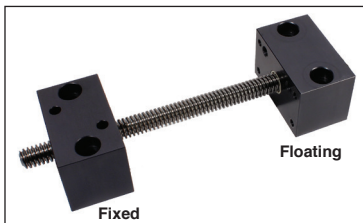

### Application

- Linear slide tables

### Assembly

It is necessary to machine the end of the screw (diam d1), for SLS184 and SLS245

#### Fixed bearing

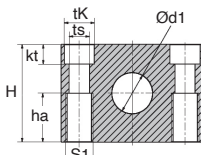
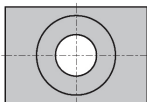
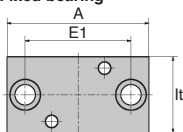

#### Moving bearing

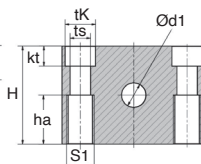
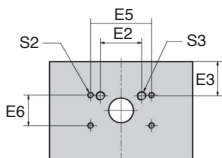
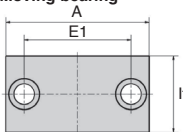

### DISCOUNTS

Qty	1+	5+	10+
Disc.	List	-5%	On request

Part number	For leadscrew	A	H	E1	E2	E3	E5	E6	It	kt	tk	ts	d1	ha	S1	S2	S3	Weight (g)	Price each 1 to 4
<b>Floating bearing block</b>																			
SLS102-LL	Tr10x2	50	32	36	27	6,5	40	20	30	6,5	11	6,6	10	16	M8	M4	M6	115	62,61 €
SLS184-LL	Tr18x4	72	46	54	27	13,5	40	20	36	8,6	15	9,0	12	23	M10	M4	M6	295	87,01 €
SLS245-LL	Tr24x5	94	64	70	27	22,5	40	20	50	13,0	20	13,5	14	32	M16	M4	M6	725	129,24 €
<b>Fixed bearing block</b>																			
SLS102-FL	Tr10x2	50	32	36	-	-	-	-	30	6,5	11	6,6	10	16	M8	-	-	88	104,76 €
SLS184-FL	Tr18x4	72	46	54	-	-	-	-	36	8,6	15	9,0	12	23	M10	-	-	205	147,07 €
SLS245-FL	Tr24x5	94	64	70	-	-	-	-	50	13,0	20	13,5	14	32	M16	-	-	525	271,13 €

\*Depending on availability - Dimensions in mm

## Our other products



GAC

Latch clamp with lock,  
Lockable



PCS50

Chain sprocket - steel,  
12.7mm (DIN08B-1)



NT92

Spur gear coaxial  
gearbox, from 15 to  
40 Nm - Inline



SCA\_SS

Stainless steel flat  
cable clamp, Stainless  
steel



PTA100ssEB

Articulated foot with  
sheet metal base  
Ø100, Articulated foot



DGSA

Male rod ends , Steel /  
steel - Economy range



CHA135

Screwed hinge, 135  
degrees



VRC1

Retaining clamp,  
single sided, Single  
sided



METC

Flanged sintered  
bronze bush, Self-  
lubricating sintered



GAL\_42

Guide roller for plate  
chain return, Without  
ball bearing



DOMI120

Connecting kits, XZ  
linking kit

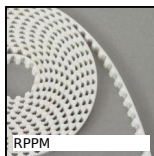

RPPM

RPP type belt per  
metre, RPP8 Steel  
cored polyurethane

## Complementary products



LFM

Steel leadscrew,  
Medium carbon steel -  
1 thread

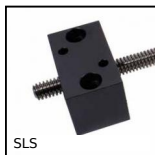

SLS

Bearing block for  
leadscrew, Fixed  
Drylin® bearing block

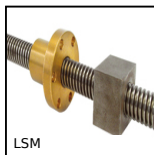

LSM

Stainless steel 316L  
leadscrew, Stainless  
steel - 1 thread