

Horizontal toggle clamp

SLHHLOK

With **locking mechanism**

High quality swivel bush with horizontal foot and adjustable spindle

Constant level of force during both opening and closing

Increased stability thanks to U-shaped clamping arm
Fitted with automatic locking mechanism

- Materials :

Nitro carburised steel with blackened finish

Polyamide handle

Locking mechanism TPE



Horizontal base

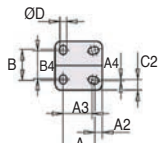
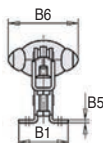
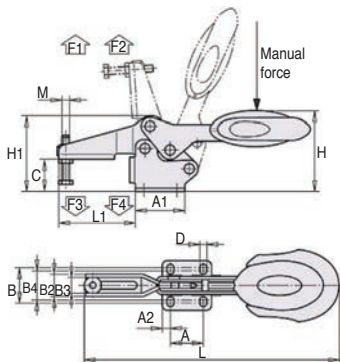

Hole positions

DISCOUNTS

Qty	1+	6+	15+	20+
Disc.	List	-5%	-10%	On request

Part number	Opening angle		Manual force N	Holding force		Clamping force		H	H1	L	L1
	Holding arm	Handle		F1 (N)	F2 (N)	F3 (N)	F4 (N)				
SLHH-6/LOK	87°	68°	160	1350	1900	720	1200	63,3	59,5	193,3	60,5
SLHH-8/LOK	86°	66°	200	2000	2800	830	1400	73,9	70	230,3	74,9
SLHH-10/LOK	90°	71°	250	2200	4500	1200	2800	94,8	87,9	286	103,9
SLHH-12/LOK	88°	68°	280	2400	5500	1000	2800	104,9	101,6	321,3	122

Part number	M	A	A1	A2	A3	A4	B	B1	B2	B3	B4	B5	B6	C	C2	ØD	Price each
																	1 to 5
SLHH-6/LOK	M6x35	26	39	6,5	-	-	28	39	17,5	12,4	24,6	53,4	53,4	25,5	-	5,5	51,38 €
SLHH-8/LOK	M8x45	26	44	9	-	-	31	45	21	15,7	26,1	51,1	51,1	32,2	-	6,2	52,31 €
SLHH-10/LOK	M10x55	41,5	59	9	-	-	43	59	26	18,7	39	56,5	56,5	40	-	8,8	75,52 €
SLHH-12/LOK	M12x70	44	65	10	40	1	42	67	28	20,9	40	56,5	56,5	52,3	13,5	8,5	78,77 €

Dimensions in mm

Our other products



M2

Worm and wheel set,
Unhardened steel



IN1

Internal gear, Steel
20NCD2



DOMI120

Accessories, Plate



LACT_SS

Adjustable Stainless
steel cam lever, Male



BUT

Panel stop, Panel stop



PSG08

Spur gear - precision
range, Case hardened
steel 20NCD2



DB

Steel bevel gear, 2:1



HTD5M_09

HTD Heavy duty
timing pulley, HTD5
Steel

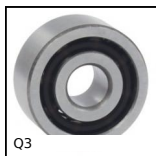

Q3

Double row angular
contact ball bearing,



CHAC4040NP

Square hinge with
riveted pin, not



RTTss

Locking assembly,
Medium/high torque



GMC_GMK_BR

Guiding profile clamp,
Flat or rounded

Complementary products



SLH-M

Nut for toggle clamp,
Round ended nut for
SLH/SLV clamp



SLH

Horizontal toggle
clamp, Horizontal
Lever Clamp - steel