

- Locating bolt for manual indexing applications
- Exists in 4 versions
- Material:
 - Body: Stainless steel 303
 - Pin: Hardened stainless steel 420
- Finish:
 - Ground and blackened
 - Mushroom headed button: Electropolished finish

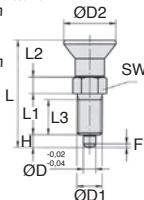

Info.

- These locating bolts can be used to restrict lateral movement. Raising the button releases the pin

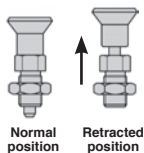

Form A
Without slot,
without lock
nut



Form B
Without slot,
with lock nut

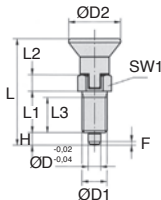

Form C
With slot,
without lock nut

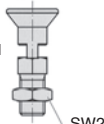

Form D
With slot,
with lock nut

DISCOUNTS

Qty	1+	6+	20+
Disc.	List	-10%	On request

Part number	ØD	ØD1	ØD2	L	L1	L2	L3	H	SW1	SW2	Spring strength				Price each 1 to 5
											F x 30°	initial (N)	final (N)	Stock	
SLBS8-A	4	M8 x 1,0	18	43,0	15	6	13	4	10	13	1,0	6	12	✓	20,50 €
SLBS8-B	4	M8 x 1,0	18	43,0	15	6	13	4	10	13	1,0	6	12	✓	22,58 €
SLBS8-C	4	M8 x 1,0	18	38,5	15	6	13	4	10	13	1,0	6	12	✓	24,63 €
SLBS8-D	4	M8 x 1,0	18	38,5	15	6	13	4	10	13	1,0	6	12	✓	27,00 €
SLBS10-A	5	M10 x 1,0	21	50,0	17	7	15	5	13	17	1,3	5	12	✓	19,50 €
SLBS10-B	5	M10 x 1,0	21	50,0	17	7	15	5	13	17	1,3	5	12	✓	21,57 €
SLBS10-C	5	M10 x 1,0	21	43,5	17	7	15	5	13	17	1,3	5	12	-	23,49 €
SLBS10-D	5	M10 x 1,0	21	43,5	17	7	15	5	13	17	1,3	5	12	✓	25,70 €
SLBS12-A	6	M12 x 1,5	25	59,0	20	8	17	6	14	19	1,8	6	14	✓	23,03 €
SLBS12-B	6	M12 x 1,5	25	59,0	20	8	17	6	14	19	1,8	6	14	✓	25,30 €
SLBS12-C	6	M12 x 1,5	25	52,0	20	8	17	6	14	19	1,8	6	14	✓	27,77 €
SLBS12-D	6	M12 x 1,5	25	52,0	20	8	17	6	14	19	1,8	6	14	✓	30,32 €
SLBS16-A	8	M16 x 1,5	33	77,0	26	10	23	8	19	24	2,3	15	35	✓	30,55 €
SLBS16-B	8	M16 x 1,5	33	77,0	26	10	23	8	19	24	2,3	15	35	✓	33,79 €
SLBS16-C	8	M16 x 1,5	33	68,0	26	10	23	8	19	24	2,3	15	35	✓	37,73 €
SLBS16-D	8	M16 x 1,5	33	68,0	26	10	23	8	19	24	2,3	15	35	✓	41,32 €
SLBS20-A	10	M20 x 1,5	33	83,0	28	12	25	10	22	30	2,6	15	40	-	52,20 €
SLBS20-B	10	M20 x 1,5	33	83,0	28	12	25	10	22	30	2,6	15	40	✓	55,88 €
SLBS20-C	10	M20 x 1,5	33	74,0	28	12	25	10	22	30	2,6	15	40	-	72,70 €
SLBS20-D	10	M20 x 1,5	33	74,0	28	12	25	10	22	30	2,6	15	40	✓	76,57 €

*Depending on availability - Dimensions in mm

Our other products



BOX-TOR-H

Box set of Nitrile O-rings in nitrile, 3.00 x 2.00mm to 45.20 x 4.00



DKONSL

Silicone conical elasto buffer, Male mounting



GSI

Stainless steel gas spring, Stainless steel

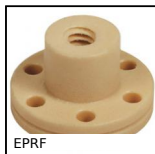

EPRF

High helix leadscrew, Flanged nut - up to 40mm per rotation



SLVHlok

Vertical toggle clamp, Vertical toggle clamp / horizontal foot



BPM-Z

Plastic slotted spring plunger with ball tip, Plastic body + plastic...

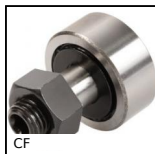

CF

Cam follower, Standard - steel



F7-SF-SM

Multifunction display, Mounting bracket for front mounting



SH0

Parallel axis helical gear, Steel 20NCD2



PMC150_M16

Anti-vibration machine mount, Square base plate



RHTplss

High Temperature Castor, up to 200kg



WJRM

Drylin® W hybrid bearing block, Hybrid bearings

Complementary products



SLBE

Indexing plunger - Spacer, Spacer for SLB and SLBS index bolts



SDC

Positioning sleeve for indexing pin, For pin Ø4 to Ø12



SDCcs

Positioning sleeve for indexing pin, For pin Ø4 to Ø12



PITAss

Locking bolt, with T handle