

1 trapezoidal right or left-hand thread SKM SKMLH

- Right or left-hand thread
- Thread conforms to NFE 03.616
- Material: Steel 115MnPb37
- Machined nut
- Thread tolerance: 7H

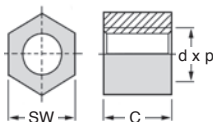

Accessories

- LFM steel leadscrew or LSM stainless steel leadscrew

DISCOUNTS A

Qty	1+	10+	20+	40+
Disc.	List -30%	-40%	On request	

DISCOUNTS B

Qty	1+	5+	10+
Disc.	List -5%	On request	

Part number	Ød	Pitch P	SW	C	Weight (kg)	Stock*	Price each	
							1 to 9	40 to 59**
Right-hand thread								
SKM102	10	2	17	15	0,022	✓	A 3,37 €	A 2,02 €
SKM123	12	3	19	18	0,032	✓	A 3,80 €	A 2,27 €
SKM143	14	3	22	21	0,049	✓	A 5,21 €	A 3,13 €
SKM164	16	4	24	24	0,065	✓	A 6,54 €	A 3,92 €
SKM184	18	4	27	27	0,091	✓	A 6,95 €	A 4,17 €
SKM204	20	4	30	30	0,124	✓	A 8,02 €	A 4,81 €
SKM225	22	5	30	33	0,125	✓	A 8,72 €	A 5,23 €
SKM245	24	5	36	36	0,219	✓	A 9,98 €	A 5,99 €
SKM285	28	5	41	42	0,318	✓	A 12,79 €	A 7,67 €
SKM306	30	6	46	45	0,445	✓	A 14,88 €	A 8,93 €
SKM326	32	6	50	48	0,567	✓	A 18,22 €	A 10,93 €
SKM366	36	6	55	54	0,708	✓	B 15,93 €	B On request
SKM407	40	7	60	60	0,893	✓	B 21,05 €	B On request
SKM447	44	7	65	66	1,538	-	B 34,36 €	B On request
SKM508	50	8	75	75	1,889	✓	B 69,02 €	B On request
SKM609	60	9	90	90	3,277	-	B 98,06 €	B On request
Left-hand thread								
SKM102/LH	10	2	17	15	0,022	-	A 5,68 €	A 3,41 €
SKM123/LH	12	3	19	18	0,032	-	A 6,78 €	A 4,07 €
SKM143/LH	14	3	22	21	0,049	-	A 6,78 €	A 4,07 €
SKM164/LH	16	4	24	24	0,065	-	A 8,19 €	A 4,91 €
SKM184/LH	18	4	27	27	0,091	-	A 8,53 €	A 5,12 €
SKM204/LH	20	4	30	30	0,124	-	A 9,77 €	A 5,87 €
SKM225/LH	22	5	30	33	0,125	-	A 10,94 €	A 6,57 €
SKM245/LH	24	5	36	36	0,219	-	A 12,39 €	A 7,44 €
SKM285/LH	28	5	41	42	0,318	-	A 15,02 €	A 9,01 €
SKM306/LH	30	6	46	45	0,445	-	A 18,67 €	A 11,20 €
SKM326/LH	32	6	50	48	0,567	-	A 21,76 €	A 13,05 €
SKM366/LH	36	6	55	54	0,708	-	B 18,16 €	B On request
SKM407/LH	40	7	60	60	0,893	-	B 25,43 €	B On request
SKM447/LH	44	7	65	66	1,538	-	B 38,09 €	B On request
SKM508/LH	50	8	75	75	1,889	-	B 17,50 €	B On request
SKM609/LH	60	9	90	90	3,277	-	B 38,00 €	B On request

*Depending on availability - Dimensions in mm

** refer to discounts

Our other products



Shock Absorber - stop collar, Universal flange



Worm - precision range, Steel



Toggle latches, Miniature



Panamech, Multi-Beam stainless steel, Stainless steel - with clampin...

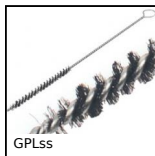

Brush, stainless steel



Extension spring in metre length stainless steel, by the metre



Box set of Nitrile O-rings in nitrile, 3.00 x 2.00mm to 45.20 x 4.00



Eco range Spur gear, Steel C45



Swivel castor with central hole,



Double needle roller universal joint, Heavy

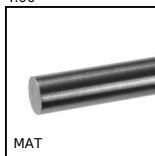

Drawn ground round bar, 100C6 steel bar



Flanged drill bushing, Steel

Complementary products



Steel leadscrew, Medium carbon steel - 1 thread

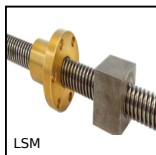

Stainless steel 316L leadscrew, Stainless steel - 1 thread



Steel leadscrew, Medium carbon steel - 1 thread

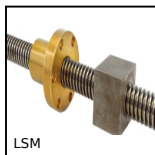

Stainless steel 316L leadscrew, Stainless steel - 1 thread