

- Plastic construction
- Light weight
- Low cost version
- Corrosion resistant
- Available in 2 sizes
- Supplied without handle

**Economical**

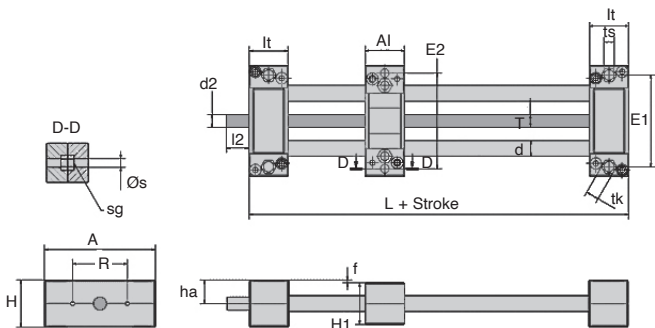
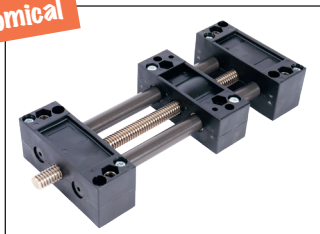

Part number	A	AI	H	E1	E2	L	R	f	lt	tk	ts
SHTP-01-06	45	45	19	38	36,5	67	25	1	11	8	4,2
SHTP-01-12	85	30	36	70	73,0	90	42	2	30	10	6,6
SHTP-02-12	85	30	36	70	73,0	90	42	2	30	10	6,6

Part number	s	sg	d	T	l2	d2 <sup>+</sup> standard	ha	H1
SHTP-01-06	5,0	-	6	M8	15	M8	9	18
SHTP-01-12	6,3	M6	12	TR10x2	17	TR10x2	16	32
SHTP-02-12	6,3	M6	12	TR10x2	17	TR10x2	16	32

Dimensions in mm

## DISCOUNTS

Qty	1+	2+	3+
Disc.	List	-10%	On request

Part number	Max stroke (mm)	Aluminium profile		Notes
		Weight (kg)	Add weight (/0.1m stroke)	
SHTP-01-06	300	0,11	0,06	Square carriage with 4 symmetrical mounting holes
SHTP-01-12	750	0,35	0,11	Smooth guides and nuts in iglidur®J
SHTP-02-12	750	0,35	0,11	-

Part number	Stroke (mm)	Stock*	Price each
SHTP-01-06-100	100	✓	106,40 €
SHTP-01-06-250	250	✓	133,95 €
SHTP-01-12-100	100	✓	147,83 €
SHTP-01-12-250	250	✓	184,79 €
SHTP-01-12-500	500	-	221,27 €
SHTP-02-12-100	100	✓	112,31 €
SHTP-02-12-250	250	✓	139,87 €
SHTP-02-12-500	500	-	185,77 €

Dimensions in mm



Maintenance free

### Materials:

- Shaft: hard anodised aluminium
- Leadscrew: Steel C15
- Smooth bearings and films: Iglidur® J
- Nut: Iglidur® W300

### Advantages

- Requires absolutely no maintenance
- No corrosion
- Very light
- Nut for trapezoidal screw manufactured from high performance polymers
- Cross pieces and slides manufactured from anodised aluminium

### Options

- SHTC12 max. stroke 1000mm
- SHTC20 and SHTC30 max. stroke 2000mm

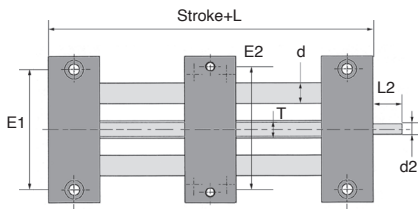
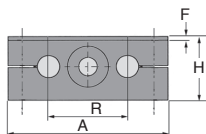
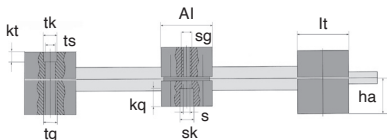

Part number	A -0,3	Al -0,3	H	E1 ±0,15	E2 ±0,15	L	R	F	It	tk	ts	tg
SHTC-12	85	30	34	70	73	90	42	2	30	11	6,6	M8
SHTC-20	130	36	48	108	115	108	72	2	36	15	9,0	M10
SHTC-30	180	50	68	150	158	150	96	4	50	20	13,5	M16

Part number	kt	S	sk	sg	kq	d	T	L2	d2 (h9)	ha
SHTC-12	6,4	6,3	10	M6	6,0	12	TR10x2	17	TR10x2*	18
SHTC-20	8,6	6,4	11	M8	7,0	20	TR18x4	26	12	23
SHTC-30	12,6	11,0	18	M12	10,6	30	TR24x5	38	14	36

\*TR10x2 supplied with a non machined spindle end - Dimensions in mm

CHC socket screw

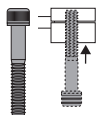

CHC socket screw

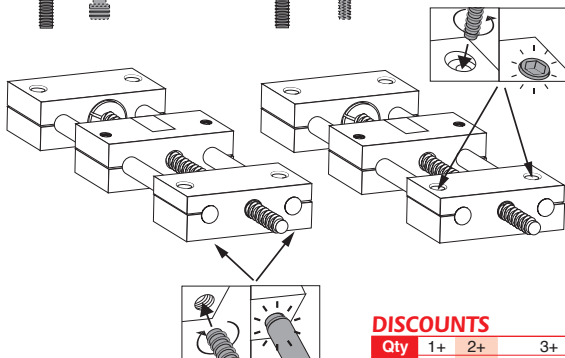
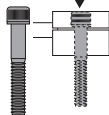

## DISCOUNTS

Qty	1+	2+	3+
Disc.	List	-10%	On request

Part number	Max. axial load			Radial load	
	Static (N)	Dynamic (MPaxm/s) axial bearing	Dynamic (MPaxm/s) trapezoidal nut	Static (N)	Dynamic (N)
SHTC-12	700	0,23	0,08	1400	1000
SHTC-20	1600	0,23	0,08	3200	3000
SHTC-30	2500	0,23	0,08	5000	5000

Part number	Max. speed		Stroke length (mm)	Price each
	Of screw (rpm)	Of travel (m/min)		
SHTC-12-100	500	1,0	100	289,56 €
SHTC-12-250	500	1,0	250	316,85 €
SHTC-12-500	500	1,0	500	362,36 €
SHTC-20-100	300	1,2	100	413,67 €
SHTC-20-250	300	1,2	250	447,79 €
SHTC-20-500	300	1,2	500	504,68 €
SHTC-20-1000	300	1,2	1000	618,45 €
SHTC-30-100	220	1,1	100	661,88 €
SHTC-30-250	220	1,1	250	709,74 €
SHTC-30-500	220	1,1	500	789,49 €
SHTC-30-1000	220	1,1	1000	948,99 €

# DryLin<sup>®</sup> linear table

## Construction and characteristics

DryLin<sup>®</sup> linear tables are suitable for many different positioning applications. The linear positioning is achieved by means of a trapezoidal leadscrew that can be operated manually or by motor.

The maximum linear speed is 1 m/min.

The suitability of a linear slide unit for an application can be checked using the graphs below.

The following trapezoidal leadscrew drive sizes are used in this range of linear tables:

- TR 10x2: SHT-12, SHTC-12, SHTP-12, SLW-1040

- TR 18x4: SHT-20, SHTC-20, SLW-2080

- TR 24x5: SHT-30, SHTC-30

Please note that the loads given are axial loads. Radial loads are not given for trapezoidal leadscrews. For horizontal mounting with symmetrical loads, the following equation can be used:

$F_{axial} = F_{radial} \times 0.25$  (for horizontal mounting)

Max. feed [m/min]

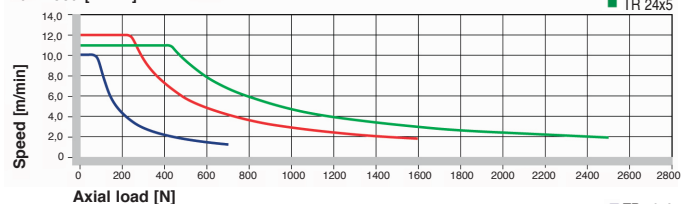

Maximum leadscrew rotation speed [rpm]

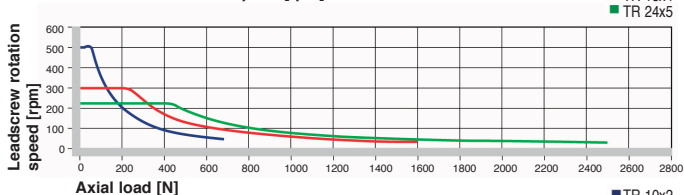

Drive torque [Nm]

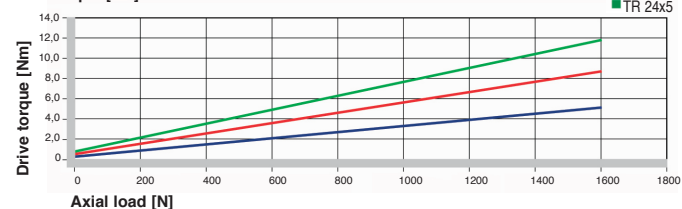

## Our other products



H3

Crossed helical gear  
crossed axis at 90°,  
Steel 20NCD2



NCT

Square tube  
connector, Fixed  
angle

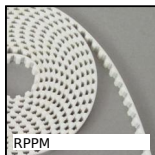

RPPM

RPP type belt per  
metre, RPP5 Steel  
cored polyurethane



PW\_PWG05

Worm - precision  
range, Steel



DZYSS

Stainless steel  
cylindrical stop,  
stainless steel



BSM

Spring plunger with  
internal hexagonal  
socket, steel body,  
plastic pin



PM3

Worm and wheel set,  
Hardened steel



LC

Friction clutch, 30 to  
240 Nm



BTE

Universal tension arm,  
For standard  
applications

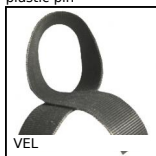

VEL

Self-gripping cable  
strip, electric and  
pneumatic cables



DB\_ECO

Eco. range steel bevel  
gear, 2:1



CHMBR

Reaction arm, CHM  
and CHMR gear  
reducers reaction arm

## Complementary products



SHTC

Drylin® Linear table,  
Maintenance free