



Maintenance free

- Materials:

- Shaft: hard anodised aluminium
- Leadscrew: Steel C15
- Smooth bearings and films: Iglidur® J
- Nut: Iglidur® W300

Advantages

- Requires absolutely no maintenance
- No corrosion
- Very light
- Nut for trapezoidal screw manufactured from high performance polymers
- Cross pieces and slides manufactured from anodised aluminium

Options

- SHTC12 max. stroke 1000mm
- SHTC20 and SHTC30 max. stroke 2000mm

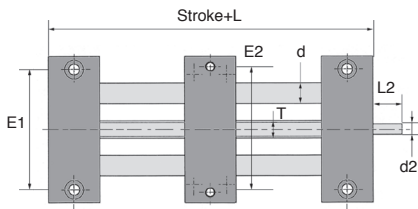
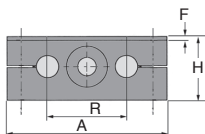
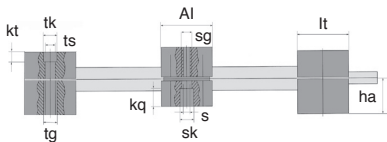

| Part number | A -0,3 | Al -0,3 | H | E1 ±0,15 | E2 ±0,15 | L | R | F | It | tk | ts | tg |
|-------------|-----------|------------|----|-------------|-------------|-----|----|---|----|----|------|-----|
| SHTC-12 | 85 | 30 | 34 | 70 | 73 | 90 | 42 | 2 | 30 | 11 | 6,6 | M8 |
| SHTC-20 | 130 | 36 | 48 | 108 | 115 | 108 | 72 | 2 | 36 | 15 | 9,0 | M10 |
| SHTC-30 | 180 | 50 | 68 | 150 | 158 | 150 | 96 | 4 | 50 | 20 | 13,5 | M16 |

| Part number | kt | S | sk | sg | kq | d | T | L2 | d2 (h9) | ha |
|-------------|------|------|----|-----|------|----|--------|----|------------|----|
| SHTC-12 | 6,4 | 6,3 | 10 | M6 | 6,0 | 12 | TR10x2 | 17 | TR10x2* | 18 |
| SHTC-20 | 8,6 | 6,4 | 11 | M8 | 7,0 | 20 | TR18x4 | 26 | 12 | 23 |
| SHTC-30 | 12,6 | 11,0 | 18 | M12 | 10,6 | 30 | TR24x5 | 38 | 14 | 36 |

*TR10x2 supplied with a non machined spindle end - Dimensions in mm

CHC socket screw

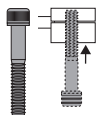

CHC socket screw

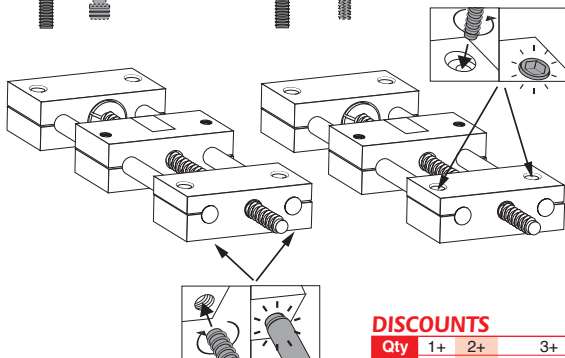
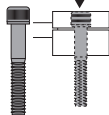

DISCOUNTS

| Qty | 1+ | 2+ | 3+ |
|-------|------|------|------------|
| Disc. | List | -10% | On request |

| Part number | Max. axial load | | | Radial load | |
|-------------|-----------------|---------------------------------|-----------------------------------|-------------|-------------|
| | Static (N) | Dynamic (MPaxm/s) axial bearing | Dynamic (MPaxm/s) trapezoidal nut | Static (N) | Dynamic (N) |
| SHTC-12 | 700 | 0,23 | 0,08 | 1400 | 1000 |
| SHTC-20 | 1600 | 0,23 | 0,08 | 3200 | 3000 |
| SHTC-30 | 2500 | 0,23 | 0,08 | 5000 | 5000 |

| Part number | Max. speed | | Stroke length (mm) | Price each |
|--------------|----------------|-------------------|--------------------|------------|
| | Of screw (rpm) | Of travel (m/min) | | |
| SHTC-12-100 | 500 | 1,0 | 100 | 289,56 € |
| SHTC-12-250 | 500 | 1,0 | 250 | 316,85 € |
| SHTC-12-500 | 500 | 1,0 | 500 | 362,36 € |
| SHTC-20-100 | 300 | 1,2 | 100 | 413,67 € |
| SHTC-20-250 | 300 | 1,2 | 250 | 447,79 € |
| SHTC-20-500 | 300 | 1,2 | 500 | 504,68 € |
| SHTC-20-1000 | 300 | 1,2 | 1000 | 618,45 € |
| SHTC-30-100 | 220 | 1,1 | 100 | 661,88 € |
| SHTC-30-250 | 220 | 1,1 | 250 | 709,74 € |
| SHTC-30-500 | 220 | 1,1 | 500 | 789,49 € |
| SHTC-30-1000 | 220 | 1,1 | 1000 | 948,99 € |

Our other products



Stainless steel bevel gear, 2:1



Steel bevel gear, 2:1



Stainless steel indexing plunger, Stainless steel



Nut for toggle clamp, Round ended nut for SLH/SLV clamp



Guide for aluminium profile, Rail for 8mm wide slots



Ball transfer unit push fit, Light



Quarter-turn clamp lock, Plastic or stainless steel button



Reducing sleeve for OP indicators, Reduction socket



12 and 24V DC power supplies, 1,5 A and 2 A



Hammerhead screw, Hammerhead screw



Strike for toggle latch, 22mm

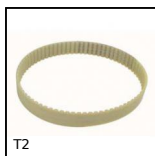

T type timing belt, T2.5 Steel cored polyurethane

Complementary products



Drylin® Linear table, Economy range