

Shoulder screw **stainless steel 303**

SHS

Stainless steel 550 N/mm²

- **Material: Stainless steel 303**
- For centering as well as holding
- Working temperature up to +430°C
- Hexagonal socket head
- Traction resistance: 550N/mm²
- **Not sold individually, please contact us for details**



Uses

- For use in harsh environments

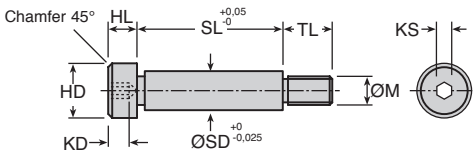

DISCOUNTS

Qty	1+	6+	20+	40+	60+	100+	300+
Disc.	List	-10%	-15%	-20%	-30%	-55%	On request

Part number	Thread		SL	HD	HL	TL	KS	KD	Stock*	Price each 1 to 5
	ØM	SD								
SHS3-4	M3	3,987	4,013	6	3	4	2,0	1,6	✓	6,39 €
SHS3-5	M3	3,987	5,013	6	3	4	2,0	1,6	✓	6,39 €
SHS3-6	M3	3,987	6,013	6	3	4	2,0	1,6	✓	6,39 €
SHS3-8	M3	3,987	8,013	6	3	4	2,0	1,6	✓	6,39 €
SHS3-10	M3	3,987	10,013	6	3	4	2,0	1,6	✓	6,39 €

*Depending on availability - Dimensions in mm

DISCOUNTS

Qty	1+	6+	20+	40+	60+	100+	300+
Disc.	List	-10%	-15%	-20%	-30%	-55%	On request

Part number	Thread									Stock*	Price each 1 to 5
	ØM	SD	SL	HD	HL	TL	KS	KD			
SHS4-4	M4	4,987	4,013	8	4	5	2,5	2,0	✓	6,39	€
SHS4-5	M4	4,987	5,013	8	4	5	2,5	2,0	✓	6,39	€
SHS4-6	M4	4,987	6,013	8	4	5	2,5	2,0	✓	6,39	€
SHS4-8	M4	4,987	8,013	8	4	5	2,5	2,0	✓	6,39	€
SHS4-10	M4	4,987	10,013	8	4	5	2,5	2,0	✓	6,39	€
SHS4-12	M4	4,987	12,013	8	4	5	2,5	2,0	✓	7,27	€
SHS4-14	M4	4,987	14,013	8	4	5	2,5	2,0	✓	7,27	€
SHS4-16	M4	4,987	16,013	8	4	5	2,5	2,0	✓	7,27	€
SHS4-20	M4	4,987	20,013	8	4	5	2,5	2,0	✓	7,27	€
SHS4-25	M4	4,987	25,013	8	4	5	2,5	2,0	✓	9,08	€
SHS4-30	M4	4,987	30,013	8	4	5	2,5	2,0	✓	9,08	€
SHS5-4	M5	5,987	4,013	10	5	6	3,0	2,4	✓	6,39	€
SHS5-5	M5	5,987	5,013	10	5	6	3,0	2,4	✓	6,39	€
SHS5-6	M5	5,987	6,013	10	5	6	3,0	2,4	✓	6,39	€
SHS5-8	M5	5,987	8,013	10	5	6	3,0	2,4	✓	6,39	€
SHS5-10	M5	5,987	10,013	10	5	6	3,0	2,4	✓	6,39	€
SHS5-12	M5	5,987	12,013	10	5	6	3,0	2,4	✓	7,27	€
SHS5-14	M5	5,987	14,013	10	5	6	3,0	2,4	✓	7,27	€
SHS5-16	M5	5,987	16,013	10	5	6	3,0	2,4	✓	9,72	€
SHS5-20	M5	5,987	20,013	10	5	6	3,0	2,4	✓	10,51	€
SHS5-25	M5	5,987	25,013	10	5	6	3,0	2,4	✓	10,51	€
SHS5-30	M5	5,987	30,013	10	5	6	3,0	2,4	✓	10,51	€
SHS6-6	M6	7,987	6,013	12	6	11	4,0	3,2	✓	10,51	€
SHS6-8	M6	7,987	8,013	12	6	11	4,0	3,2	✓	10,51	€
SHS6-10	M6	7,987	10,013	12	6	11	4,0	3,2	✓	10,51	€
SHS6-12	M6	7,987	12,013	12	6	11	4,0	3,2	✓	10,51	€
SHS6-16	M6	7,987	16,013	12	6	11	4,0	3,2	✓	10,51	€
SHS6-20	M6	7,987	20,013	12	6	11	4,0	3,2	✓	10,51	€
SHS6-25	M6	7,987	25,013	12	6	11	4,0	3,2	✓	13,32	€
SHS6-30	M6	7,987	30,013	12	6	11	4,0	3,2	✓	13,32	€
SHS6.1-8/SD	M6	9,987	8,013	12	6	11	4,0	3,2	-	16,28	€
SHS6.1-10/SD	M6	9,987	10,013	12	6	11	4,0	3,2	✓	16,28	€
SHS6.1-12/SD	M6	9,987	12,013	12	6	11	4,0	3,2	-	16,28	€
SHS6.1-16/SD	M6	9,987	16,013	12	6	11	4,0	3,2	-	16,28	€
SHS8-8	M8	9,987	8,013	14	7	12	5,0	4,0	✓	13,17	€
SHS8-10	M8	9,987	10,013	14	7	12	5,0	4,0	✓	13,17	€
SHS8-12	M8	9,987	12,013	14	7	12	5,0	4,0	✓	13,17	€
SHS8-16	M8	9,987	16,013	14	7	12	5,0	4,0	✓	13,17	€
SHS8-25	M8	9,987	25,013	14	7	12	5,0	4,0	✓	18,73	€
SHS8-30	M8	9,987	30,013	14	7	12	5,0	4,0	✓	18,73	€
SHS10-12	M10	11,987	12,013	20	8	16	6,0	4,8	✓	22,85	€
SHS10-16	M10	11,987	16,013	20	8	16	6,0	4,8	✓	22,85	€
SHS10-20	M10	11,987	20,013	20	8	16	6,0	4,8	✓	22,85	€
SHS10-25	M10	11,987	25,013	20	8	16	6,0	4,8	✓	22,85	€
SHS10-30	M10	11,987	30,013	20	8	16	6,0	4,8	✓	36,91	€

*Depending on availability - Dimensions in mm

Our other products



WBGV
Lifting ring, Threaded



CLAT
Clamping lever
Hygienic Usit® -
male, Stainless steel



PAT123
Pressed stainless
steel articulating foot
Ø123, Ø 123



PAMF120
Articulated fixable
foot, pressed bolt-
down base Ø 120, Ø
120



CHAC4040NP
Square hinge with
riveted pin, not
drilled, Square with
riveted pin,...



GAC
Lock for latch clamp,
Strike plate



PLM-20SC
Threaded cylindrical
magnet, With
threaded hole



CHMX_CHMDX
Shaft for worm and
wheel reducer CHMR
and CHM, CHMR and
CHM gearbox...



MHX
Hexagonal threaded
sleeve, Hexagonal -



TCXR
Automatic chain
tensioner, With



FBL6000_K19
Brush strip per meter
horsehair fibres Ø0.2,



PFM
Fixed levelling foot,
Flanged plate

Complementary products



HSS
Shoulder screw
ISO7379, Hardened
Steel class 12.9



SHSS
Shoulder screw
stainless steel 416,
Pre-treated 416
stainless steel



SHW
Plain washer, A2
Stainless steel



SHN
Hexagonal nut
DIN934, A2 Stainless
steel