

- Female threaded rod end
- Axial static load = 0.2 x radial static load
- Materials:

Housing: stainless steel 303

Insert: stainless steel 303

Sphere: stainless steel 420

Coating: UNIFLON® between ring and sphere

### Advantages

- Long life expectancy
- Low friction
- No maintenance required
- Corrosion resistant

### Uses

- Oscillating movement in hostile environments (water, salt, dampness, other difficult atmospheric conditions...)

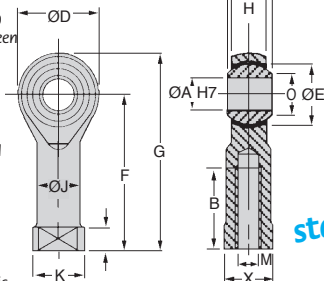

Swiss precision



### DISCOUNTS

Qty	1+	10+	24+
Disc.	List	-20%	On request

Part number	ØA	B	ØD	F	G	H	ØJ	K	L	M	O	W	X
SFE3.45	3	10	12	21	27	4,50	5,00	6,50	3,00	M3 x 0,50	5,18	6	5,50
SFE5.45	5	14	16	27	35	6,00	7,50	9,50	4,00	M5 x 0,80	7,71	8	8,00
SFE6.45	6	14	18	30	39	6,75	9,50	12,00	5,00	M6 x 1	8,98	9	10,00
SFE8.45	8	17	22	36	47	9,00	12,50	16,00	5,00	M8 x 1,25	10,40	12	13,00
SFE10.45	10	20	26	43	56	10,50	15,00	19,00	6,50	M10 x 1,50	12,92	14	16,00
SFE12.45	12	22	30	50	65	12,00	17,50	22,00	6,50	M12 x 1,75	15,43	16	18,00
SFE14.45	14	27	34	57	74	13,50	20,00	25,00	8,00	M14 x 2	16,86	19	21,00
SFE16.45	16	33	38	64	83	15,00	22,00	27,00	8,00	M16 x 2	19,39	21	24,00
SFE18.45	18	36	42	71	92	16,50	25,00	31,00	10,00	M18 x 1,50	21,89	23	27,00

Part number	Radial static load (daN)	Sphere ØE	Weight (g)	Price each 1 to 5
SFE3.45	160	6,00	7	198,57 €
SFE5.45	250	11,11	14	129,44 €
SFE6.45	300	12,70	22	115,16 €
SFE8.45	450	15,88	38	122,53 €
SFE10.45	600	19,05	70	149,10 €
SFE12.45	770	22,23	110	172,26 €
SFE14.45	940	25,40	150	167,32 €
SFE16.45	1140	28,58	200	303,54 €
SFE18.45	1370	31,75	280	540,80 €

Dimensions in mm

## Our other products



Curved track for plate chain, Ranges 880 and 881



Floway2® roller track, Roller track



Clamping pin for sheets, For sheet metal



HEAVY DUTY spur gear, Steel 35NCD6



Bolt-on hinge with threaded insert, 225 degrees



HEAVY DUTY spur gear, Steel 35NCD6



Steel spur gear, Steel 35NCD6



Worm and wheel gear reducer, up to 18 Nm



Magnetic stud, With threaded hole



Locking pin, with ring

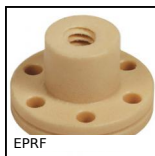

High helix leadscrew, Flanged nut - up to



Steel bevel gear, 2:1

## Complementary products



Female rod ends, Stainless steel / bronze - Economy range



Female rod ends, Steel / bronze