

# Quarter turn latch for **the food industry**

Key

SER69K

- Key for SER69K stainless steel 1/4 turn latch
- 2 versions:  
Clé-T in plastic with triangular head  
Clé-R in plastic with stainless steel insert,  
rounded head

## Advantages

- Ideal for use in the food industry

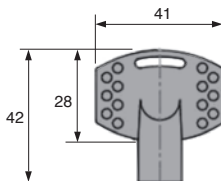

SER69K-CLE-T

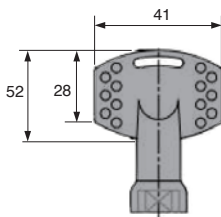
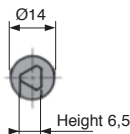

SER69K-CLE-R

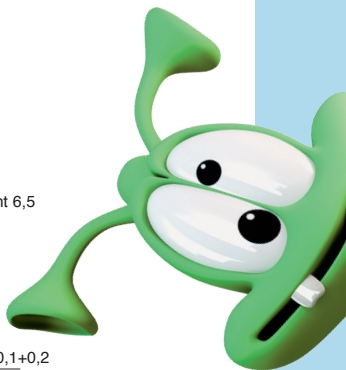
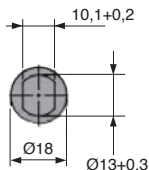

## DISCOUNTS

Qty	1+	6+	10+	15+
Disc. List	-5%	-10%	On request	

Part number	Drive	Material	Price each 1 to 5
SER69K-CLE/T	Triangular	Plastic	2,48 €
SER69K-CLE/R	Rounded	Plastic, stainless steel insert	6,25 €

All dimensions in mm

**Fax** 0 825 88 6000  
Service 0,15 € / min  
+ prix appel

cial2@hpceurope.com

**HPC** SUPPLEMENT 2019

77

## Our other products



PRF\_ECL

Nut for aluminium profile, Steel square nut with tab



MDB\_MTB

Moulded plastic bevel gear (nylon), 2:1

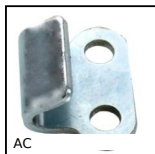

AC

Strike for toggle latch, 18mm



HLMss

Revolving handle for handwheel, Stainless steel 316



PLC\_PLT

Magnetic stud with threaded hole, With threaded hole



CHM30

Worm and wheel gear reducer, up to 28 Nm



PTMC

Telescopic furniture foot, square plate



HK

Manual locking clamp, Manual locking clamp T



PT881

Drive sprocket for slat top chain, Range 881



F7-E

Multifunction display, With external sensor



PRF\_BM

Base support plate for aluminium profile, Central base fixation



PPG

Indexing plunger with flange, With horizontal mounting flange

## Complementary products



SER69K

Quarter turn latch for the food industry, Stainless steel