

- Closed housing
- SA: Housing only
- SAKH** : Housing and light KH bearing with seal
- Material: anodised aluminium

Accessories

- Hardened ground shafts Z-A, Z-B
- End support for shafts FGWA, SFWR

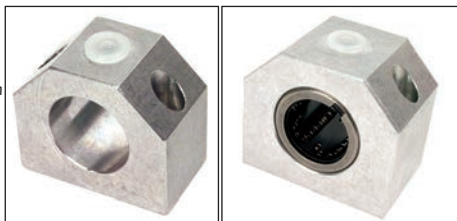

SA: housing only

SAKH: housing + KH bearing

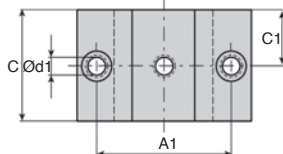
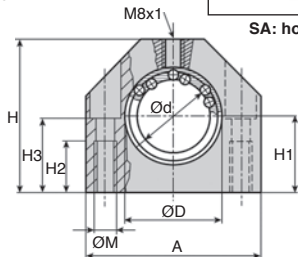

DISCOUNTS

Qty	1+	5+	10+	25+
Disc. List	-6%	-12%	On request	

Part number	Housing only	Housing and bearing	For shaft Ød	ØD	A	C	H	A1 ±0,15	C1
SA12	SAKH-12-LL		12	19	40	28	33	29	14
SA16	SAKH-16-LL		16	24	45	30	38	34	15
SA20	SAKH-20-LL		20	28	53	30	45	40	15
SA25	SAKH-25-LL		25	35	62	40	54	48	20
SA30	SAKH-30-LL		30	40	67	50	60	53	25
SA40	SAKH-40-LL		40	52	87	60	76	69	30
SA50	SAKH-50-LL		50	62	103	70	92	82	35

Part number	Housing only	Housing and bearing	H1 +0,010 -0,02	H2	H3	ØM	Ød1	Stock* Housing + bearing	Price each 1 to 4 Housing only	Housing + bearing
SA12	SAKH-12-LL		17	11	16	M5	4,3	✓	35,07 €	49,79 €
SA16	SAKH-16-LL		19	11	18	M5	4,3	✓	36,65 €	55,56 €
SA20	SAKH-20-LL		23	13	22	M6	5,3	✓	40,85 €	61,84 €
SA25	SAKH-25-LL		27	18	26	M8	6,6	✓	51,37 €	74,43 €
SA30	SAKH-30-LL		30	18	29	M8	6,6	✓	67,07 €	98,58 €
SA40	SAKH-40-LL		39	22	38	M10	8,4	-	99,62 €	145,79 €
SA50	SAKH-50-LL		47	26	46	M12	10,5	-	131,12 €	188,83 €

*Depending on availability - Dimensions in mm

Our other products



CHAR7530

Spring hinge, welded



UCP_PBT

Stainless/Polymer pillow block bearing, Polymer and stainless steel



PRT

Rotary table iglidur®, Iglidur®, aluminium and stainless steel



SC2

2 part rigid shaft clamp, Clamping jaw

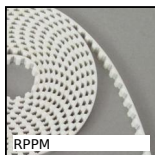

RPPM

RPP type belt per metre, RPP14 Steel cored polyurethane



ESCON

Speed controller 5A, 5 A



RT25

Self-centering flanged locking assembly, Medium/high torque



DCG

Suction cup, 2.5 bellows, nitrile



PX

Optional output shaft stainless steel, P gearboxes double



M1

Worm and wheel set, Hardened steel



LRM2

Cylindrical bronze nut, Bronze - 2 threads



AT5M AT10M

AT type timing belt per metre, AT5 Steel cored polyurethane

Complementary products



ZA

Shaft for linear guides, Hardened ground steel



FGWA

End support, With base



ZA

Shaft for linear guides, Hardened ground steel