

- Closed housing
- SA: Housing only
- SAKH : Housing and light KH bearing with seal
- Material: anodised aluminium

Accessories

- Hardened ground shafts Z-A, Z-B
- End support for shafts FGWA, SFWR



SA: housing only



SAKH: housing + KH bearing

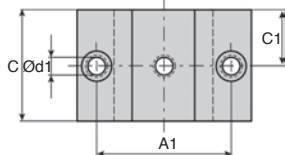
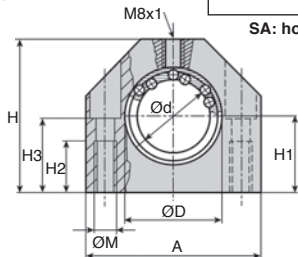

DISCOUNTS

Qty	1+	5+	10+	25+
Disc. List	-6%	-12%	On request	

Part number	Housing only	Housing and bearing	For shaft Ød	ØD	A	C	H	A1 +/-0,15	C1
SA12	SAKH-12-LL		12	19	40	28	33	29	14
SA16	SAKH-16-LL		16	24	45	30	38	34	15
SA20	SAKH-20-LL		20	28	53	30	45	40	15
SA25	SAKH-25-LL		25	35	62	40	54	48	20
SA30	SAKH-30-LL		30	40	67	50	60	53	25
SA40	SAKH-40-LL		40	52	87	60	76	69	30
SA50	SAKH-50-LL		50	62	103	70	92	82	35

Part number	Housing only	Housing and bearing	H1 +0,010 -0,02	H2	H3	ØM	Ød1	Stock* Housing + bearing	Price each 1 to 4 Housing only	Housing + bearing
SA12	SAKH-12-LL		17	11	16	M5	4,3	✓	35,07 €	49,79 €
SA16	SAKH-16-LL		19	11	18	M5	4,3	✓	36,65 €	55,56 €
SA20	SAKH-20-LL		23	13	22	M6	5,3	✓	40,85 €	61,84 €
SA25	SAKH-25-LL		27	18	26	M8	6,6	✓	51,37 €	74,43 €
SA30	SAKH-30-LL		30	18	29	M8	6,6	✓	67,07 €	98,58 €
SA40	SAKH-40-LL		39	22	38	M10	8,4	-	99,62 €	145,79 €
SA50	SAKH-50-LL		47	26	46	M12	10,5	-	131,12 €	188,83 €

*Depending on availability - Dimensions in mm

Our other products



VHEH

Hexagonal headed screw with collar Hygienic Usit®, Stainless steel



RAS

90° ball and socket joints DIN71802, Stainless steel



PRES2HR

Manual workbench press, Force up to 200kg



BLHB60

Right angled gearbox, bored shafts, up to 70 Nm



STRIP1000

Sealing brush strip, 1m length



PRF_SDD_1820

Support for Ø18 or Ø20mm Prox detector, Ø18 and Ø20



CHAEss

Decorative hinge, Stainless steel



TBD

Manual leadscrew table with opposing threads, 20kg



PTRSS

Idler chain sprocket, For hostile environments



DOMI80

Accessories, Fixing kit



GPLbr

Brush, brass



CHAC4040NP

Square hinge with riveted pin, not drilled, Square with riveted pin, ...

Complementary products



ZA

Shaft for linear guides, Hardened ground steel



FGWA

End support, With base



ZA

Shaft for linear guides, Hardened ground steel