

Rotex® jaw coupling



RTE 

Torque: 2 to 4800Nm

- Maintenance free
- 3 part construction
- Max torsion angle 5°
- Materials:
 - Hub: Aluminium, steel or cast iron
 - Spider: Polyurethane (92 Shore A)
- Working temp. -40°C to +100°C
- Bore (tolerance H7) and keyway acc DIN6885/1-J59
- Axial plug-in assembly
- **Bores are not finished**

Absorbs shocks



Options

- Modification to bore sizes at additional cost (H7 tolerance and keyway acc DIN6885/1-J53)

Info.

- *Except for non-bored or pre-bored couplings

 **STANDARD BORES IN STOCK**

set screw and keyway fixing*

Part number	Material	Pre-bore ØA	Standard ØA	Optional ØA	ØD	ØG	K	E	S	b	L	M	ØB
RTE-A-14	Aluminium	Full	14	6 8 9 10 11 12 15	30	30	11	13	1,5	10	35	0	10
RTE-A-19	Aluminium	Full	14,19	10 11 12 15 16	32	41	25	16	2,0	12	66	20	18
		-	-	20 24	41	41	25	16	2,0	12	66	20	18
RTE-SL-19	Steel	Full	25	10 11 12 14 15 16 18 19 20 24	40	40	25	16	2,0	12	66	-	18
RTE-A-24	Aluminium	Full	15,19	14 15 16 18 19 20 24	40	56	30	18	2,0	14	78	24	27
		20	-	25 28	56	56	30	18	2,0	14	78	24	27
RTE-SL-24	Steel	Full	-	14 15 16 18 19 20 22 24 25 28	55	55	30	18	2,0	14	78	-	27
RTE-A-28	Aluminium	Full	20,25	14 16 18 19 22 24 28	48	67	35	20	2,5	15	90	28	30
		23	-	30 35 38	67	67	35	20	2,5	15	90	28	30
RTE-SL-28	Cast iron	Full	30	14 15 16 18 19 20 22 24 25 28 32 35 38	65	65	35	20	2,5	15	90	-	30
RTE-GG-38	Cast iron	Full	-	16 18 19 20 22 24 25 28 30 32 35 38	66	80	45	24	3,0	18	114	37	38
		36	-	40 42	78	80	45	24	3,0	18	114	37	38
RTE-GG-42	Cast iron	Full	-	30 32 35 38 40 42	75	95	50	26	3,0	20	126	40	46
RTE-GG-48		Full	-	25 30 32 35 38 40 42 45 48	85	105	56	28	3,5	21	140	45	51
RTE-GG-55		18	-	30 32 35 38 40 42 45 48 50 55	98	120	65	30	4,0	22	160	52	60
RTE-GG-65		20	-	40 45 48 50 55 60 65	115	135	75	35	4,5	26	185	47	68
RTE-GG-75		28	-	40 45 48 50 55 60 65 70 75	135	160	85	40	5,0	30	210	53	80
RTE-GG-90	38	-	50 55 60 65 70 75 80 85 90	160	200	100	45	5,5	34	245	62	100	

Dimensions in mm

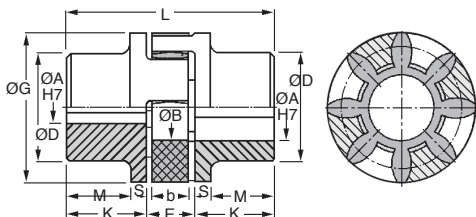

Plug-in design !

DISCOUNTS

Qty	1+	5+	10+	25+
Disc.	List	-6%	-12%	On request

Misalignment at 1500 (rpm) Max.				Torque Tk (Nm)		Angle of torsion		Price each 1 to 4		
Axial (mm)	Radial (mm)	Angular	speed (rpm)	Alternate	Nominal	Tk max.	Tk ψ	Tk max. ψ	Plain or pre-bored	Standard bore and keyway
-0,5/1,0	0,17	1,2°	19 000	2,0	7,5	15	6,4°	10°	36,57 €	51,39 €
-0,5/1,2	0,20	1,2°	14 000	2,6	10	20	3,2°	5°	29,51 €	62,77 €
-0,5/1,2	0,20	1,2°	14 000	2,6	10	20	3,2°	5°	35,23 €	-
-0,5/1,2	0,20	1,2°	14 000	2,6	10	20	3,2°	5°	41,59 €	78,34 €
-0,5/1,4	0,22	0,9°	10 600	9,0	35	70	3,2°	5°	38,89 €	79,74 €
-0,5/1,4	0,22	0,9°	10 600	9,0	35	70	3,2°	5°	45,12 €	-
-0,5/1,4	0,22	0,9°	10 600	9,0	35	70	3,2°	5°	59,13 €	103,75 €
-0,7/1,5	0,25	0,9°	8 500	25,0	95	190	3,2°	5°	53,41 €	104,13 €
-0,7/1,5	0,25	0,9°	8 500	25,0	95	190	3,2°	5°	56,05 €	-
-0,7/1,5	0,25	0,9°	8 500	25,0	95	190	3,2°	5°	76,29 €	130,27 €
-0,7/1,8	0,28	1,0°	7 100	49,0	190	380	3,2°	5°	141,56 €	203,05 €
-0,7/1,8	0,28	1,0°	7 100	49,0	190	380	3,2°	5°	-	-
-1,0/2,0	0,32	1,0°	6 000	69,0	265	530	3,2°	5°	214,96 €	295,37 €
-1,0/2,1	0,36	1,1°	5 600	81,0	310	620	3,2°	5°	252,87 €	340,55 €
-1,0/2,2	0,38	1,1°	4 750	105,0	410	820	3,2°	5°	351,29 €	440,07 €
-1,0/2,6	0,42	1,2°	4 250	163,0	625	1 250	3,2°	5°	475,27 €	595,48 €
-1,5/3,0	0,48	1,2°	3 550	254,0	975	1 950	3,2°	5°	743,53 €	895,23 €
-1,5/3,4	0,50	1,2°	2 800	624,0	2400	4 800	3,2°	5°	1 111,64 €	1 307,00 €

Dimensions in mm

Our other products



VDSQ

Sliding lock adjustment system,
Sliding lock for square profile



SH0

Parallel axis helical gear, Steel 20NCD2



VTHbr

Hexagonal headed screw VTH - DIN933, Brass



RPctcss

Swivel castor with central hole, Stainless steel - Polyamide - with ...



CHAE4080PA

Symmetrical decorative screwed hinge, Polyamide

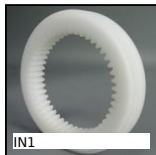

IN1

Internal gear, Machined plastic (delrin)



MHPGR

Arm with folding rotating handle,



MEB

Moulded plastic bevel gear (nylon), 1:1



MEP

Revolving handle for handwheel, Fixed



PCS62SS

Chain sprocket - Stainless steel, 15.875mm (DIN)



FTSN

Supported shaft for linear guide, Steel shaft / Aluminium



CHTRP

Single and dual output gearboxes, Up to 75,7 Nm

Complementary products



RTE

Rotex®, jaw coupling, Aluminium



RTE

Rotex®, jaw coupling, steel



KK

Rounded end feather key, Steel