

- Inserts between the shaft and the bore
- High transmissible torque
- Contact pressure spread evenly
- Easy to assembly and dismantle
- Reduced width
- Backlash free
- **No constraints due to keyway**
- Increases the resistant part of the shaft
- Suitable for alternating rotational movements

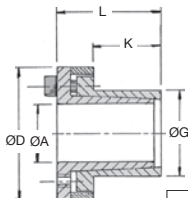

Options

- Other diameters available (up to 100mm bore)

Info

- * PN: hub surface pressure
- * Pw: shaft surface pressure

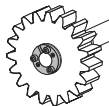
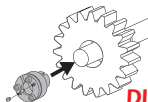

DISCOUNTS

| Qty | 1+ | 6+ | 10+ | 20+ | 40+ | 60+ |
|-------|------|------|------|------|------|------------|
| Disc. | List | -20% | -30% | -40% | -50% | On request |

| Part number | ØA | ØG | ØD | L | Screw M | K | Tightening torque TA(Nm) | Transmissible torque T (Nm) | *Pw (N/mm ²) | *PN (N/mm ²) | Stock* | Price each 1 to 5 |
|-------------|----|----|----|------|------------|------|--------------------------------|-----------------------------------|-----------------------------|-----------------------------|--------|-------------------------|
| RT25-6-14 | 6 | 14 | 25 | 22,5 | 3xM3x10 | 10,0 | 2,2 | 12 | 190 | 80 | ✓ | 24,90 € |
| RT25-8-15 | 8 | 15 | 27 | 25,5 | 3xM4x12 | 12,0 | 5,0 | 29 | 205 | 110 | ✓ | 21,87 € |
| RT25-9-16 | 9 | 16 | 28 | 27,5 | 3xM4x12 | 14,0 | 5,0 | 31 | 150 | 85 | ✓ | 22,10 € |
| RT25-10-16 | 10 | 16 | 28 | 27,5 | 3xM4x12 | 14,0 | 5,0 | 35 | 140 | 85 | ✓ | 22,10 € |
| RT25-11-18 | 11 | 18 | 32 | 27,5 | 4xM4x12 | 14,0 | 5,0 | 52 | 170 | 105 | ✓ | 22,36 € |
| RT25-12-18 | 12 | 18 | 32 | 27,5 | 4xM4x12 | 14,0 | 5,0 | 58 | 150 | 100 | ✓ | 22,36 € |
| RT25-14-23 | 14 | 23 | 39 | 27,5 | 4xM4x12 | 14,0 | 5,0 | 69 | 140 | 80 | ✓ | 20,15 € |
| RT25-16-24 | 16 | 24 | 45 | 36,5 | 4xM6x12 | 16,0 | 17,0 | 180 | 148 | 98 | ✓ | 23,51 € |
| RT25-18-26 | 18 | 26 | 47 | 39,5 | 4xM6x18 | 19,0 | 17,0 | 200 | 180 | 125 | ✓ | 23,65 € |
| RT25-19-27 | 19 | 27 | 49 | 39,5 | 4xM6x18 | 19,0 | 17,0 | 210 | 170 | 120 | ✓ | 23,65 € |
| RT25-20-28 | 20 | 28 | 50 | 39,5 | 4xM6x18 | 19,0 | 17,0 | 220 | 160 | 115 | ✓ | 24,52 € |
| RT25-22-32 | 22 | 32 | 54 | 46,5 | 4xM6x18 | 26,0 | 17,0 | 250 | 115 | 80 | ✓ | 26,75 € |
| RT25-24-34 | 24 | 34 | 56 | 46,5 | 6xM6x18 | 26,0 | 17,0 | 395 | 146 | 102 | - | 26,79 € |
| RT25-25-34 | 25 | 34 | 56 | 46,5 | 6xM6x18 | 26,0 | 17,0 | 410 | 140 | 102 | ✓ | 27,38 € |
| RT25-28-39 | 28 | 39 | 61 | 46,5 | 6xM6x18 | 25,5 | 17,0 | 465 | 135 | 98 | ✓ | 30,37 € |
| RT25-30-41 | 30 | 41 | 62 | 46,5 | 6xM6x18 | 25,5 | 17,0 | 510 | 127 | 90 | ✓ | 31,08 € |
| RT25-32-43 | 32 | 43 | 65 | 46,5 | 8xM6x18 | 25,5 | 17,0 | 705 | 146 | 108 | ✓ | 33,84 € |
| RT25-35-47 | 35 | 47 | 69 | 52,5 | 8xM6x18 | 31,5 | 17,0 | 790 | 105 | 80 | - | 34,50 € |
| RT25-38-50 | 38 | 50 | 72 | 52,5 | 8xM6x18 | 31,5 | 17,0 | 860 | 100 | 76 | ✓ | 39,42 € |
| RT25-40-53 | 40 | 53 | 75 | 52,5 | 8xM6x18 | 31,5 | 17,0 | 900 | 96 | 72 | ✓ | 41,20 € |
| RT25-42-55 | 42 | 55 | 78 | 52,5 | 8xM6x18 | 31,5 | 17,0 | 940 | 90 | 70 | - | 45,75 € |
| RT25-45-59 | 45 | 59 | 86 | 71,0 | 8xM8x22 | 45,0 | 41,0 | 1840 | 110 | 85 | - | 62,25 € |
| RT25-48-62 | 48 | 62 | 87 | 71,0 | 8xM8x22 | 45,0 | 41,0 | 2000 | 105 | 80 | - | 66,97 € |
| RT25-50-65 | 50 | 65 | 92 | 71,0 | 8xM8x22 | 45,0 | 41,0 | 2100 | 100 | 75 | ✓ | 72,49 € |
| RT25-55-71 | 55 | 71 | 98 | 81,0 | 9xM8x22 | 55,0 | 41,0 | 2580 | 85 | 65 | - | 87,26 € |

*Depending on availability - Dimensions in mm

Our other products



DKN
Bellows coupling
Gerwah®, from 0.4 to
10Nm



BWU
Compact precision
slide, from 1510 N to
10500 N

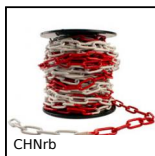

CHNrb
Warning chain with
red and white links,
Steel



PSG055
Spur gear - precision
range, Stainless steel
303



SH2
Parallel axis helical
gear, Machined plastic
(delrin)



RGS
Rotex® GS backlash
free jaw coupling,
from 0.5 to 190Nm



H2
Crossed helical gear
crossed axis at 90°,
Steel 20NCD2



BL8
Right angled gearbox,
from 0.20 to 2 Nm



MET
Cylindrical sintered
bronze bush, Self-



YG1
HEAVY DUTY spur
gear, Steel 35NCD6



PRF_T
Corner reinforcement,
Corner reinforcement



BLH70
Right angled gearbox,
from 26 to 128 Nm

Complementary products



RT70
Self-centering locking
Assembly,
Medium/high torque



RTT
Locking Assembly,
Medium/high torque



RT61
Self-centering locking
Assembly,
Medium/low torque



RT61ss
Self-centering locking
Assembly,
Medium/low torque