



Closed polymer **DryLin®R** bearing

Unaffected by dirt

RJUM01
RJZM01

- Closed bearing with polymer slide surface

- Max. speed

Dry working 8m/s

With lubrication >10 m/s

- Working temperature from -60°C to +100°C

(wear increases if temperature >80°C)

- Max. load 35 N/mm²

- Recommended load 5N/mm² (linear)

- Material:

Housing: Aluminium

Bearing: DryLin®R



Fast and silent

Advantages

- Maintenance free

- Self lubricating

- 20% of weight of equivalent steel version

- Silent in operation

Accessories

- AWM aluminium shaft

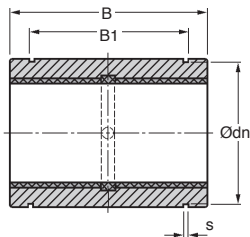
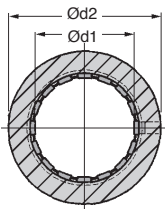

Until
-22%*

DISCOUNTS

Qty	1+	6+	20+	40+	60+
Disc.	List	-10%	-15%	-20%	On request

Part number	Ød1	Tolerance	Ød2 (h7)	B (h10)	B1 (H10)	s (H10)	Ødn	Stock*	Price each 1 to 5
RJZM01-05	5	0,02 - 0,05	12	22	14,20	1,10	11,50	✓	14,68 €
RJZM01-08	8	0,02 - 0,05	16	25	16,20	1,10	15,20	✓	14,98 €
RJUM01-10	10	0,02 - 0,05	19	29	21,60	1,30	17,50	✓	16,13 €
RJUM01-12	12	0,02 - 0,05	22	32	22,60	1,30	20,50	✓	19,22 €
RJUM01-16	16	0,02 - 0,05	26	36	24,60	1,30	24,20	✓	21,07 €
RJUM01-20	20	0,02 - 0,06	32	45	31,20	1,60	29,60	✓	26,40 €
RJUM01-25	25	0,02 - 0,06	40	58	43,70	1,85	36,50	✓	34,02 €
RJUM01-30	30	0,02 - 0,07	47	68	51,70	1,85	43,50	✓	43,62 €
RJUM01-40	40	0,02 - 0,07	62	80	60,30	2,15	57,80	-	71,43 €
RJUM01-50	50	0,02 - 0,09	75	100	77,30	2,65	70,50	-	104,89 €

*Depending on availability - Dimensions in mm

Our other products



TBD

Manual leadscrew table with opposing threads, 2kg



PLM-C

Flat gripping magnet, Flat holding magnet



TM_CTM_CTF

Suction cup threaded insert, Insert for suction cup - Tread click-in



PRF_P

Anchor foot for 45x45 profile, Anchor foot



CHMR50

Worm and wheel gear reducer, up to 107 Nm



GLP

Small 6 lobe threaded handle - male, Technopolymer - Stainless steel



EHD06

Internal epicyclic servo reducers, from 8 to 19 Nm



PRF4545

Standard aluminium profile, 45 x 45 mm



B_ECO

Eco. range steel bevel gear, 1:1



PGMT

Pull handle, Stainless steel



CHB

Worm and wheel gear reducer, up to 22 Nm



PR125

Articulated foot Ø123, Ø 123

Complementary products