



RGS Couplings for servo-motors



Torque: **0.5 to 190Nm**

- No-wear elastic couplings
- No maintenance
- Low inertia and reduced size
- Easy blind assembly using standard screws
- Dampens vibration
- Electrically insulated

Definition

- TKN Nominal torque (Nm)
- TKMAX Max. torque (Nm)

Info

- Delivered not assembled

clamp fixing

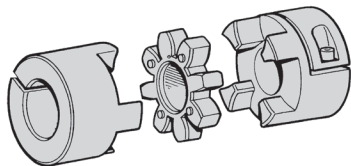
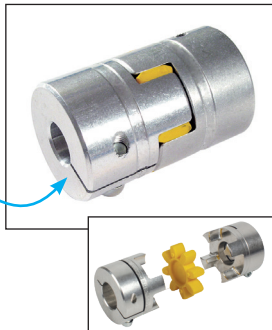

✓ STANDARD BORE IN STOCK

DISCOUNTS

Qty	1+	5+	10+	25+
Disc.	List	-6%	-12%	On request

Transmissible torque (Nm) by friction for split hub

Part number	Ø3	Ø4	Ø5	Ø6	Ø7	Ø8	Ø10	Ø12	Ø14	Ø15	Ø16	Ø19	Ø20	Ø24	Ø28	Ø30	Ø32
RGS-AL-5	-	-															
RGS-AL-7		0,65	0,70	0,74	0,79												
RGS-AL-9		1,48	-	1,43	-	1,79	1,94										
RGS-AL-14			3,32	3,43	-	3,67	3,91	4,14	4,38								
RGS-AL-19							18,90	-	20,80	21,3	21,7	-	23,6				
RGS-AL-24												27,5	28	29,0	31		
RGS-AL-28														62,0	66	69	71 73

Part number	Max. speed (rpm)	Torsional stiffness		Radial stiffness (N/mm)	Torque (Nm)			Misalignment		
		static (Nm/rad)	dynamic (Nm/rad)		T_{KSP}	T_{KN}	T_{KMAX}	axial (mm)	radial (mm)	angular
RGS-AL-5	38 000	5,16	16	154	0,08	0,50	1,00	+0,4/-0,2	0,06	1°
RGS-AL-7	27 000	14,30	43	219	0,20	1,20	2,40	+0,6/-0,3	0,10	1°
RGS-AL-9	19 000	31,50	95	262	0,45	3,00	6,00	+0,8/-0,4	0,13	1°
RGS-AL-14	127 000	114,60	344	336	1,00	7,50	15,00	+1/-0,5	0,15	1°
RGS-AL-19	9 550	1090,00	1720	1120	2,50	12,00	24,00	+1,2/-0,5	0,10	1°
RGS-AL-24	6 950	2280,00	4010	1480	-	35,00	70,00	+1,4/-0,5	0,14	1°
RGS-AL-28	5 850	4080,00	6754	1780	-	95,00	190,00	+1,5/-0,7	0,15	1°

Dimensions in mm

Characteristics

- Long-life
- Fixed by clamping jaw (except RGS-AL-5)
- Single-slit split hub (except RGS-AL-24 and RGS-AL-28 double slit)
- Preconstrained raised coupling
- Working temperature: -40°C to $+90^{\circ}\text{C}$ (occasional -50°C to $+120^{\circ}\text{C}$)
- Materials:
 - Hub: aluminium
 - Ring: polyurethane elastic (92 Shore A)

Uses

- Measuring and control instruments
- Servo-control, ball-screw systems
- Machine tools

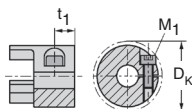
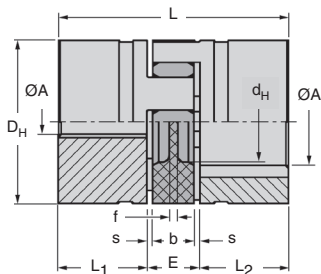

DISCOUNTS

Qty	1+	5+	10+	25+
Disc.	List	-6%	-12%	On request

Part number	Clamping screw			Tightening torque T_A (Nm)
	M_1	t_1	$\text{Ø}D_K$	
RGS-AL-5	M1,2	2,5	11,4	-
RGS-AL-7	M2,0	3,5	16,5	0,37
RGS-AL-9	M2,5	5,0	23,4	0,76
RGS-AL-14	M3,0	5,0	32,2	1,34
RGS-AL-19	M6,0	12,0	45,7	10,50
RGS-AL-24	M6,0	10,5	56,4	10,50
RGS-AL-28	M8,0	11,5	72,6	25,00

Part number	Standard bore									Price each 1 to 4
	$\text{Ø}A$ (H7)	D_H	d_H	L	$L_1;L_2$	E	b	s	f	
RGS-AL-5	Plein	10	-	15	5	5	4	0,5	4,0	40,38 €
RGS-AL-7	4, 5, 6, 7	14	-	22	7	8	6	1,0	6,0	68,24 €
RGS-AL-9	4, 6, 8, 10	20	7,2	30	10	10	8	1,0	1,5	68,71 €
RGS-AL-14	5, 6, 8, 10, 12, 14	30	10,5	35	11	13	10	1,5	2,0	76,80 €
RGS-AL-19	10, 14, 15, 16, 20	40	18,0	66	25	16	12	2,0	3,0	178,90 €
RGS-AL-24	16, 19, 20, 24, 25	55	27,0	78	30	18	14	2,0	3,0	214,29 €
RGS-AL-28	20, 24, 25, 28, 30, 32	65	30,0	90	35	20	15	2,5	4,0	279,92 €

Dimensions in mm

Our other products



DOMI80

Domino 80 adjustable slide, Slide DOMILINE 80



BH01

Single housed bearing, Bearing fitted with adhesive



BCAss

Stainless steel splined bush, Inox

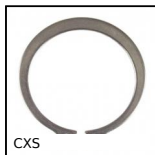

CX5

External circlip DIN471, external DIN 471



UCP_PBT

Stainless/Polymer pillow block bearing, Polymer and stainless steel



CFUURSS

Cam follower stainless steel, Standard - stainless steel



WJUM20

Drylin® W bearing block, Slide



INS

Self tapping steel insert, Steel



BLHB50

Right angled gearbox, bored shafts, up to 30



CHAFR-MINI

Miniature friction hinge, Friction



PRF_CHA

Hinge for aluminium profile, Surface



VTHA

Magnetic screw with hexagonal head, Steel

Complementary products



DKGS

Backlash free coupling Gerwah®, from 0.5 to 3Nm



EKGS

Backlash free coupling Gerwah®, from 0.5 to 35Nm



RTE

Rotex®, jaw coupling, Aluminium