

## Protective cover

RFV-CAP  
RFK-CAP

- Protective cover to prevent dirt etc from lodging in the output shaft of RFV stainless steel worm and wheel gearboxes and RFK stainless steel hypoid gearboxes
- For full protection, use one cover on each side of the gearbox
- Material:  
316 stainless steel



stainless steel



stainless steel

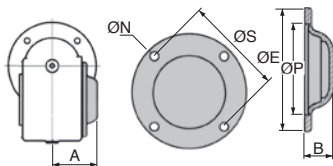

Closed cover RFV-CAP-F/SS and RFK-CAP-F/SS

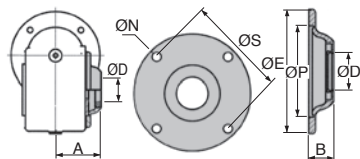

Open cover RFV-CAP-AT/SS and RFK-CAP-AT/SS

## DISCOUNTS

Qty	1+	2+	4+
Disc.	Net	-5%	On request

Part N°	ØE	ØP	ØD	B	A	ØS	ØN	For gearbox	Price each
<b>Closed cover</b>									
RFV40-CAP-F/SS	90	60	-	20,0	56,5	75	6,5	RFV40	31,48 €
RFV50-CAP-F/SS	100	70	-	20,5	64,0	85	8,5	RFV50-RFK28	38,83 €
RFV63-CAP-F/SS	110	80	-	26,0	79,0	95	8,5	RFV63-RFK38	46,19 €
RFK48-CAP-F/SS	140	95	-	28,0	85,0	115	8,5	RFK48	
RFK58-CAP-F/SS	160	110	-	28,0	95,0	130	10,5	RFK58	
<b>Open cover for transversal shaft</b>									
RFV40-CAP-AT/SS	90	60	18	17,0	53,5	75	6,5	RFV40	34,63 €
RFV50-CAP-AT/SS	100	70	25	17,0	61,0	85	8,5	RFV50	40,93 €
RFK28-CAP-AT/SS	100	70	20	17,0	61,0	85	8,5	RFK28	
RFV63-CAP-AT/SS	110	80	25	22,0	75,0	95	8,5	RFV63-RFK38	48,29 €
RFK48-CAP-AT/SS	140	95	30	28,0	85,0	115	8,5	RFK48	
RKF58-CAP-AT/SS	160	110	35	28,0	95,0	130	10,5	RFK58	

All dimensions in mm

0 825 88 6000

Service 0,15 € / min  
+ prix appel

## Our other products



P70  
Worm and wheel gearbox, up to 164 Nm

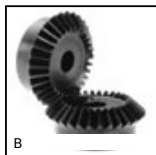

B  
Bevel gear - Steel  
60C40, 1:1



KKB-AR  
Linear bearing with inclined ball tracks, Standard loads / -20° +200°



PRF\_JL2  
Panel accessories, Door seal - Ø 2mm

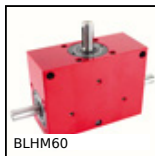

BLHM60  
Right angled gearbox, up to 70 Nm



VRC1  
Retaining catch, Single sided



ACM\_AZ  
Manual bonnet fastener, Hook



TCL-CR  
T-Clip - Aluminium profile attachment, Magnetic object holder



RGG  
Drip feeder, For lubrication or dosing



FRTD\_FRND  
Rotary dampener, >=5Ncm



PGT  
Panels accessories, Sliding panel support



VCMB  
Dual-thread screw wood/metal, Stainless steel

## Complementary products



DER63  
3 phase AC asynchronous motor - Stainless steel, 0.18kW



RFV50  
Worm and wheel gearbox - Stainless steel, up to 80 Nm



RFV40  
Worm and wheel gearbox - Stainless steel, up to 47 Nm



RFV63  
Worm and wheel gearbox - Stainless steel, up to 152 Nm