

Stainless steel Worm and wheel motorgearbox

Create your set

For food industry

Supporting feet **RFV-FP**
(tome 2 p.326)

Protective cover closed
RFV-CAP (tome 2 p.327)

Motor 0,18kW à 1,5kW
(tome 2 p.318)

Gear reducer **RFV40, RFV50, RFV63**,
Reduction ratio of 7,5/1 to 100/1,
3 flanges to choose depending
on the motor selected

RFV-CAP protective cover
(tome 2 p.327)
open or closed to prevent
material retention in the output
bore

Reaction arm **RFV-BR**
(tome 2 p.325) to better
support the load

* See data sheet (tome 2 p.328)

Stainless steel worm and wheel gearbox

RFV63

Torque up to 140Nm

- Gearbox especially suitable for use in the food industry
- Ratios from 7.5:1 to 100:1
- B14 flange
- All surfaces smooth and polished to avoid dirt retention
- Lubricated using food quality grease
- Working temperature: -20° to +40 °C
- Material:
316 stainless steel housing

stainless steel



Accessories

- Use with a DER 4 pole motor to create a motorised gearbox
- Torque arm, mounting feet and protective covers

Info

- All information is engraved directly on to gearbox rather than being on a tag plate to avoid accumulating dirt etc

Suitable for the food industry

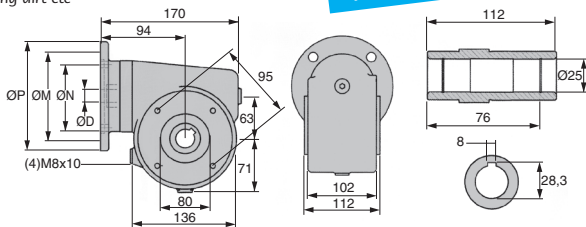

FLANGE DIMENSIONS

	ØD	ØP	ØM	ØN
71B14 flange	14	105	85	70
80B14 flange	19	120	100	80
90B14 flange	24	140	115	95

DISCOUNTS

Qty	1+	2+	4+
Disc.	List -5%	On request	

Part number	Maxi. Torque at 1400t/min (Nm)	Reduction ration	Self locking output	Prix Uni.
71B14 flange				
-	120	7,5	No	874,23 €
-	112	10	No	874,23 €
-	120	15	No	874,23 €
-	112	20	Not defined	874,23 €
-	126	25	Not defined	874,23 €
-	139	30	Yes	874,23 €
-	131	40	Yes	874,23 €
-	122	50	Yes	874,23 €
-	114	60	Yes	874,23 €
-	104	80	Yes	874,23 €
-	96	100	Yes	874,23 €

Dimensions in mm