

Stainless steel Worm and wheel motorgearbox

Create your set

For food industry

Supporting feet **RFV-FP**
(tome 2 p.326)

Protective cover closed
RFV-CAP (tome 2 p.327)

Motor 0,18kW à 1,5kW
(tome 2 p.318)

Gear reducer **RFV40, RFV50, RFV63**,
Reduction ratio of 7,5/1 to 100/1,
3 flanges to choose depending
on the motor selected

RFV-CAP protective cover
(tome 2 p.327)
open or closed to prevent
material retention in the output
bore

Reaction arm **RFV-BR**
(tome 2 p.325) to better
support the load

* See data sheet (tome 2 p.328)

Stainless steel worm and wheel gearbox

RFV40

Torque up to 40Nm

- Gearbox especially suitable for use in the food industry
- Ratios from 7.5:1 to 100:1
- B14 flange
- All surfaces smooth and polished to avoid dirt retention
- Lubricated using food quality grease
- Working temperature: -20° to +40 °C
- Material:
316 stainless steel housing

Accessories

- Use with a DER 4 pole motor to create a motorised gearbox
- Torque arm, mounting feet and protective covers

Info

- All information is engraved directly on to gearbox rather than being on a tag plate to avoid accumulating dirt etc



Suitable for the food industry

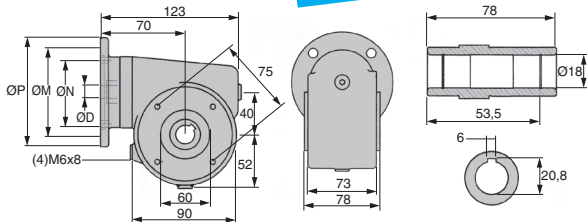

FLANGE DIMENSIONS

	ØD	ØP	ØM	ØN
63B14 flange	11	90	75	60
71B14 flange	14	105	85	70

DISCOUNTS

Qty	1+	2+	4+
Disc.	List -5%	On request	

Part number	Part number	Max. Torque at 1400/min (Nm)	Reduction ratio	Self locking output	Price each
63B14 flange	71B14 flange				
-	RFV40-7.5-71B14/SS	37	7.5	No	624,58 €
-	RFV40-10-71B14/SS	40	10	No	624,58 €
-	RFV40-15-71B14/SS	40	15	No	624,58 €
RFV40-20-63B14/SS	RFV40-20-71B14/SS	39	20	Not defined	624,58 €
RFV40-25-63B14/SS	RFV40-25-71B14/SS	36	25	Not defined	624,58 €
RFV40-30-63B14/SS	RFV40-30-71B14/SS	40	30	Yes	624,58 €
RFV40-40-63B14/SS	RFV40-40-71B14/SS	40	40	Yes	624,58 €
RFV40-50-63B14/SS	-	39	50	Yes	624,58 €
RFV40-60-63B14/SS	-	36	60	Yes	624,58 €
RFV40-80-63B14/SS	-	30	80	Yes	624,58 €

Dimensions in mm