

- Support for RFK gearboxes
- Inward or outward facing
- Sold in pairs
- Material:  
316 stainless steel

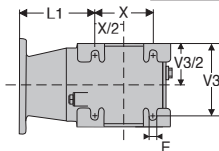

Brackets facing inwards

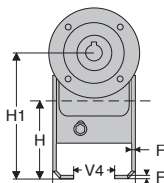
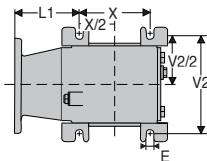
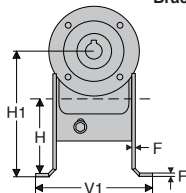

Brackets facing outwards

### DISCOUNTS

Qty	1+	2+	4+
Rem.	Net	-5%	On request

Part N°	H	H1	V	V1	V2	V3	V4	X	E	F
RFK28-FP/SS	80	136,85	93	129	110	70	51	80	8,5	3
RFK38-FP/SS	90	154,50	114	157	135	85	63	100	8,5	4
RFK48-FP/SS	95	169,50	124	170	148	90	68	120	11,5	5
RFK58-FP/SS	110	198,00	144	204	178	100	74	140	13,0	5

Part N°	L1 for flange				Price each
	63B5	71B14	80B14	90B14	
RFK28-FP/SS	65,5	72,5	92,5	92,5	81,95 €
RFK38-FP/SS	67,0	74,0	94,0	94,0	104,72 €
RFK48-FP/SS	78,5	85,5	105,5	105,5	129,30 €
RFK58-FP/SS	85,0	92,0	112,0	112,0	161,17 €

All dimensions in mm

## Our other products



TSRTC

Stem support for  
caster, For swivel  
caster with central  
hole



DOMI80

Connecting kits, XZ  
linking kit



PR881

Idler sprocket for slat  
top chain, Range 881



VTHbr

Hexagonal headed  
screw VTH - DIN933,  
Brass



RDCss

Rigging screw with 2  
jaws stainless steel,  
Stainless steel



VPRA\_M

Handwheel with  
handle,  
Thermosetting plastic  
- stainless steel hub



PRF\_FIX\_UNI

Universal fastener for  
aluminium profile,  
Universal



CFF

Female rod ends DIN  
ISO12240-4, Steel /  
bronze



PRF\_P

Anchor foot for 45x45  
profile, Anchor foot



LRRR

Latch with locking  
system, Aluminium



INO

Internal gear, Steel  
20NCD2



PRFRTR

Cross connector for  
aluminium profile,  
Cross connector

## Complementary products



RFK28C

Hypoid gearbox -  
Stainless steel, up to  
130 Nm



RFK38B

Hypoid gearbox -  
Stainless steel, up to  
200 Nm



RFK38C

Hypoid gearbox -  
Stainless steel, up to  
200 Nm



RFK48B

Hypoid gearbox -  
Stainless steel, up to  
350 Nm