

- Safety washer for securing a screw to a threaded component, thus meeting the requirements of the European standard 2006/42/EG
- Screw the washer onto the threaded part and then let it move freely on the thinner shaft
- Material:
Stainless steel 1.4404 (316L)



Advantages

- The washer will remain attached to the screw and will not accidentally fall off



Washer with VHTM screw

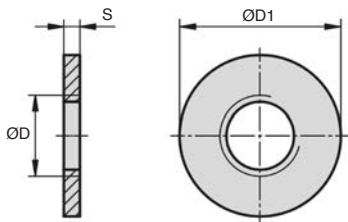

DISCOUNTS

Qty	1+	5+	10+	25+	50+
Disc	Prix	-5%	-10%	-15%	On request

Part N°	ØD	ØD1	S	Price each 1 to 4
RDS-3/HDSS	M3	6	1,5	3,98 €
RDS-4/HDSS	M4	8	1,5	4,07 €
RDS-5/HDSS	M5	10	1,5	4,29 €
RDS-6/HDSS	M6	12	1,5	4,35 €
RDS-8/HDSS	M8	16	2,0	4,62 €
RDS-10/HDSS	M10	20	2,0	4,78 €

All dimensions in mm

Our other products



RPCtcss
Swivel castor with central hole, Stainless steel - Polyamide - with ...

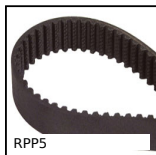

RPP5
RPP heavy duty timing belt, RPP5



BLHB20
Right angled gearbox, bored shafts, up to 1.77 Nm



VQTpln
Quarter-turn clamp lock - Clamping plate, Flush mounting



AC
Strike for toggle latch, 15mm

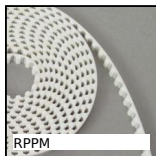

RPPM
RPP type belt per metre, RPP14 Steel cored polyurethane



HRV
V-rail guidance Simple Select® system, Rail with carriage



HLU
Spoked handwheel without handle, Aluminium



WW20
Drylin® W slide, slide assembly



G1
Steel spur gear, Steel 20NCD2



WFRM
Flanged polymer nut, Polymer (Iglidur®) - 1 thread

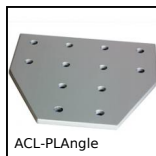

ACL-PLAngle
Joining plate for aluminium profile, Angle connection

Complementary products



VHTM
Hexagonal headed screw Hygienic Design®, Stainless steel