

Stainless steel manual rigging screw

RDER

Diameter from 5mm to 12mm

- Rigging screw with 1 welded clevis and manually tightened end

- Material: 316 stainless steel

Advantages

- Quick and easy fixing on the end of a cable
(For mounting method, refer to [ERF/SS](#) page)

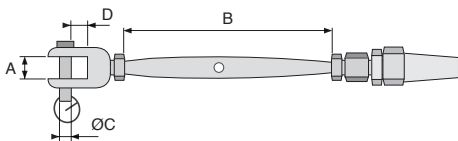

DISCOUNTS

Qty	1+	3+	5+	10+
Disc. List	-5%	-10%	On request	

Part number	For cable ØD1	A	B	ØC	D	Weight (g)	Price each 1 to 2
RDER3-5/SS	3	10	80,0	5	8	68	49,25 €
RDER3-6/SS	3	8	92,0	6	8,5	106	54,61 €
RDER4-6/SS	4	8	92,0	6	8,5	124	62,09 €
RDER4-8/SS	4	10	112,0	8	11	202	70,57 €
RDER5-8/SS	5	10	112,0	8	11	224	90,86 €
RDER5-10/SS	5	11,5	120,0	10	12	330	102,00 €
RDER6-10/SS	6	11,5	120,0	10	12	362	107,19 €
RDER6-12/SS	6	14	150,0	12	16	560	155,77 €

Dimensions in mm

Our other products



F7-SN
Multifunction display,
Articulated support



PTA50ssEB
Articulated foot with
sheet metal base
Ø50, Articulated foot

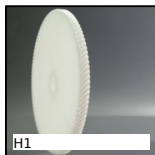

H1
Crossed helical gear
crossed axis at 90°,
Machined plastic
(delrin)



HS
Hexagonal spacer,
Stainless steel 303



FAD
Threaded swivel feet,
Swivel feet without
anti-slip plate



PTA100
Articulated levelling
foot, pressed base
Ø100, Ø 100



MSP3815
Masterplate®
glueable insert
rectangular,
rectangular with



VB
Small 6 lobe threaded
handle - female,
Duroplast - Brass



DB
Steel bevel gear, 2:1



STRIPF
Sealing brush strip,
1m length

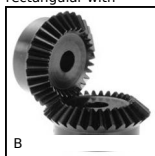

B
Steel bevel gear, 1:1



T5M T10M
T type timing belt per
metre, T10 Steel
cored polyurethane

Complementary products



ERF
Quick fitting threaded
cable terminal, Cable
terminal with
threaded ...



RDCss
Rigging screw with 2
jaws stainless steel,
Stainless steel

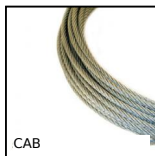

CAB
Stainless steel cable,
Stainless steel



ERC
Quick fitting cable
terminal, Fork