

Steel/steel or stainless steel/stainless steel contact **RAS RASs**

- **Conforms to DIN 71802**
- Working angle: Lateral $\pm 15^\circ$
Front to back $\pm 18^\circ$
- Materials:
passivated galvanised steel
stainless steel 303
- Retained in housing by a fastener
- For the left hand threaded version, only the female part has a left hand thread

steel or stainless steel



Advantages

- Wear resistant

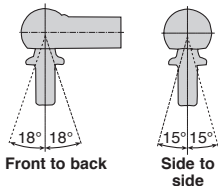
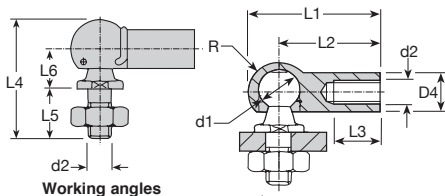

Sizes	Fixing A/F	Max. radial and axial static force. kp
M5	7	30
M6	8	70
M8	11	150
M10	13	200
M12	13	200

DISCOUNTS

Qty	1+	6+	20+	40+	60+
Disc.	List	-15%	-20%	-30%	On request

Part number	Steel	S. steel	d1	d2	D4	L1	L2	L3	L4	L5	L6	R	Stock* S. Steel	Steel	Price each 1 to 5	Steel	Stainless steel	
Right hand thread																		
RAS5	RAS5/SS	8	M5	8	28,5	22,0	10,2	25,0	10,2	9,0	6,4	✓	✓	✓	4,79 €	7,05 €	-	-
RAS6	RAS6/SS	10	M6	10	32,5	25,0	11,5	30,0	12,5	11,0	7,5	✓	✓	✓	4,97 €	7,22 €	-	-
RAS8	RAS8/SS	13	M8	13	39,5	30,0	14,0	38,0	16,5	13,0	9,7	✓	✓	✓	6,06 €	9,21 €	-	-
RAS10	RAS10/SS	16	M10	16	47,0	35,0	15,5	47,5	20,0	16,0	12,0	✓	✓	✓	8,17 €	16,30 €	-	-
RAS12	RAS12/SS	16	M12	16	47,0	35,0	15,0	47,5	20,0	16,0	12,0	✓	✓	✓	11,51 €	19,10 €	-	-
Left hand thread																		
RAS5L	-	8	M5	8	28,5	22,0	10,5	25,0	10,2	9,0	6,4	✓	-	-	5,54 €	-	-	-
RAS6L	-	10	M6	10	32,5	25,0	11,5	30,0	12,5	11,0	7,5	✓	-	-	5,59 €	-	-	-
RAS8L	-	13	M8	13	39,5	30,0	14,0	38,0	16,5	13,0	9,7	✓	-	-	6,70 €	-	-	-
RAS10L	-	16	M10	16	47,0	35,0	15,5	47,5	20,0	16,0	12,0	✓	-	-	8,82 €	-	-	-
RAS12L	-	16	M12	16	47,0	35,0	15,0	47,5	20,0	16,0	12,0	✓	-	-	13,66 €	-	-	-

*Depending on availability - ** On price list 2010 - Dimensions in mm

Our other products



PW_PWG1
Worm - precision range, Steel



SCE_SS
Stainless steel U-shaped clamp, Stainless steel



HRV
V- rail guidance Simple Select® system, Rail with carriage

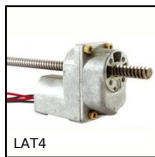

LAT4
4A motorised linear actuator, 4 amperes



SFE
Female rod ends, Stainless steel / PTFE



UGH40
H Type Guide units, For Ø40 actuators



AC
Strike for toggle latch, 13mm



BRI
Panel holder, Panel holder



AC
Strike for toggle latch, 12,13,18 and 20mm

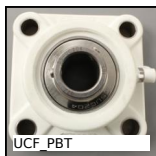

UCF_PBT
Stainless steel/Polymer flanged bearing, Polymer and



ASL
45° Hoist ring for welding, for 45° lifts - for welding



P70
Worm and wheel gear reducer, up to 164 Nm

Complementary products



IBJ
180° ball and socket joints, Steel



CNA-CNG
Right angled mounting plate, Right angled mounting plate for ball jo...



COA-COG
Surface mounting plate, Surface mounting plate for ball joint



IBJss
Ball and socket joint, Stainless steel